





[LEGO.com/sustainable-packaging](https://LEGO.com/sustainable-packaging)





**MILAN MADGE**  
Modelista de  
The LEGO Group

## PASIÓN POR LAS FLORES

🌸 "Tanto si estás ampliando tu vasta colección LEGO® Botanical como si este set marca tu inicio en el mundo de los arreglos florales LEGO, es muy probable que las flores te causen la misma fascinación que a nosotros. La fresca combinación de este ramo bien podrías haberla recogido tú en un prado o jardín. Los colores y las variedades complementarias, provenientes de todo el mundo, están cuidadosamente seleccionados para celebrar la biodiversidad de nuestro planeta y la reconfortante belleza de la naturaleza que tanto apreciamos.

¡Que disfrutes construyéndolo!".

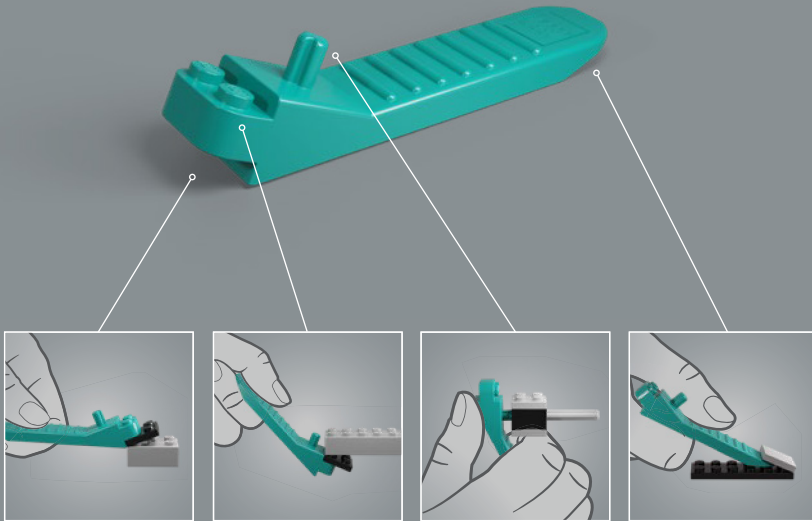



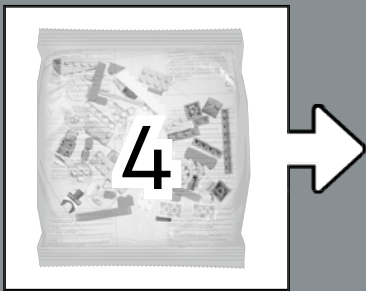
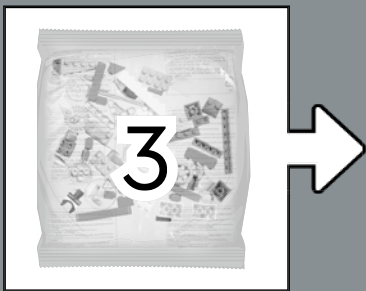
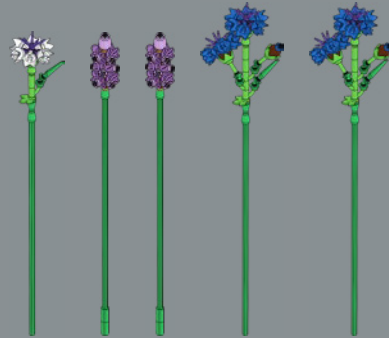
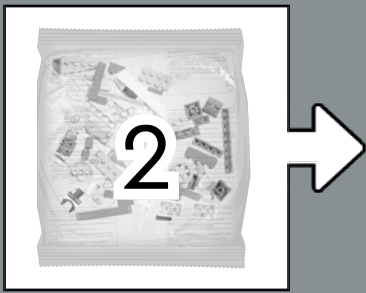
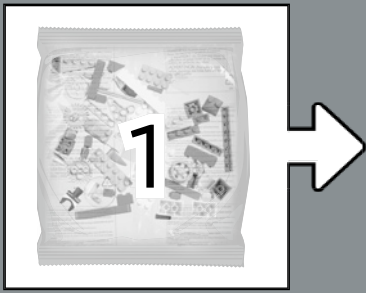

# HELECHO HOJA DE CUERO

*(Rumohra adiantiformis)*

✿ El exuberante y frondoso helecho hoja de cuero, autóctono en la mayoría de los climas tropicales del hemisferio sur, goza de una gran popularidad entre los propietarios de jardines de todo el mundo. Si bien no produce flores, su tupido follaje es muy apreciado en la industria de las flores cortadas como decoración complementaria para arreglos florales.

# PERIFOLLO VERDE/ ENCAJE DE LA REINA ANA

*(Anthriscus Sylvestris)*

✿ Es común encontrar este vaporoso cúmulo de pequeñas flores blancas en zonas umbrías a lo largo de Europa, Asia y África. Semejante a un espectáculo de fuegos artificiales, su tupida floración es un festín para las abejas, polillas, mariposas y otros insectos que buscan polen en los primeros días de la primavera. ¿Pero sabías que también se utiliza como repelente de mosquitos?

# AMAPOLA AMARILLA

*(Meconopsis cambrica/  
Papaver cambricum)*

✿ Tanto en las islas británicas como por toda Europa occidental, la primavera y el verano no estarían completos sin la presencia de la sutil amapola amarilla en setos, prados y bordes de carreteras. A pesar de la aparente fragilidad de su constitución y sus pétalos, es capaz de sobrevivir en entornos rocosos con muy poca tierra y en las grietas de jardines y aceras adoquinadas.



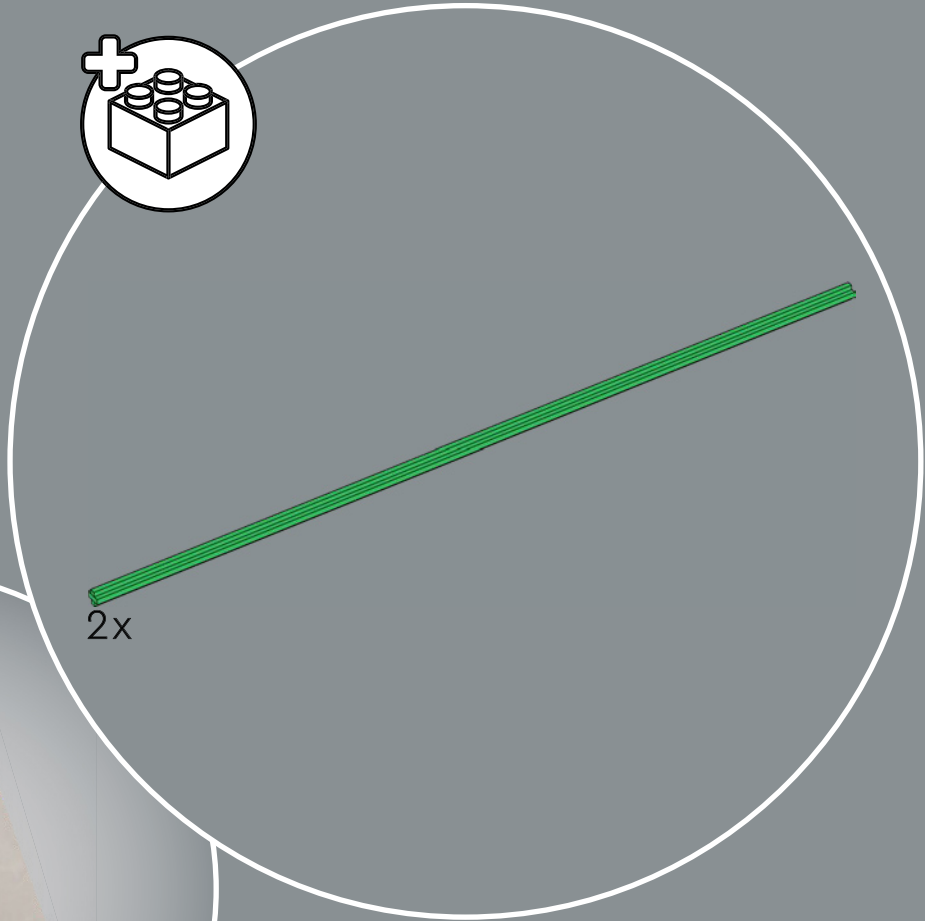
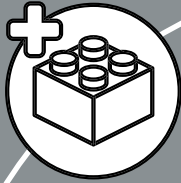



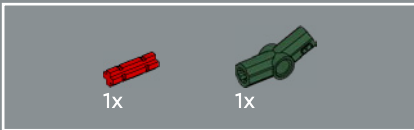

1

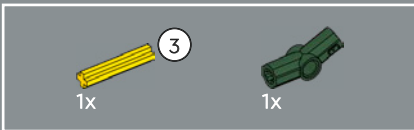
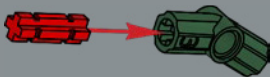

2

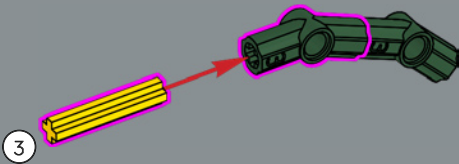

3

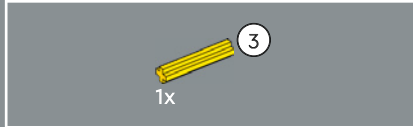
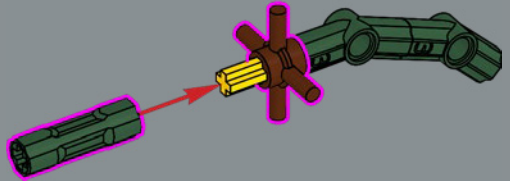

4

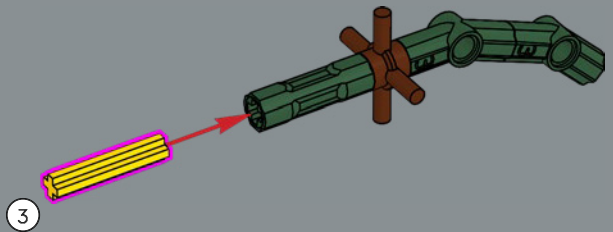

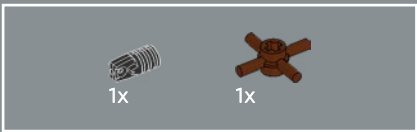

5

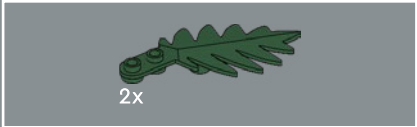
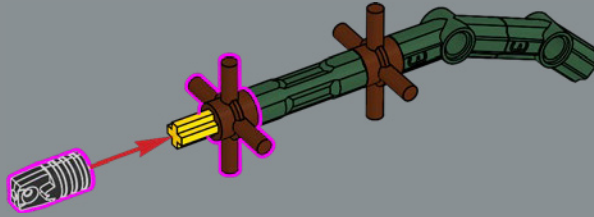

6

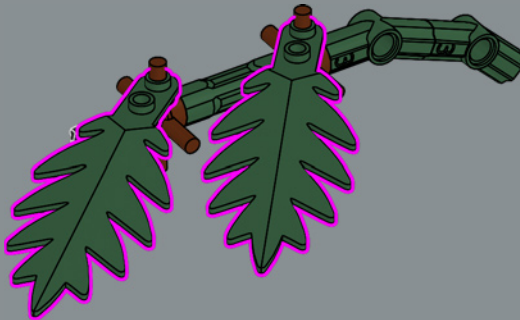

El elemento con forma de hoja de palma se introdujo en los años 90 para el tema LEGO® Pirates. Se le ha encontrado un nuevo uso recreando el helecho hoja de cuero.

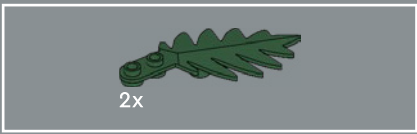

7

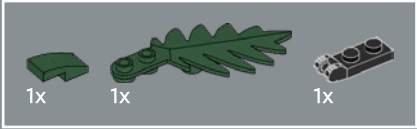

8

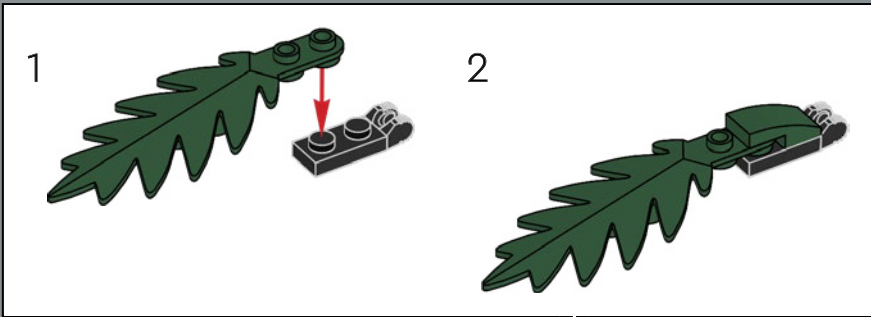



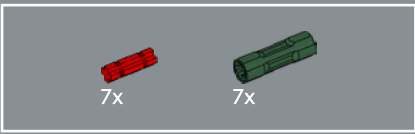

9

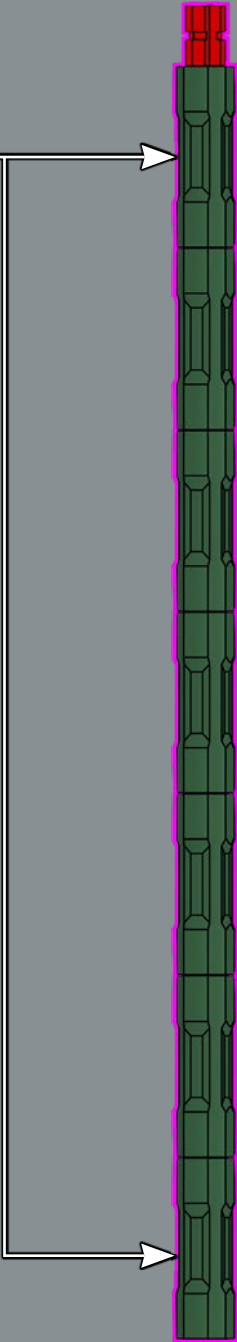
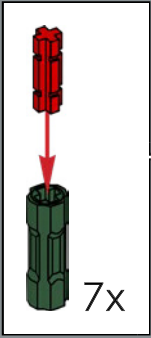

1:1

10

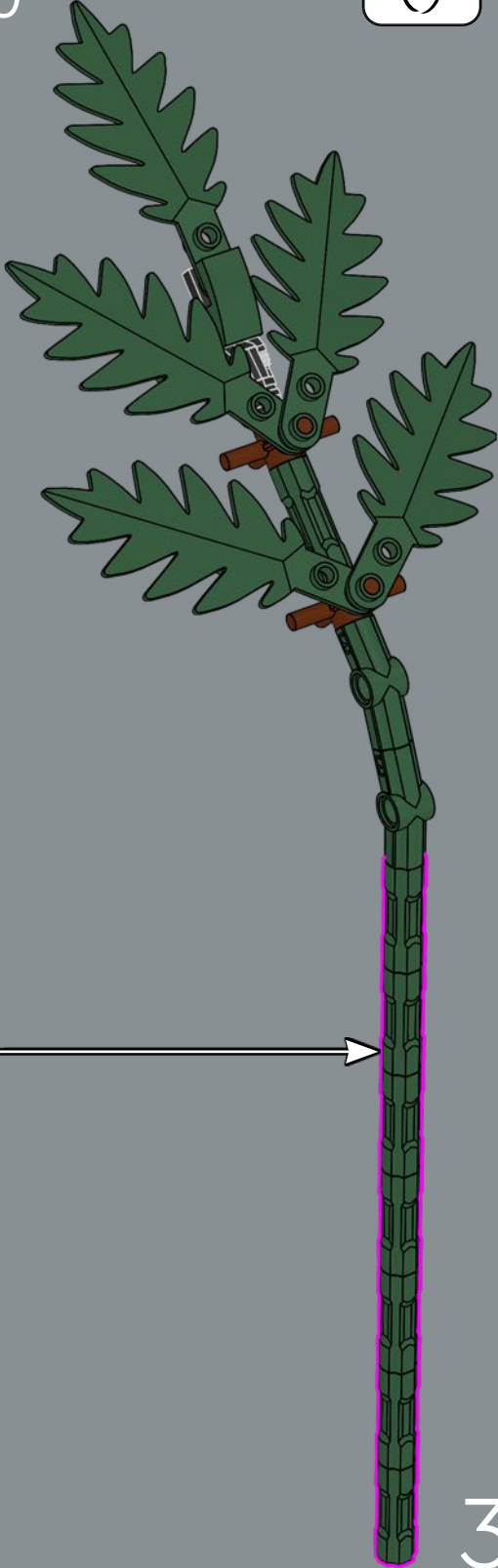

3x

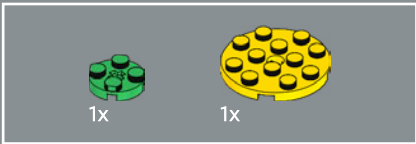
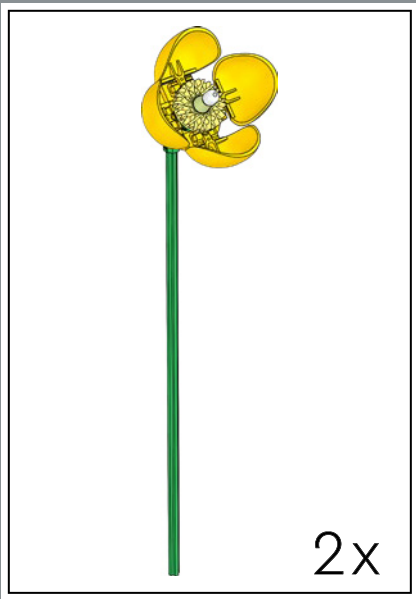

1

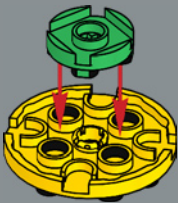

2



3

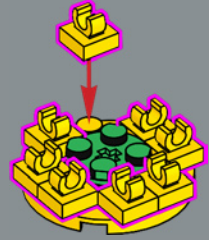

4

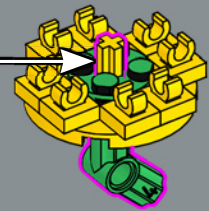
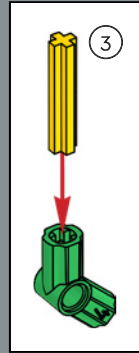

5

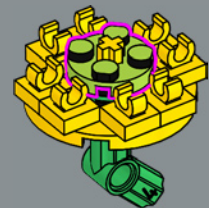



Usar elementos existentes de formas inusuales es la esencia de la construcción con LEGO®. Aquí se ve el cubo de una rueda de coche representando el estigma de una amapola amarilla.

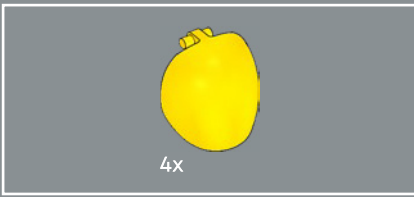

6

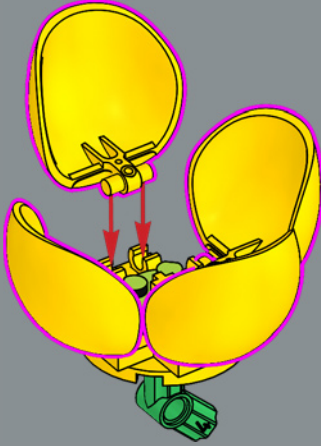

7

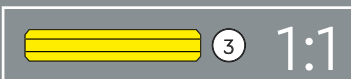
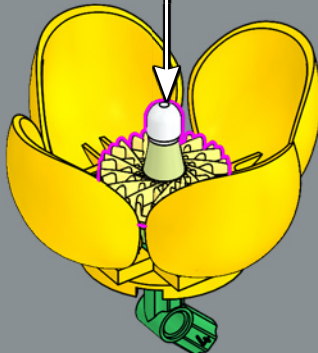
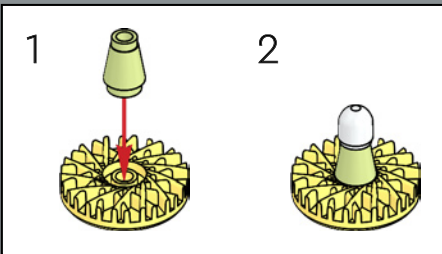

8

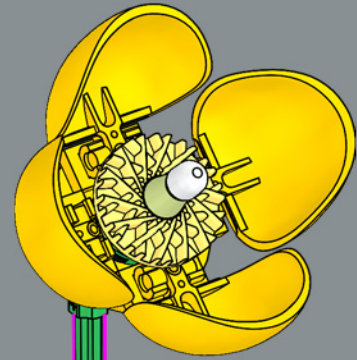

32

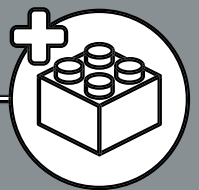

2x



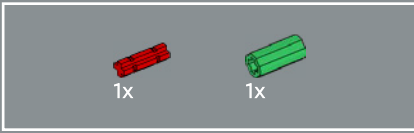
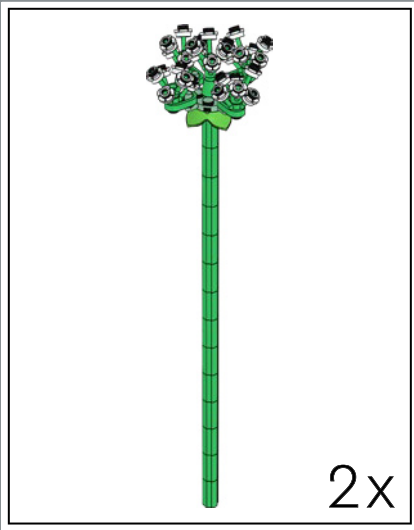

1

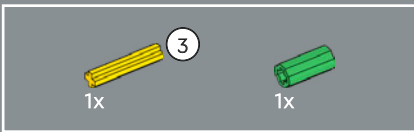

2

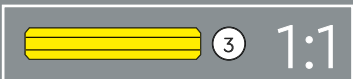

3

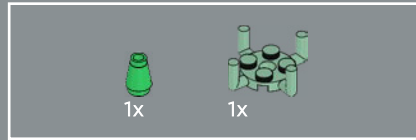

4

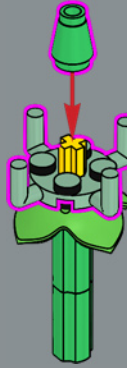

5

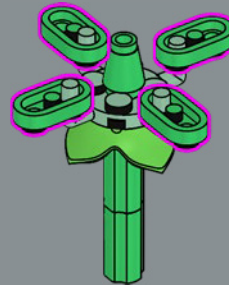

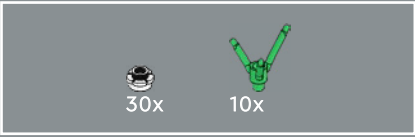
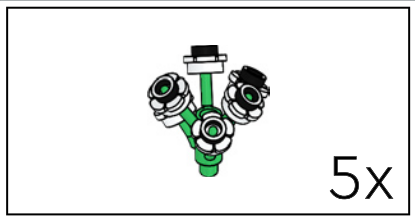

6

1

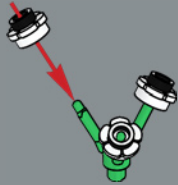

2

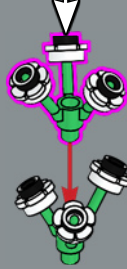

5x

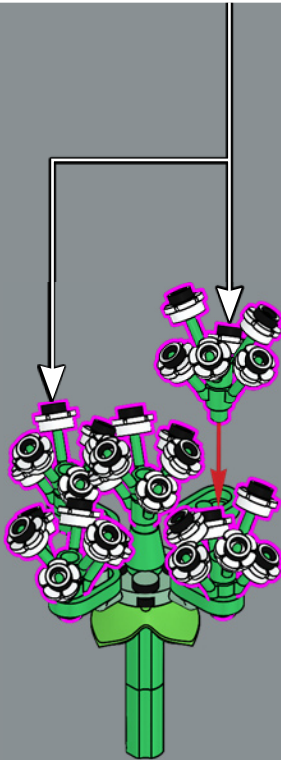
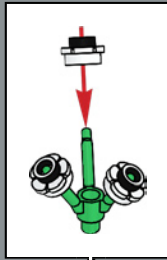

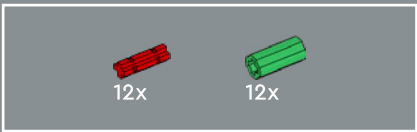

7

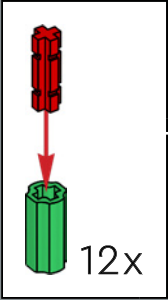

El apodo *encaje de la reina Ana* se remonta varios siglos atrás, cuando se decía que las plantas florecían al paso de Ana, la reina de Gran Bretaña (1702-1707), y sus damas de honor, deseosas de fundirse con la belleza de sus vestidos de encaje.

8

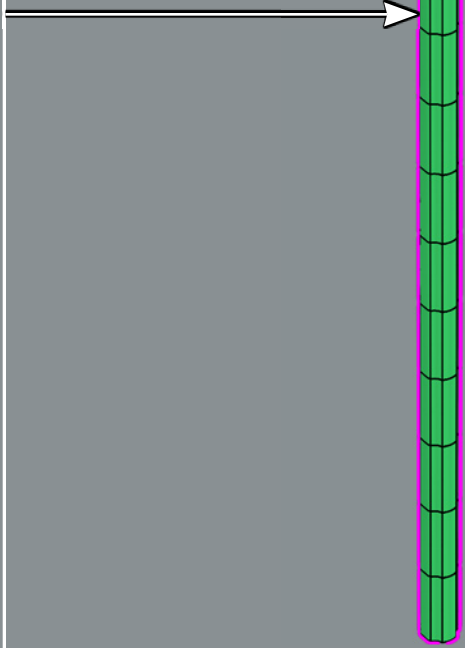

# ACIANO

*(Centaurea cyanus)*

✿ Ligeros como el papel, los acianos decoran prados y jardines con sus brillantes tonalidades de blanco, rosa y azul desde el inicio y hasta mediados del verano, particularmente en Europa, Norteamérica y Asia. Su delicada fragancia y su néctar atraen a mariposas y abejas, por lo que son un complemento ideal para tu jardín o huerto de verduras.



# LAVANDA

*(Lavandula)*

✿ Un arbusto perenne con brotes de colores violeta y un relajante aroma, la siempre vistosa lavanda es tan práctica como atractiva. Originaria del Mediterráneo, Oriente Medio y el norte de África, se utiliza ampliamente como hierba aromática para cocinar, para la destilación de aceites esenciales para cosméticos y en la fitoterapia.

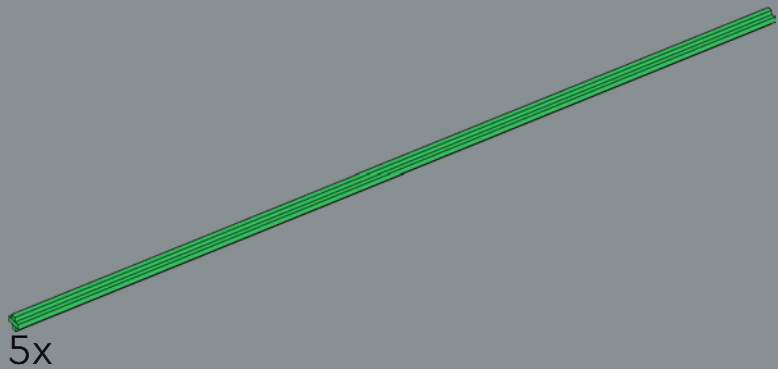
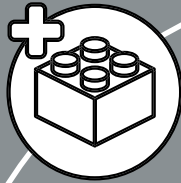



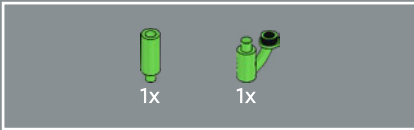
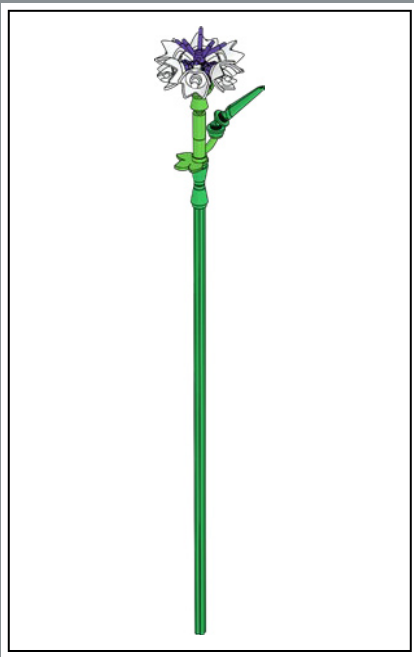

1

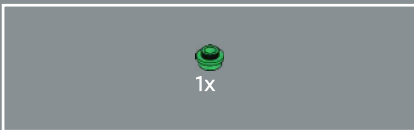

2

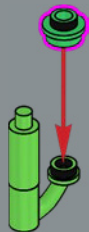

3

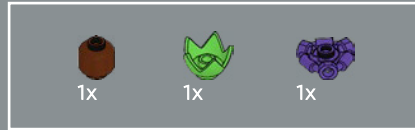
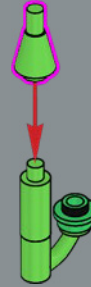

4

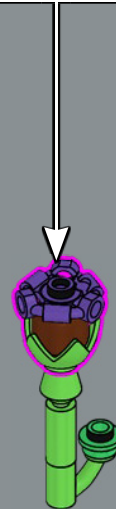



3x



3x

5

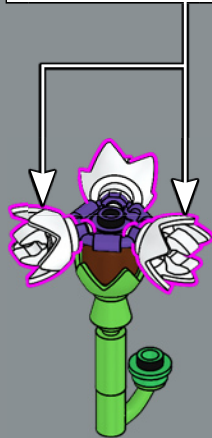
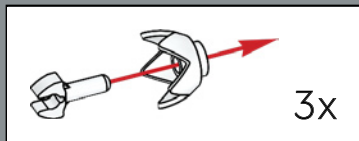

3x

6

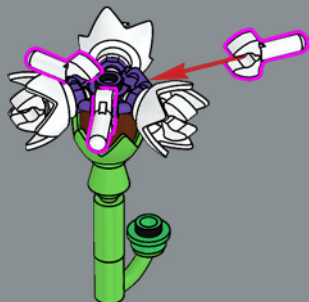

3x

7

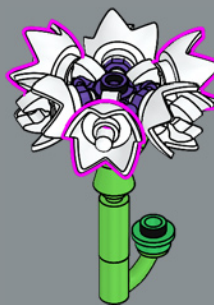

1x

8

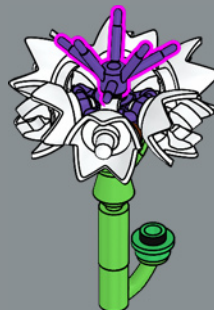

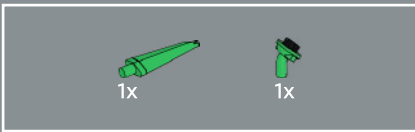

9

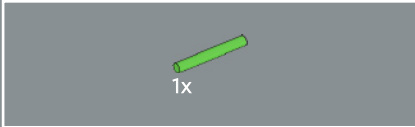
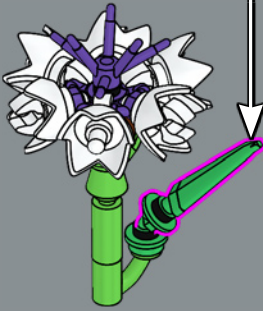
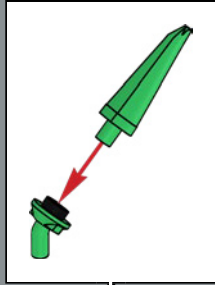

10

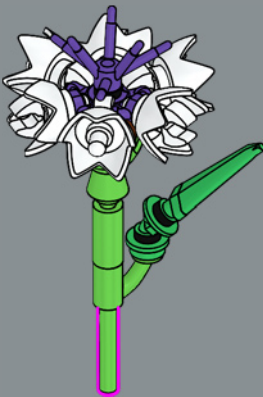

11

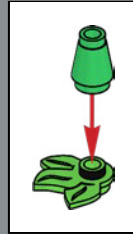



12

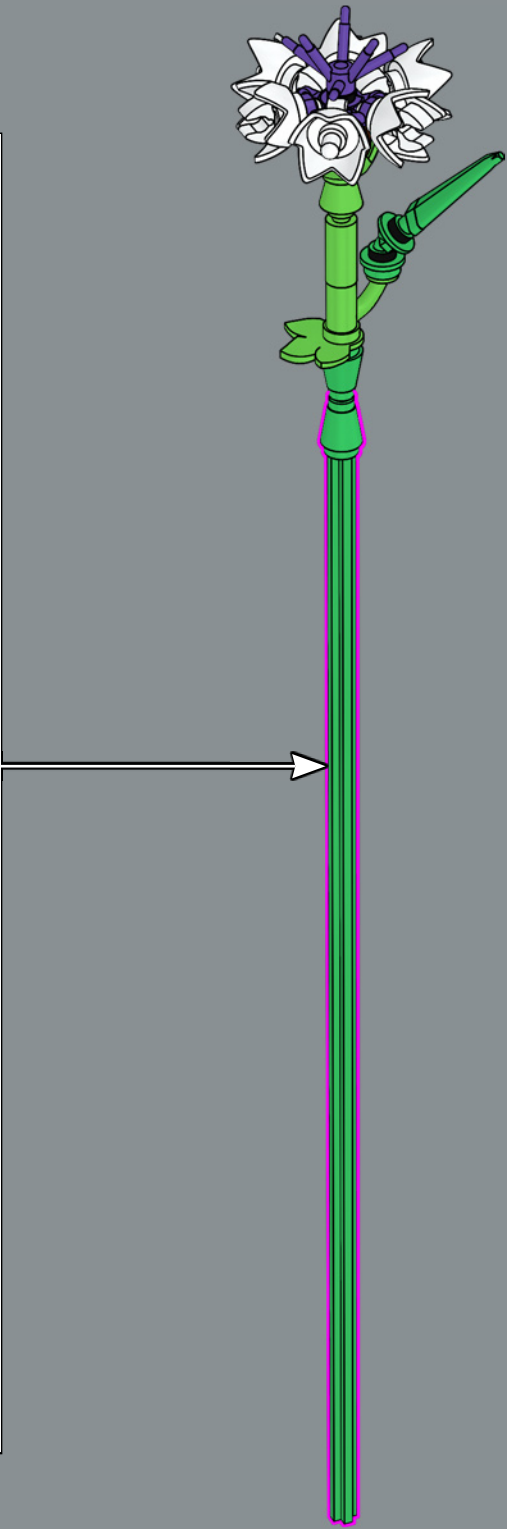
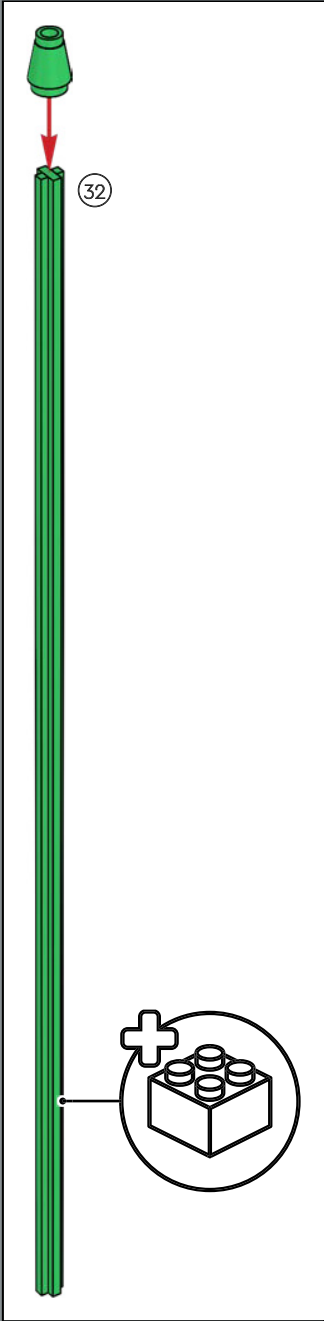

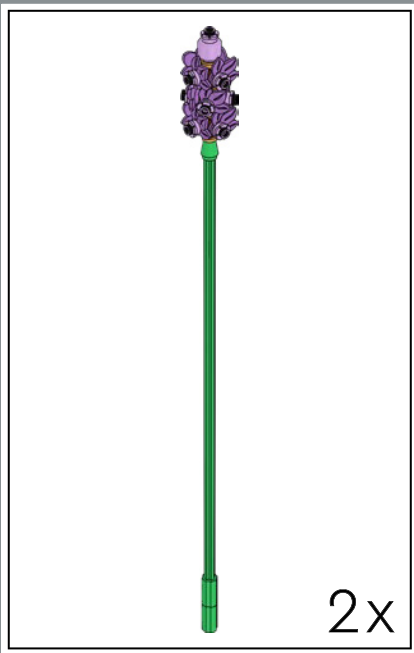

1



2



3

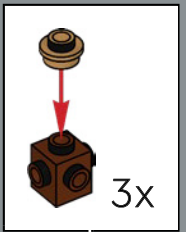

4

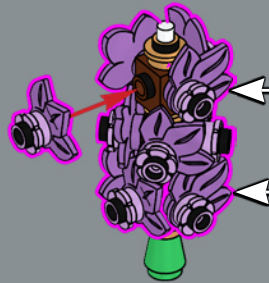
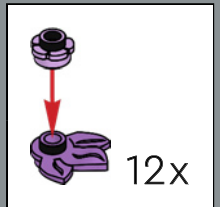

5







6

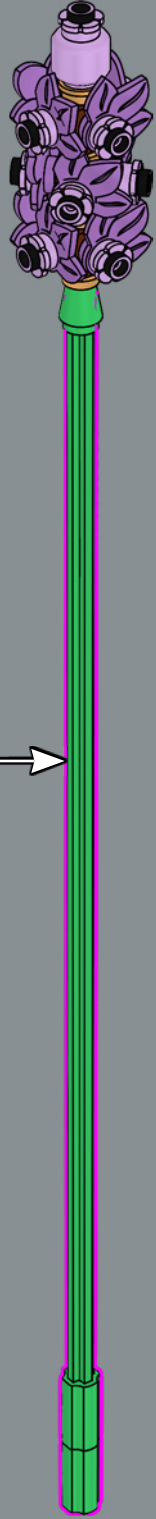
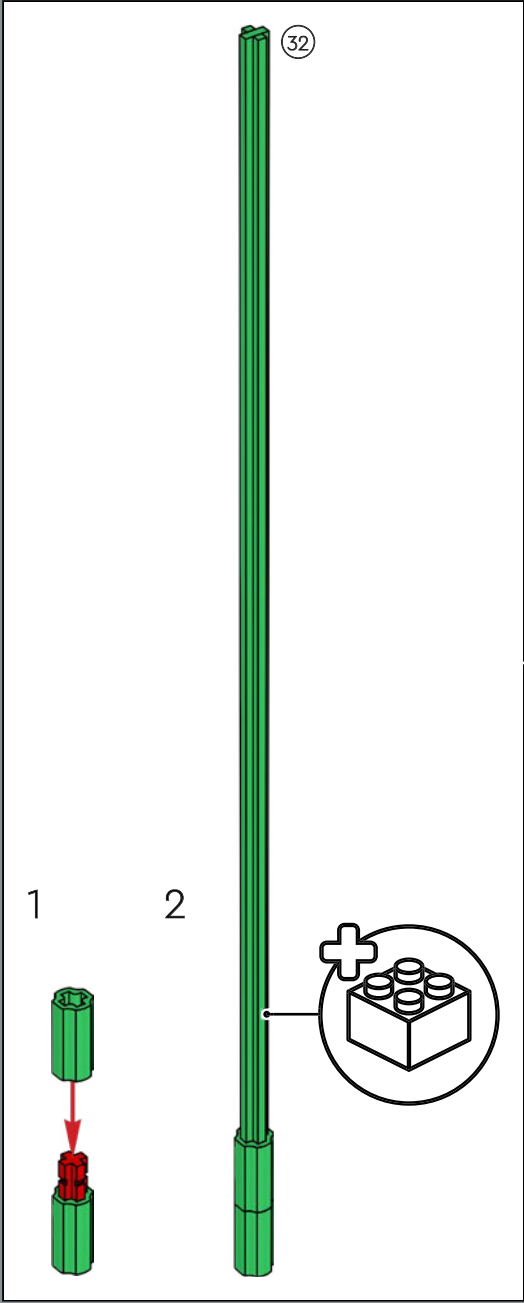

2x



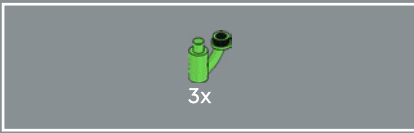
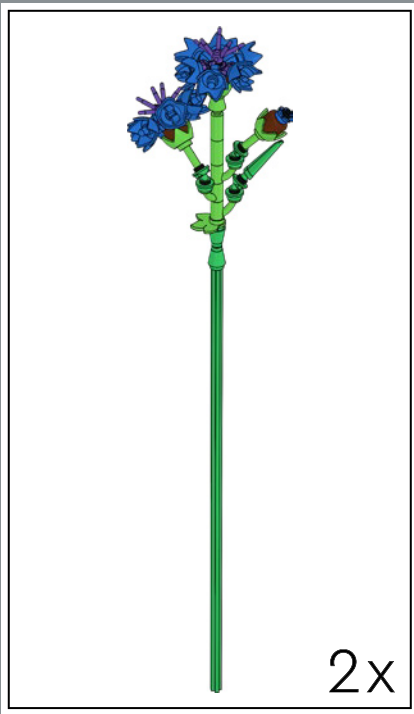

1

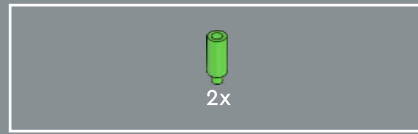

2

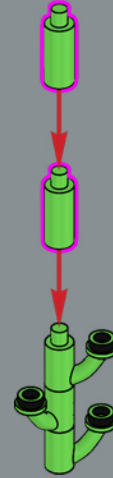

3

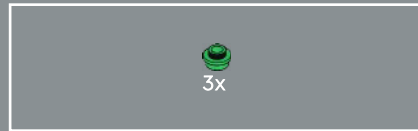
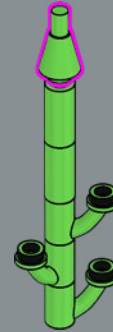

4

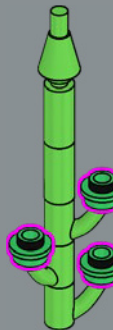

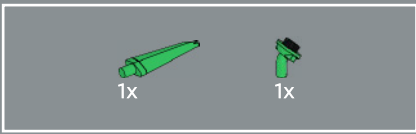

5

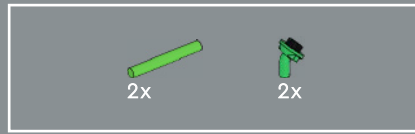
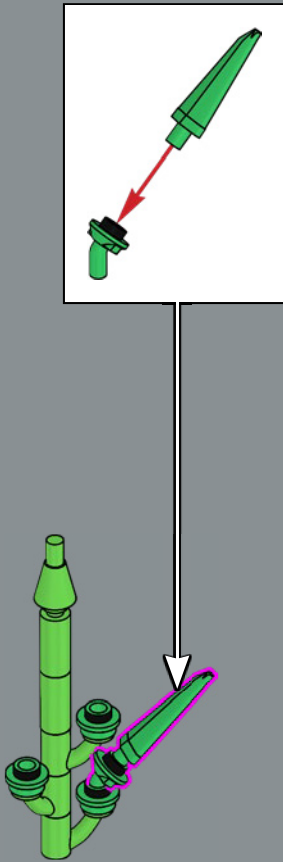

6

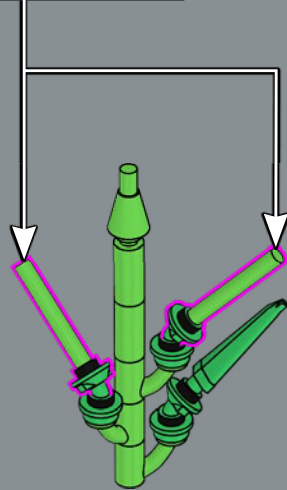
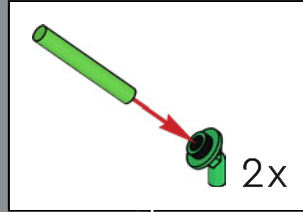

7

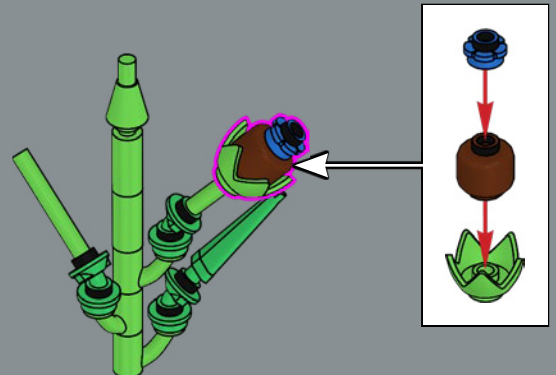

The LEGO Group está trabajando en la construcción de un futuro más sostenible para los niños. En la actualidad, más de 80 elementos LEGO® (como árboles, hojas y arbustos) se fabrican a partir de plástico de origen vegetal producido con caña de azúcar procedente de fuentes sostenibles, lo que da nombre a nuestra iniciativa: Plantas con Plantas. Estos elementos representan los primeros pasos de una misión de mayor envergadura cuyo objetivo es que los ladrillos LEGO se fabriquen a partir de fuentes sostenibles antes de 2030.



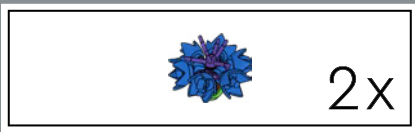

8



9

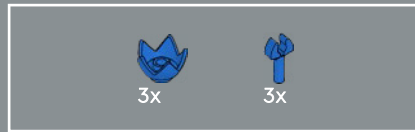

10

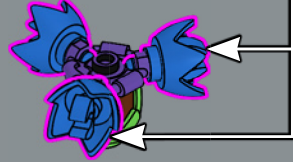
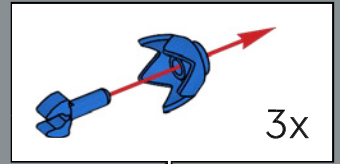

11

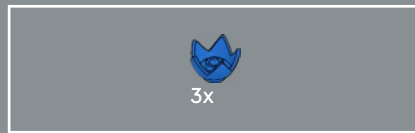
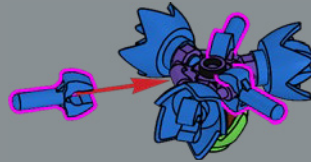

12

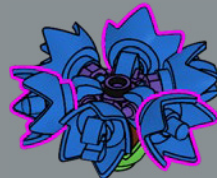



13

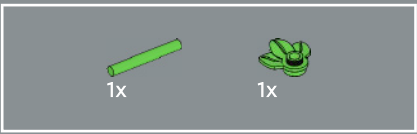
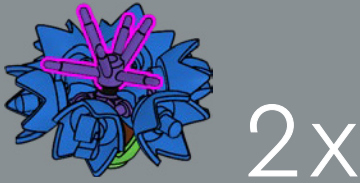

15

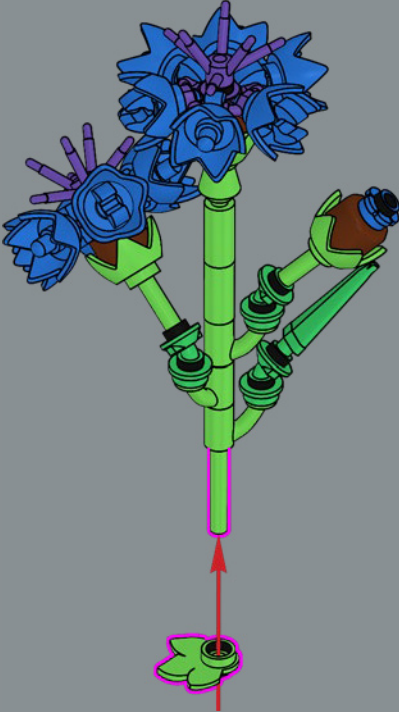

14

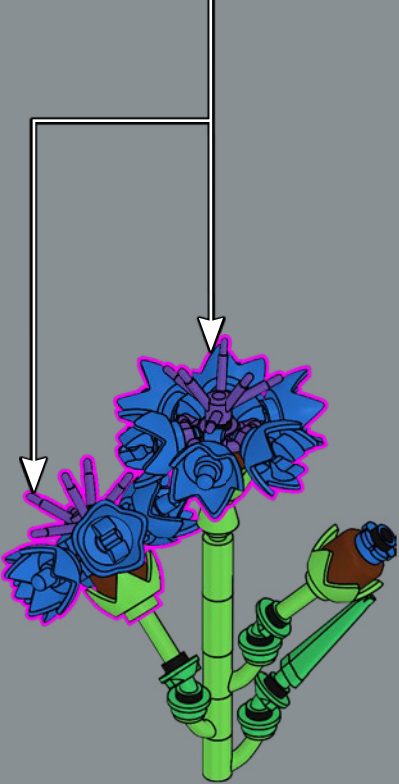

16

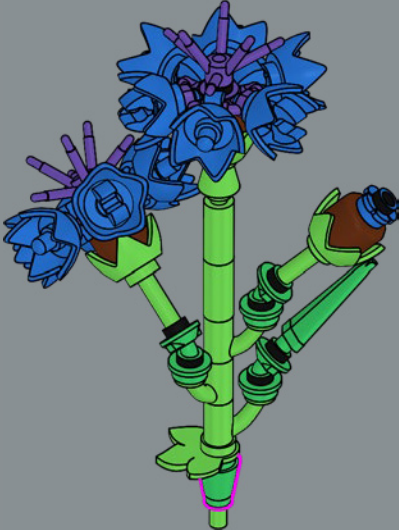





17

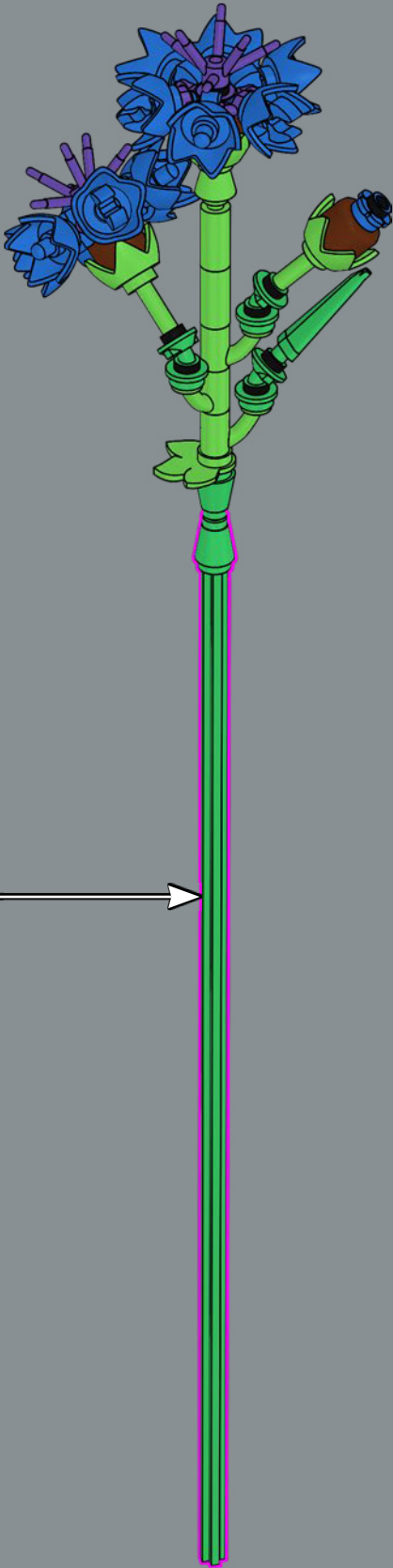
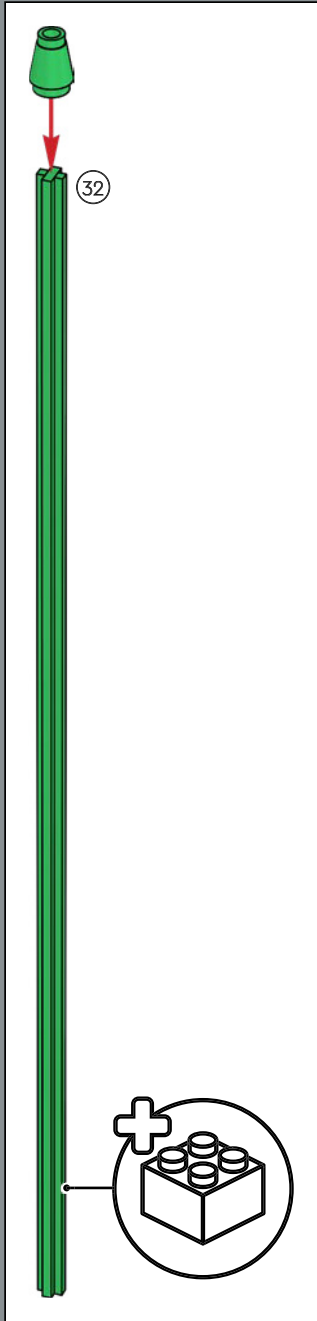



# LUPINO

*(Lupinus)*

🌸 Originarios de Norteamérica, los lupinos son capaces de vivir en estado salvaje también en Europa y alrededor del Mediterráneo. Sus iridiscentes puntas se alzan para atraer la atención de los polinizadores (y la nuestra) a lo largo y ancho de las praderas de Norteamérica, al lado de las carreteras y en jardines de todo el mundo.

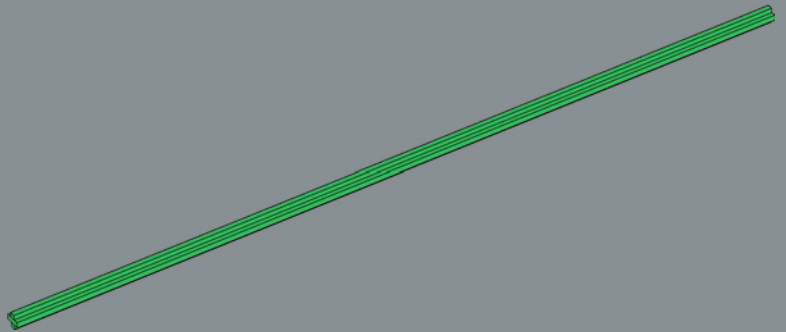
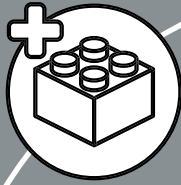

2x



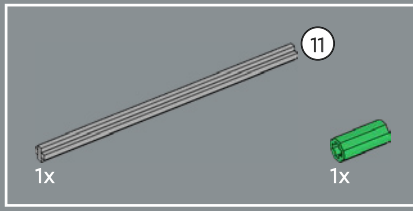
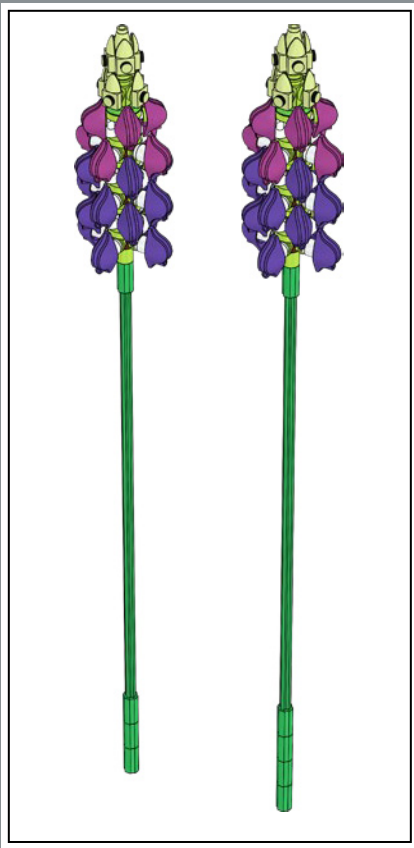

1

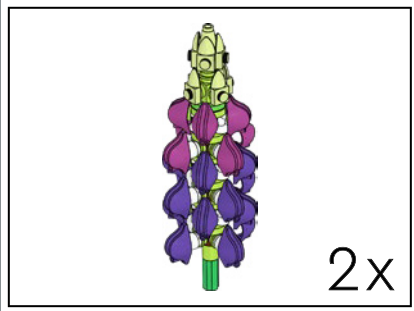
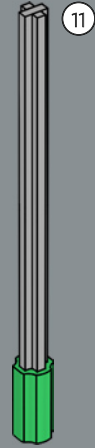

2x



2

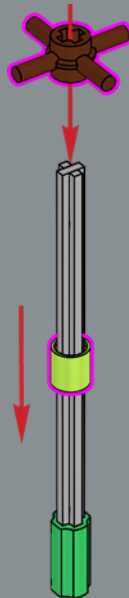



3

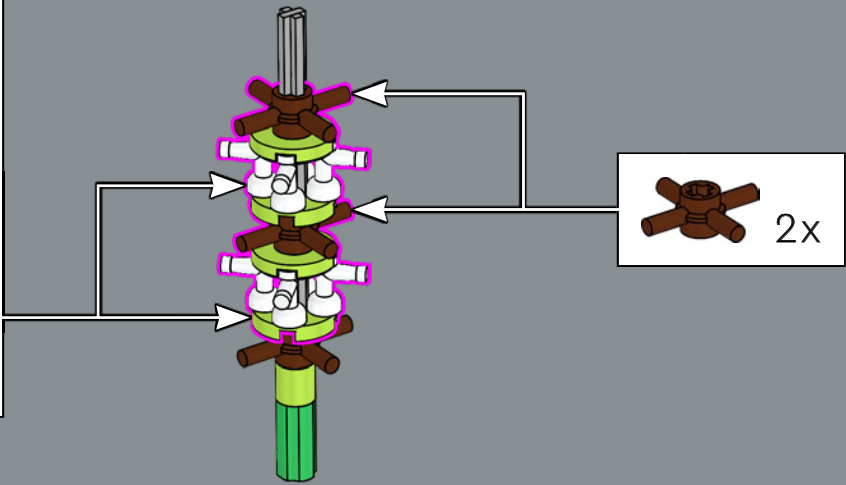
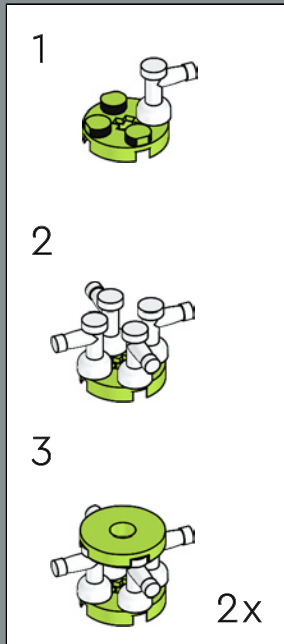

4

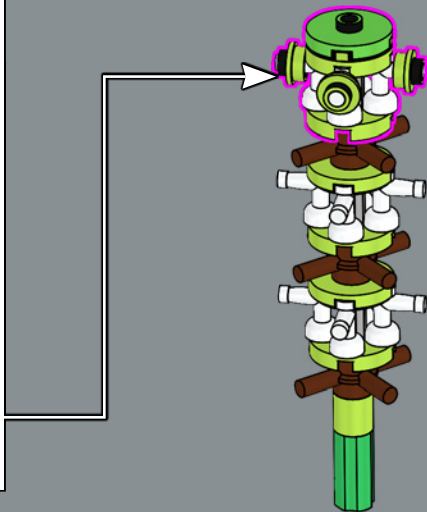
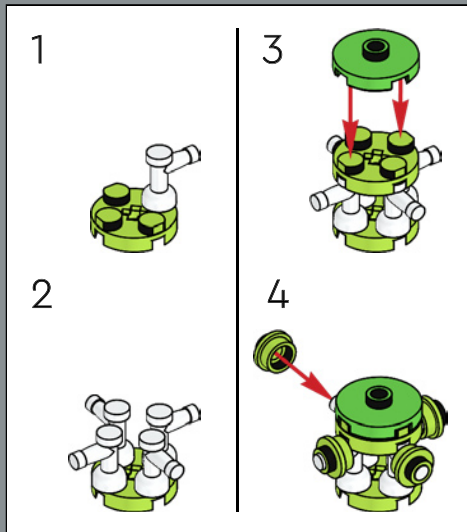



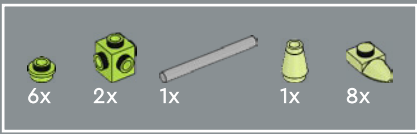

5

1



2

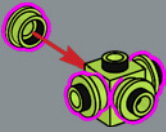

3



4

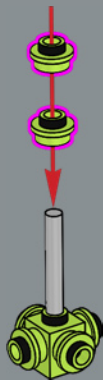

5



6



7

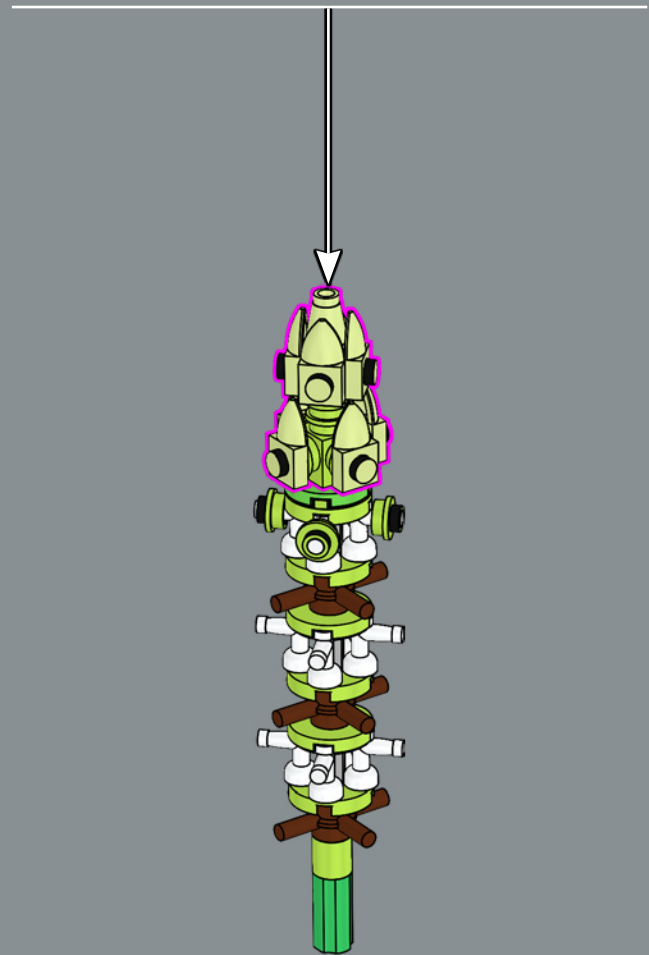
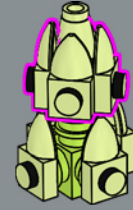



6

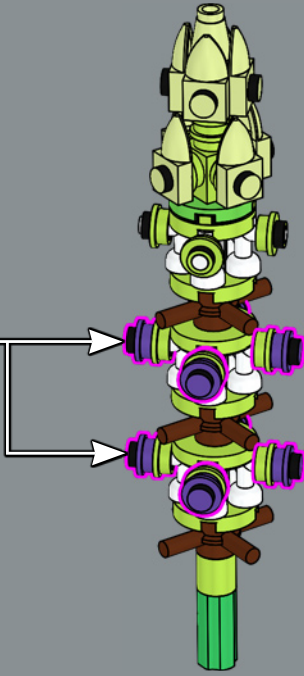
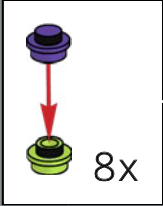

8

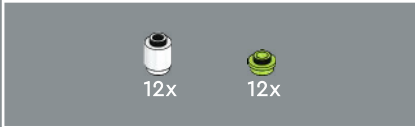
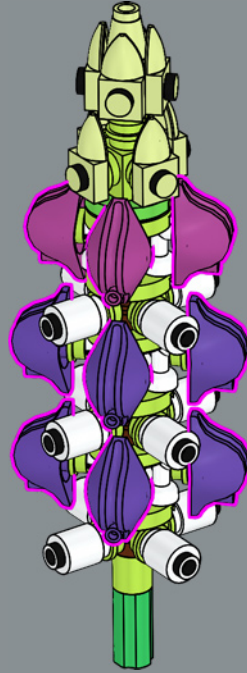

7

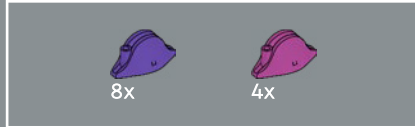
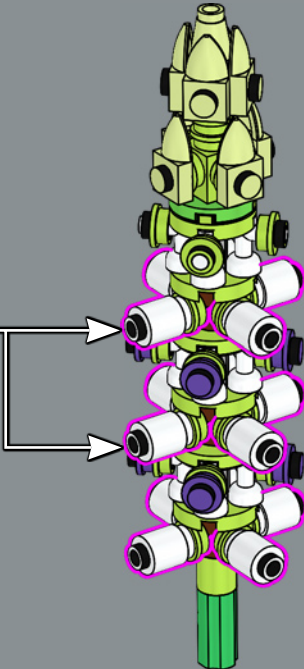
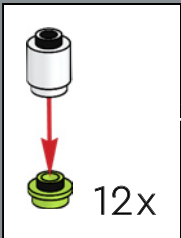

9

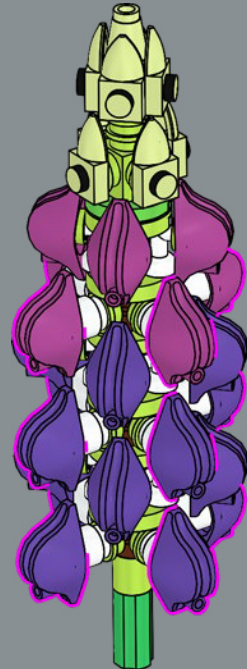

2x

10



32

32



¡Las minifiguras que llevaban puestos estos sombreros de pirata en 1989 jamás habrían imaginado que sus elegantes tocados se usarían como pétalos de lupinos!

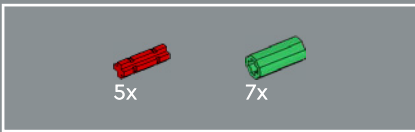

11

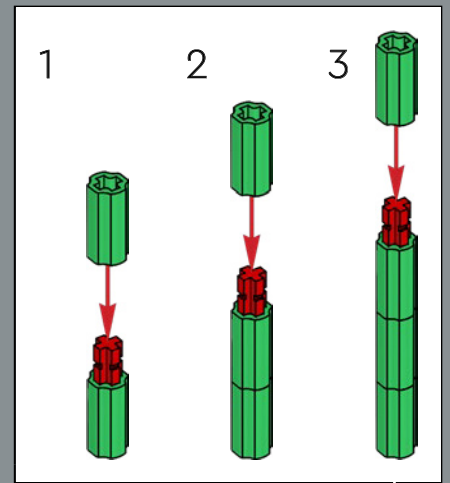
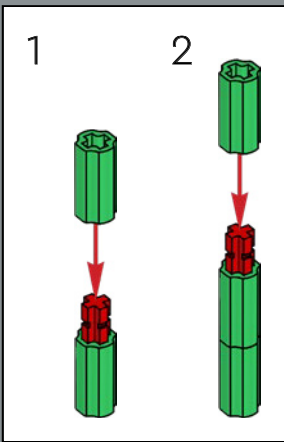
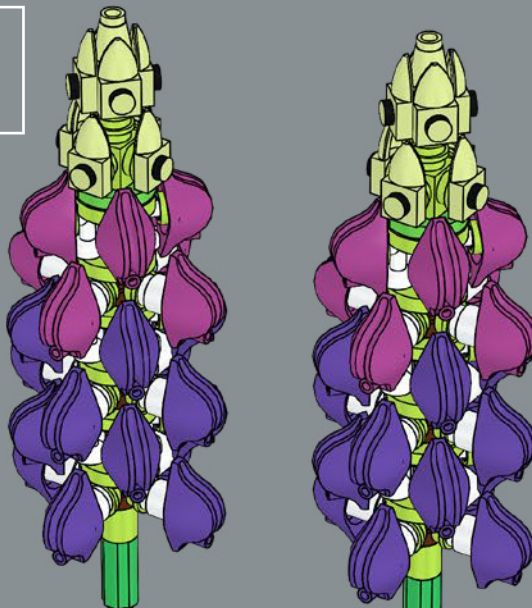



## ESPUELA DE CABALLERO

(*Consolida ajacis*)

✿ La espuela de caballero nos regala vistosos mares de flores silvestres en un amplísimo espectro de tonalidades azules que se apoderan de prados y jardines de todo el hemisferio norte. Su ciclo anual comienza a inicios de la primavera y, al igual que sus parientes cercanos de hoja perenne del género *Delphinium*, aportan altura y un vaporoso y elegante toque de color a tu ramo.



## GERBERA

(*Gerbera jamesonii*)

✿ Prima del girasol, la lustrosa gerbera viene en tonalidades tan variadas como las del arcoíris. Originaria del sur de África, también se la conoce como *margarita africana* o *margarita del Transvaal*. Con su delicado aroma y una majestuosa corona elevada bordeada por pétalos suaves como el terciopelo, es capaz de llenar de luz cualquier jardín, prado o ramo.



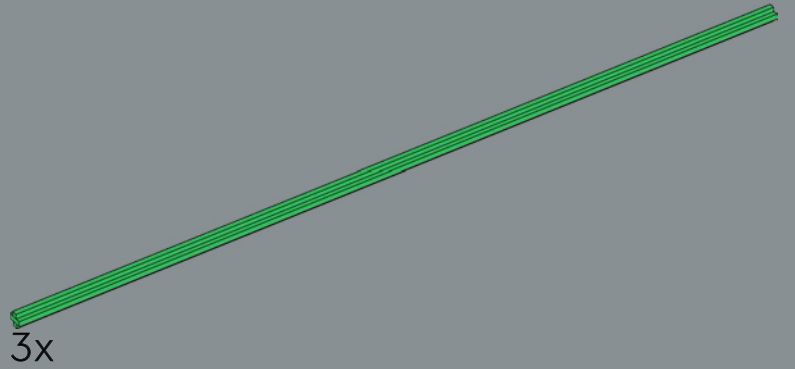
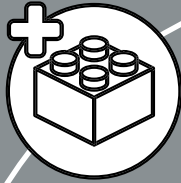

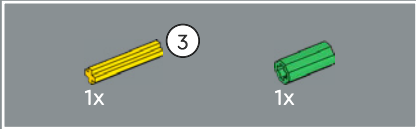
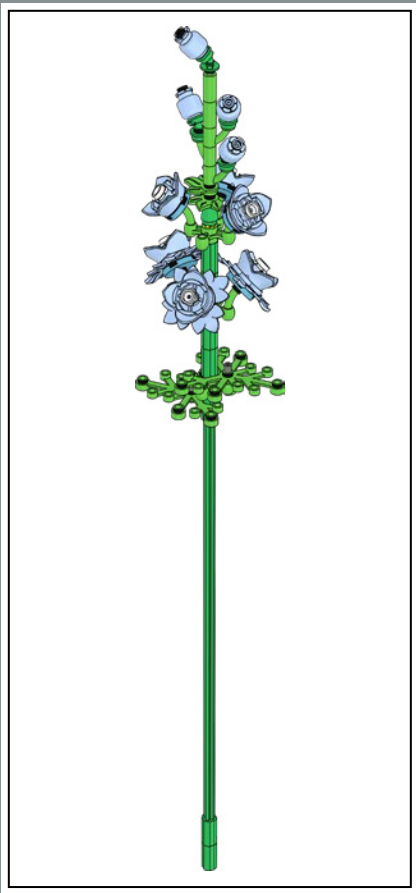

1

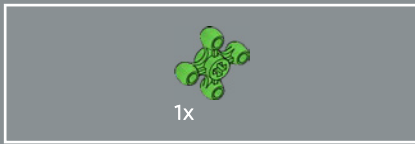
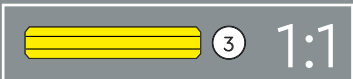
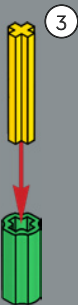

2

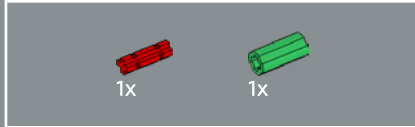
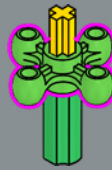

3

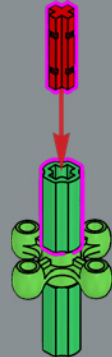



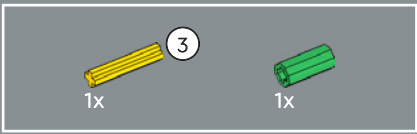

4

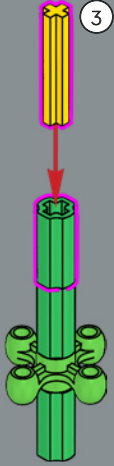

5

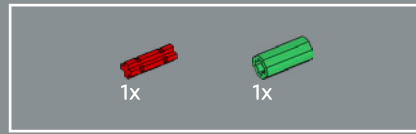
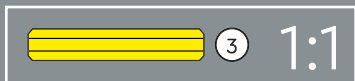
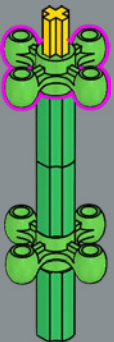

6

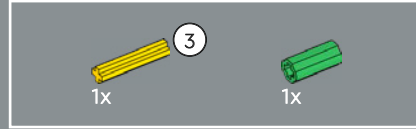
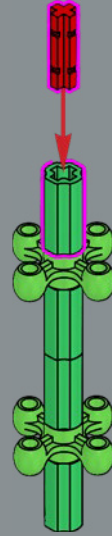

7

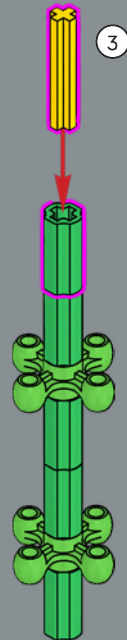



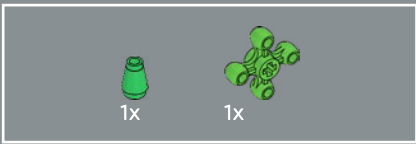

8

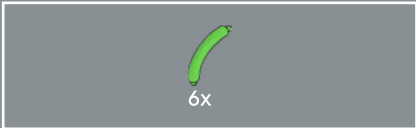
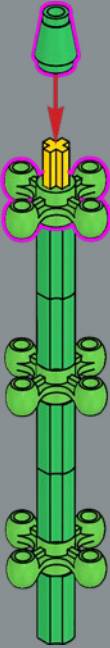

9

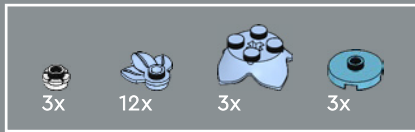
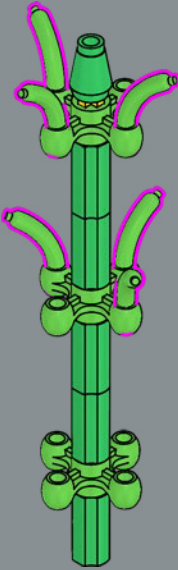

10

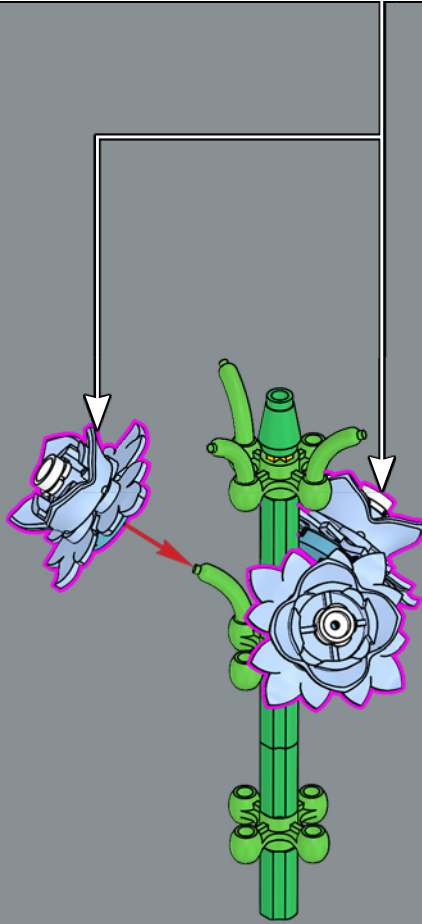
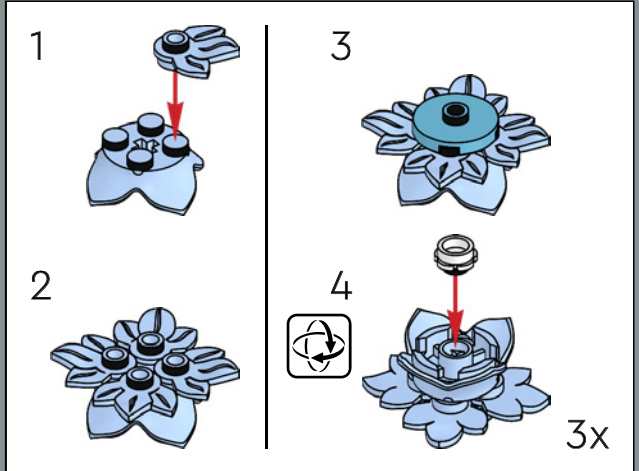

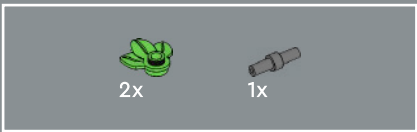

11

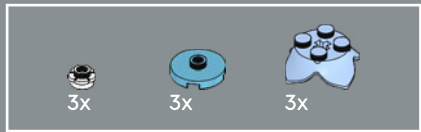
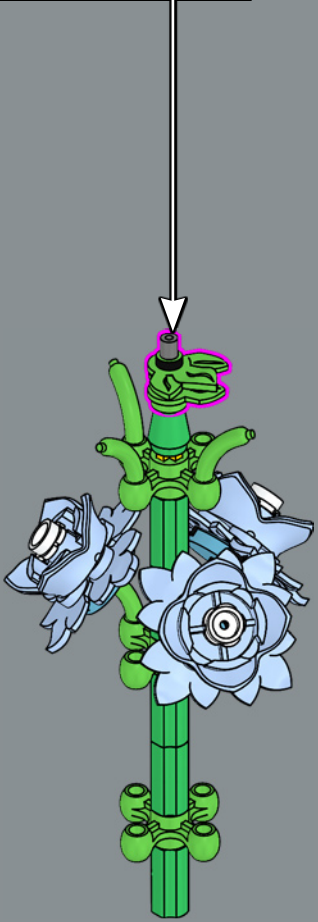
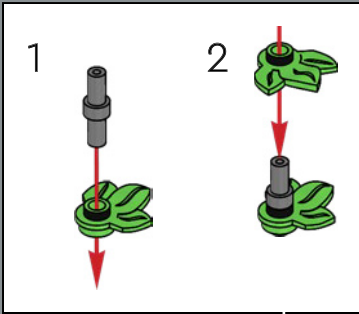

12

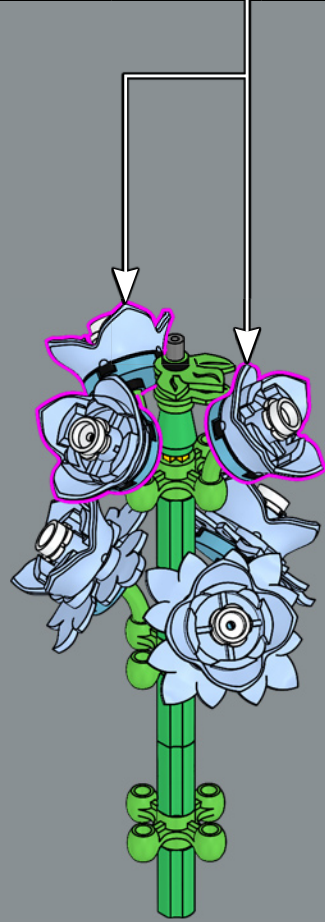
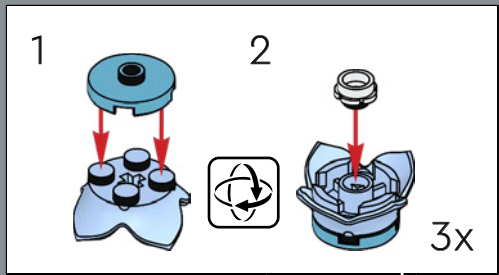

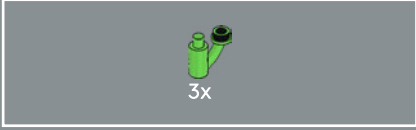
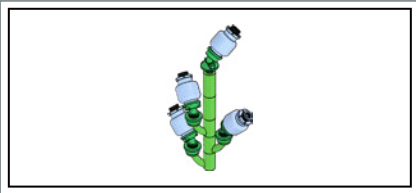

13

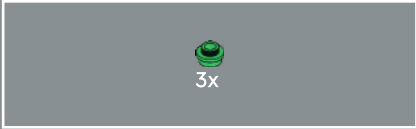

14

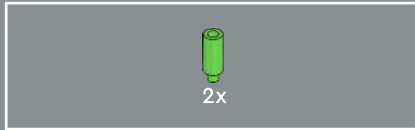
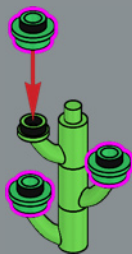

15

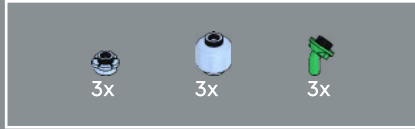
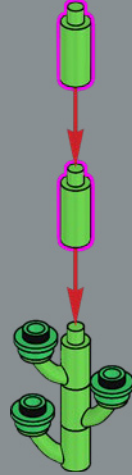

16

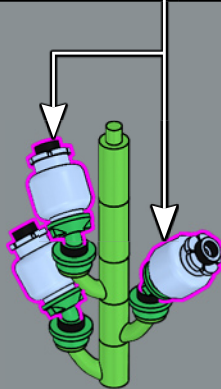
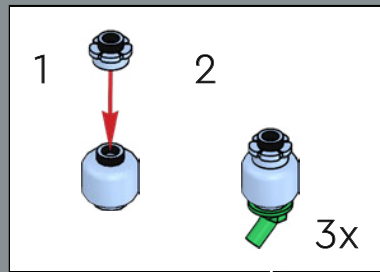



17

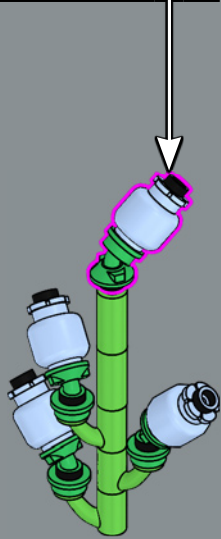
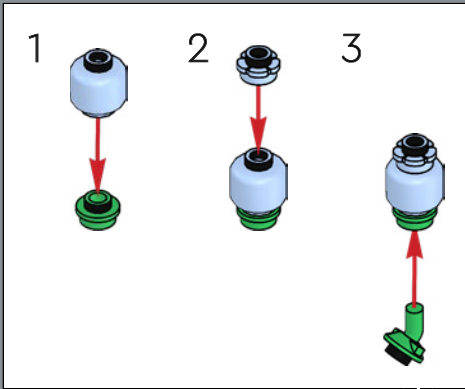

18

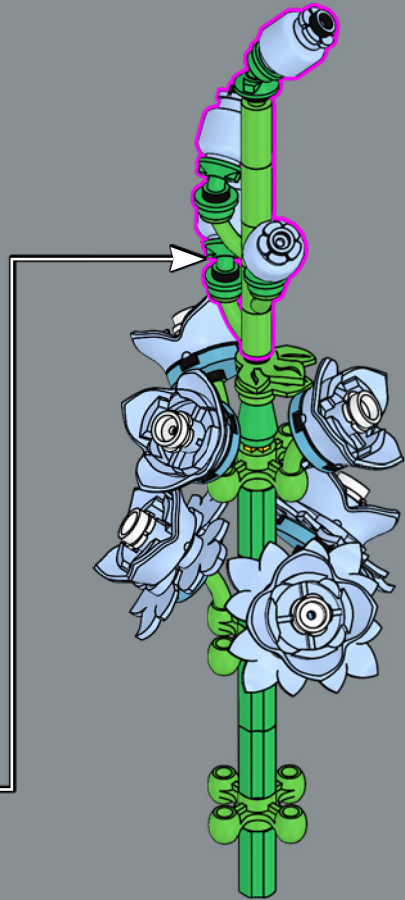

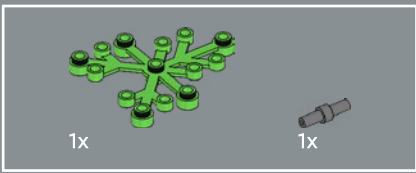

19

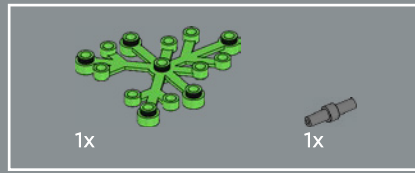
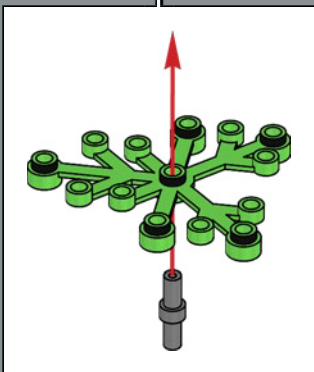
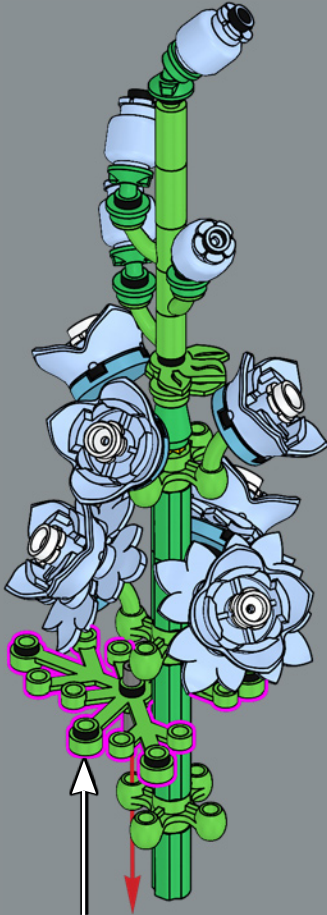

20

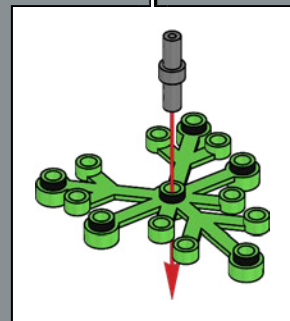
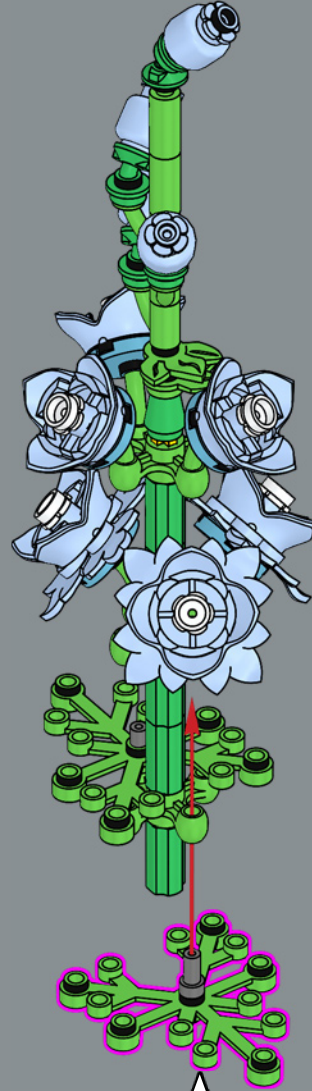

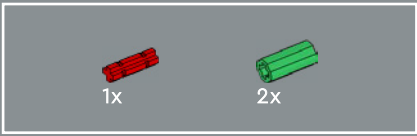

21

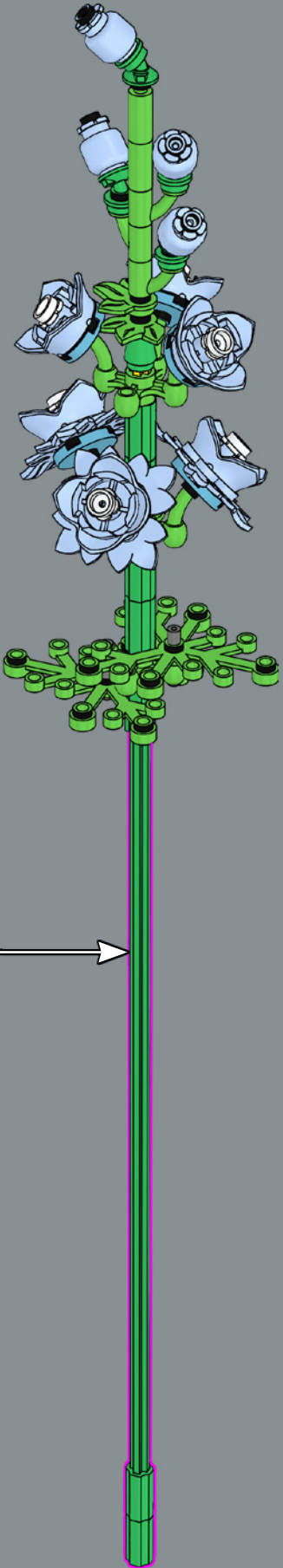
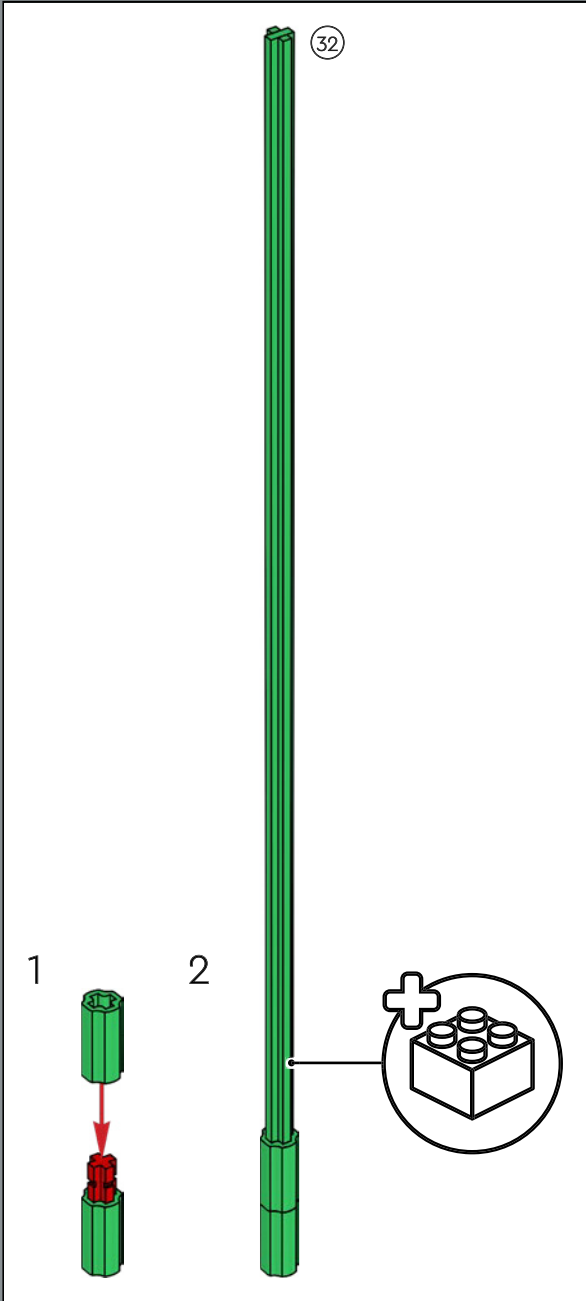

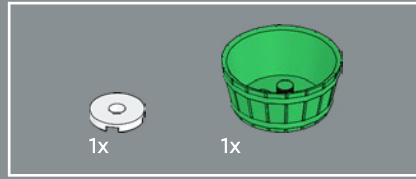
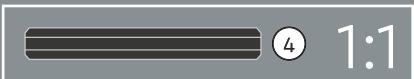
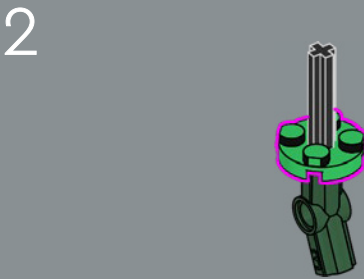
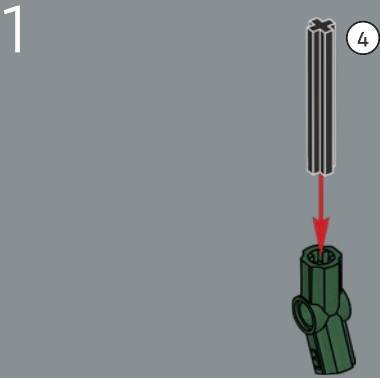
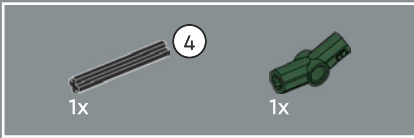

3

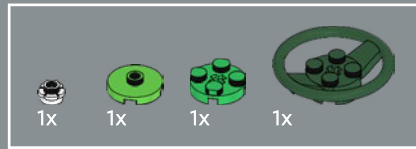
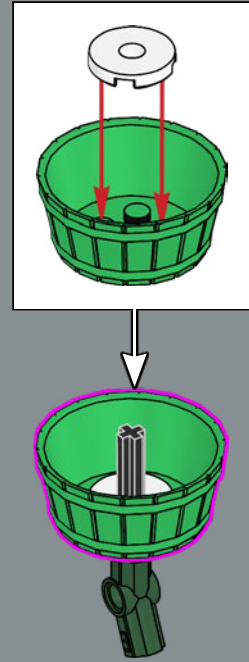

4

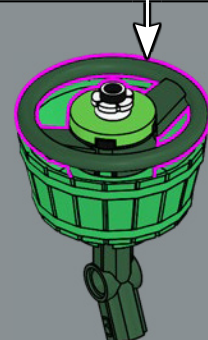
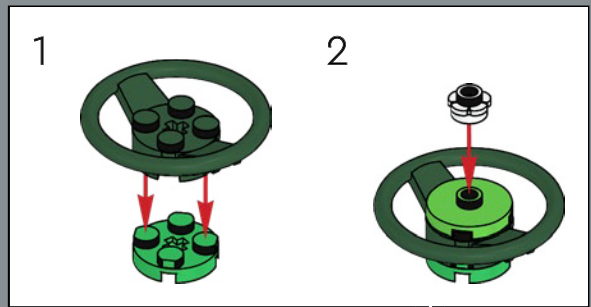





5

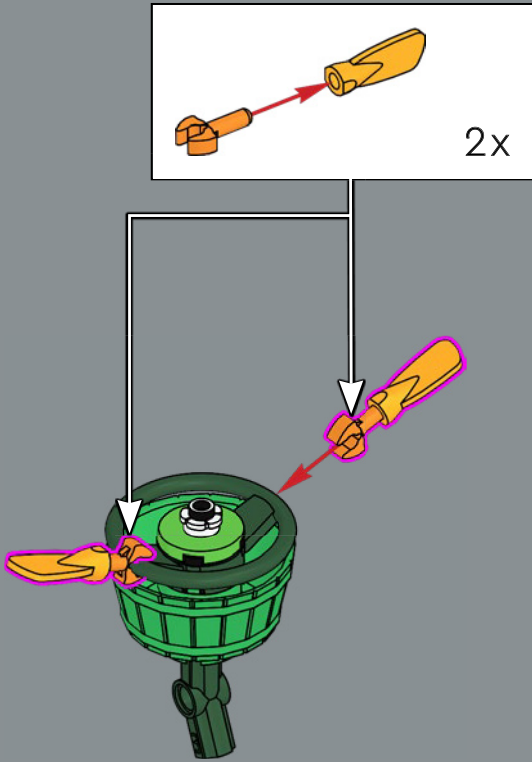

6

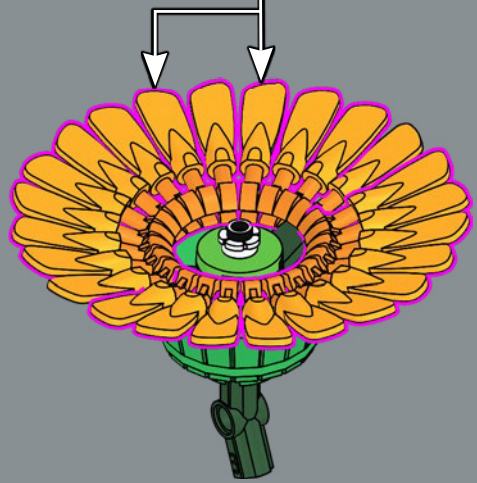
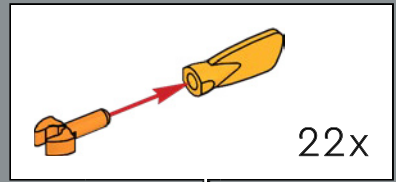

7



¡Estos pequeños y delicados pétalos son en realidad remos para minifiguras!



8

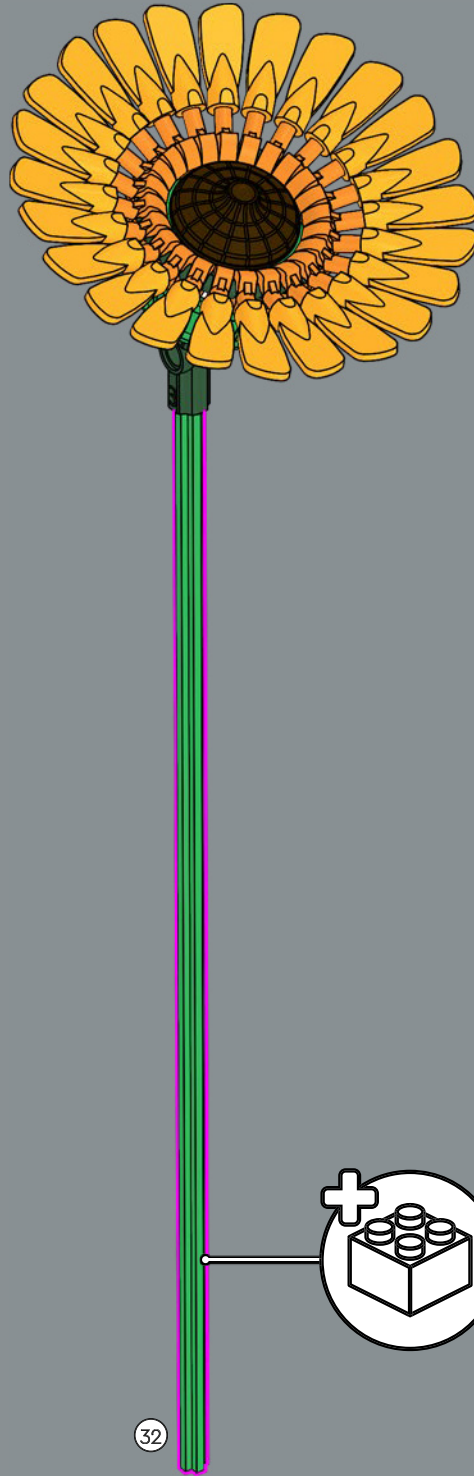



Introducida originalmente en 1983 como parte del tema LEGO® Fabuland, esta cubeta se ha utilizado en todo tipo de cosas, desde motores de cohetes hasta receptáculos de flores.

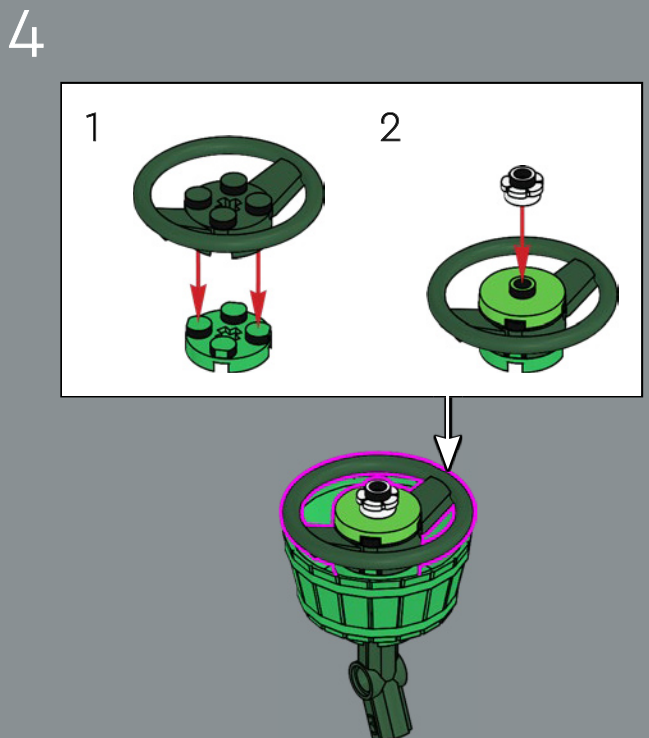
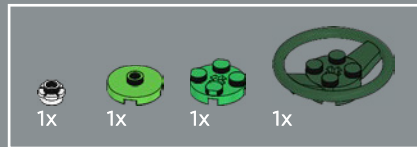
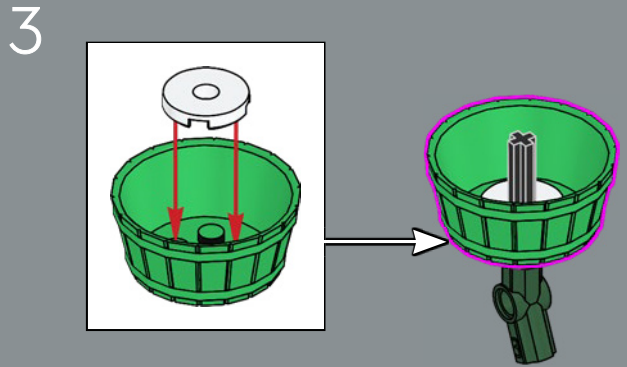
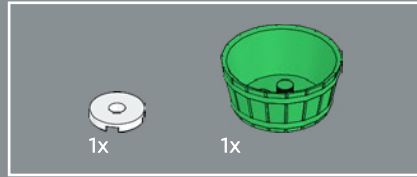
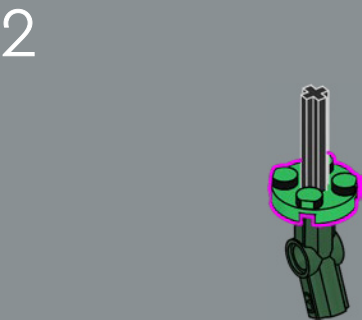
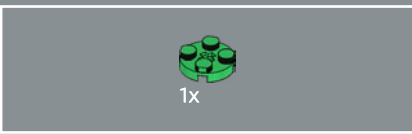
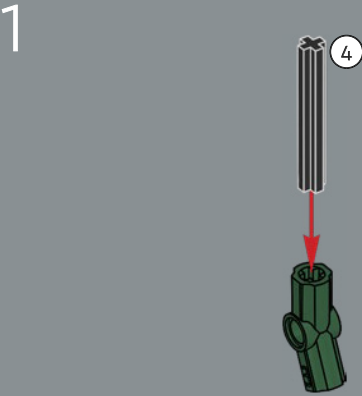
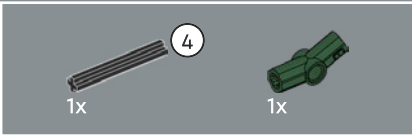



5

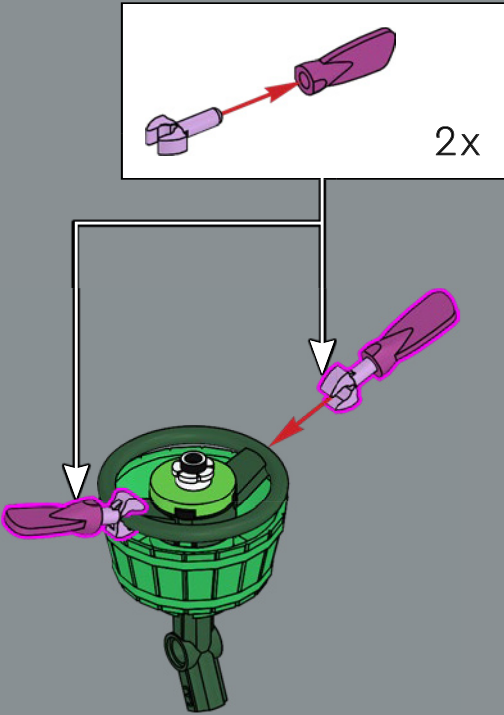

6

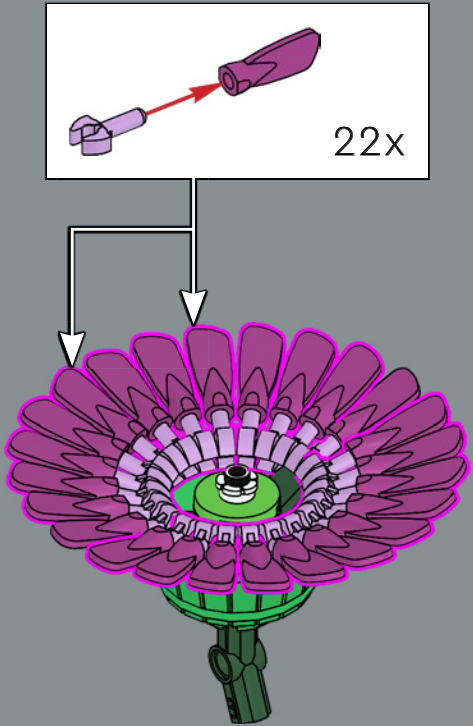

7



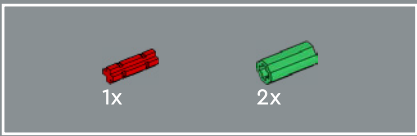

8

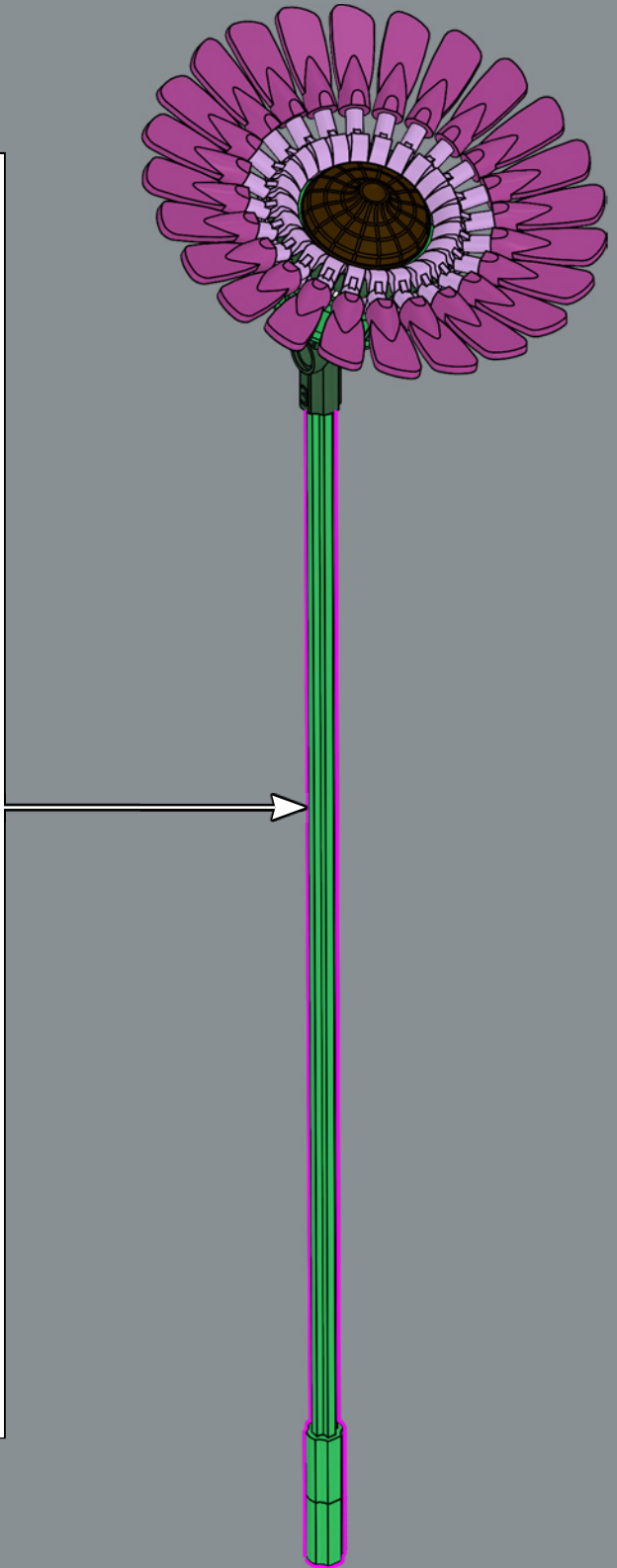
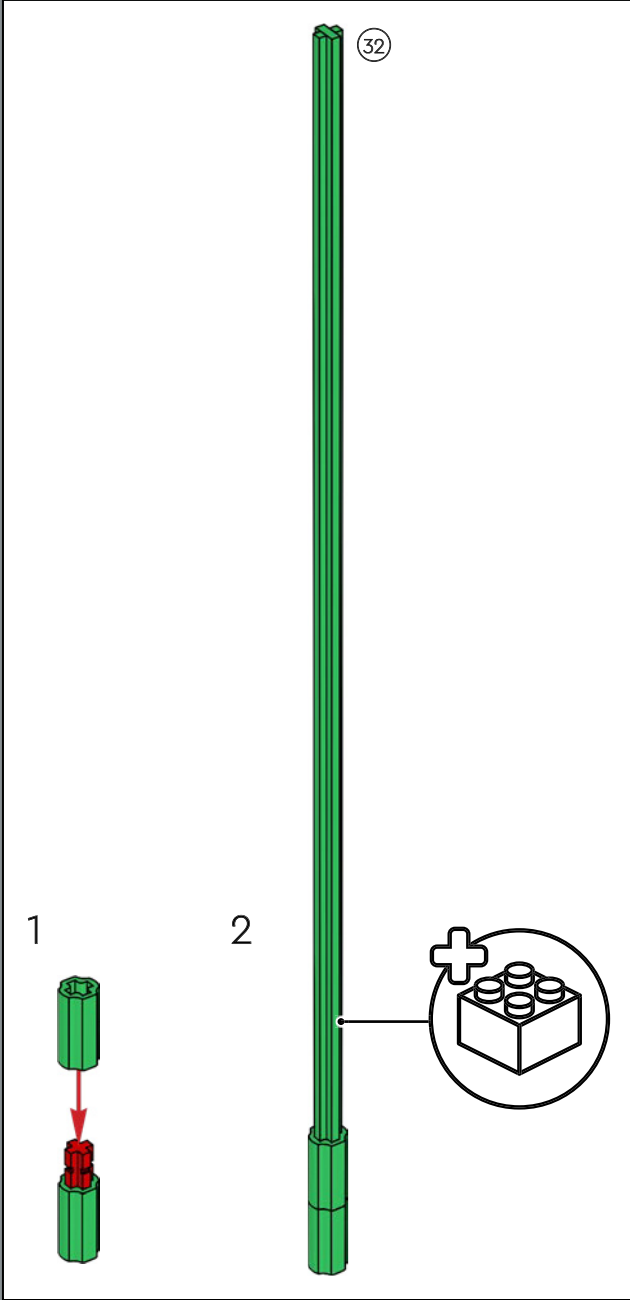

24x  
306201

2x  
6310185

24x  
459901

68x  
6206149

2x  
6170419

2x  
6194512

6x  
6259700

6x  
6339183

16x  
6348056

2x  
4515349

8x  
6420923

13x  
6130007

61x  
4142865

3x  
6055225

15x  
6420219

2x  
6329283

8x  
6344177

24x  
6330196

2x  
6329274

24x  
6424588

6x  
6133765

7x  
4211218

12x  
6316697

2x  
6382540

24x  
6420229

24x  
6420230

3x  
6350724

2x  
6116608

11

2x  
6178172

4x  
6209683

12x  
6420914

6x  
6420921

4x  
6294900

2x  
6420922

16x  
4566522

5x  
6420217

32x  
6420916

5x  
6420218

8x  
6190252

2x  
6416732

6x  
6136419

24x  
6210460

26x  
6214235

2x  
6329317

24x  
6420920

4x  
6420918

16x  
6267420

11x  
4529239

11x  
6338221

8x  
6210271

8x  
403228

2x  
6420221

2x  
6266964

20x  
6269971

11x  
6382575

3x  
6270084

50x  
6374076

2x  
6420635

12x  
6420964

4x  
6380676

10x  
6388070

5x  
6182261

2x  
6345196

7x  
6161772

7x  
6328327

7x  
6420228

3x  
6331087

6x  
6430093

3x  
6420915

1x  
6254100

24x  
6278159

4x  
6174006

2x  
6302741

60x  
6190251

10x  
6314224

4x  
6167483

16x  
6420919

24x  
6420220

3x  
6267045

3x  
6265699

2x  
370526

32



LEGO.com/service





## COMBINA TU RAMO

🌸 Tu Ramo de Flores Silvestres está diseñado para que también quede precioso en combinación con otros ramos. Encuentra ideas para construir composiciones creativas con el set Ramo de Flores (10280).

