

# DUCTOFAB<sup>®</sup>

COMPLETE DUCTING SOLUTIONS

RECTANGULAR • SPIRAL ROUND • SPIRAL FLAT OVAL

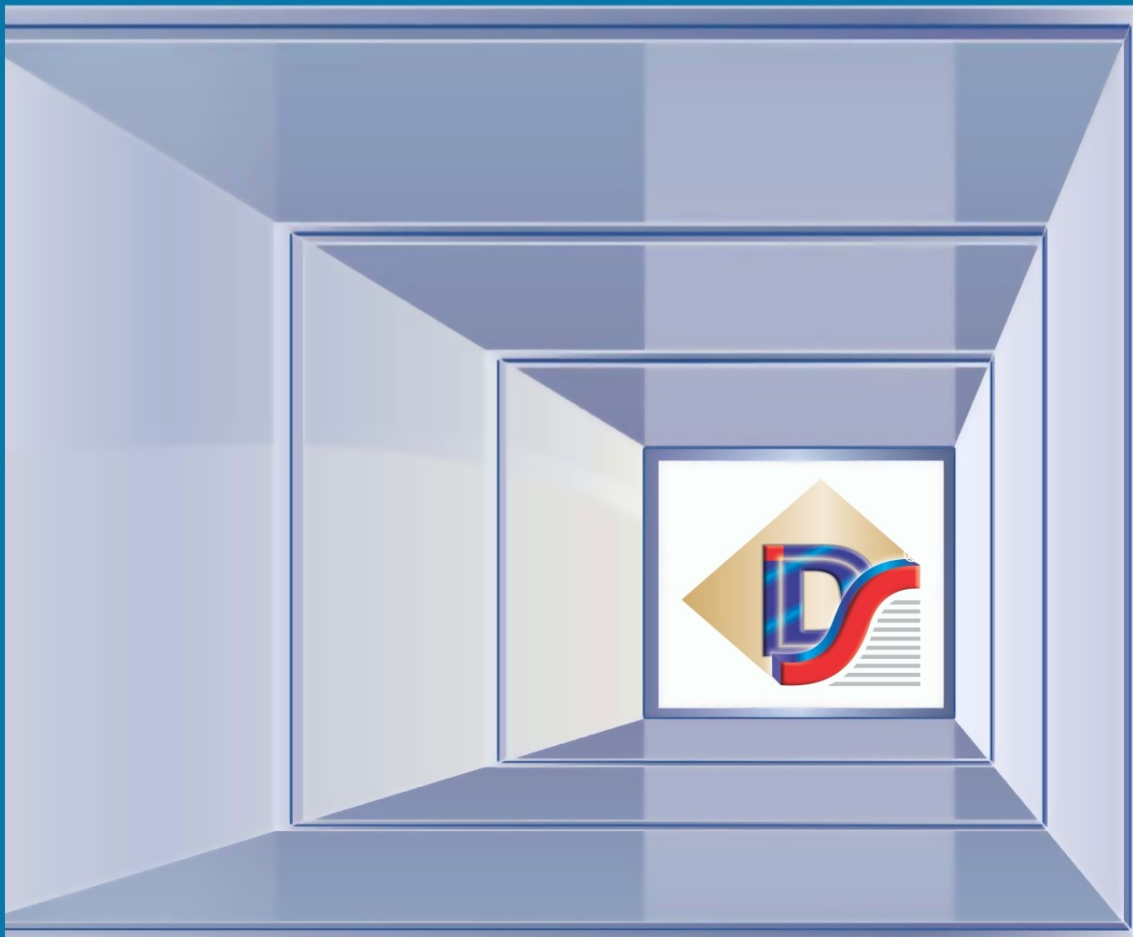

**D.S. DUCTOFAB SYSTEMS PRIVATE LIMITED**

ISO 9001:2015 CERTIFIED COMPANY

DELHI • MUMBAI • HYDERABAD • BENGALURU

## Company Profile

**D.S. Ductofab Systems Pvt. Ltd.**, a company whose foundation was laid more than 25 years ago by our Founder Chairman Late Shri S.C. Gupta, now being managed by his next generation **Mr. Ritesh Gupta & Mr. Aman Gupta**, as Directors, is a company pioneer in manufacturing Factory Fabricated Ducts in following profiles:

**"Rectangular, Spiral Round and Spiral Flat Oval (Elliptical) Ducts"**

## Manufacturing Units

<b>Northern Region</b>	- Sampla, Distt-Rohtak, (Haryana)
<b>Western Region</b>	- Vapi, Distt-Valsad (Gujarat)
<b>Southern Region Plant-1</b>	- (Hyderabad)
<b>Southern Region Plant-2</b>	- Jigani Industrial Area (Bengaluru)
<b>Eastern Region</b>	- (coming soon...)

## Quality Policy

We at "DS DUCTOFAB SYSTEMS PVT.LTD." are committed to deliver the products to our customers in time and with continual improvements.

We produce quality product by monitoring processes & stringent quality checks through our workforce.

We shall achieve these by continual improvement of our system and up-gradation of employee's skill & team work.

## Serving HVAC Industry

When you partner with DUCTOFAB, you can rely on our services including:

- # Strategically located factory
- # Enhanced quick deliveries
- # Adequate quality products
- # Excellent fill rates and short lead times

## Vision

**"To be unrivalled through our hard work, transparency, honesty & sincerity"**

# Product Range

## RECTANGULAR DUCT

**Galvanized Iron (GI)**  
**Insulated Duct (GI)**  
**Aluminium (Al)**  
**Stainless Steel (SS)**



## SPIRAL FLAT OVAL DUCT

**Galvanized Iron (GI)**  
**Insulated Duct (GI)**  
**Double Wall Duct (GI)**



## SPIRAL ROUND DUCT

**Galvanized Iron (GI)**  
**Insulated Duct (GI)**  
**Double Wall Duct (GI)**



## MS - FLANGE DUCT



## SLIP ON FLANGE DUCT



## ROUND TO SQUARE DUCT



## OVAL V C D



## LP PLENUM / TERMINAL BOX





# Plant & Amenities

**Ductofab** has a colossal plant facility for optimal working and production space, which adds in minimizing the time consumed in production process thus helping deliver material in time. We use world class sheet metal fabrication and profiling technology for achieving new technical standards of modern air distribution systems. A few of them have been mentioned below:

## # PRODUCTOMATIC (AUTO LINE-V):

**AUTO LINE-V** is the basic machine which has the capacity to perform operations for Coil Set, Bead (Stiffening), Notch, Multiple Duct profile blanks, Pittsburgh lock, Transverse duct Flange (T D F), Wrap or L-Shape Bend at different stages on single CNC machine. Human machine interface (H M I) is used to input production data & it utilizes programmable logic controls (P L C) for manufacturing.



**PLASMA PROFILE CUTTING MACHINE:** Excellent cut quality and precision on a wide variety of material which provides the widest range of profiles for all Duct Fittings (elbows, tapers, offsets, branches, dead end, Y-Pieces etc.) & other sections. It has latest software supports and profile cutting (Plasma cutting) technology to optimise each duct profile with specifications and standards.



**DUPLEX TDF ROLLFORMER / TDF CLEAT FORMING MACHINE:** This machine produces TDF flange (Transverse Duct Flanges) that is roll formed on the straight duct and fitting pieces with Same Sheet Technology.

This system provides an air tight connection using 4-Bolt System with Transverse Duct Flange (Connectors).



### **CORNERMATIC**

Corner Matic machine is used to fix T D F corners automatically on duct pieces efficiently and to save on precious time.



### **ZIPLOCKER**

Zip Locker Machine is used to facilitate Boxing of L-Shape / Open Box Straight Hollow Profiles. This machine performs operation to close Longitudinal seam (Pittsburgh lock) with Hydraulic systems to speed up Profile work.



**SPIRAL TUBE FORMER** : This machine is used to form Spiral Round Duct.



**OVALIZER** : This machine is used to form Spiral Flat Oval (Elliptical) Duct





# Manufacturing Facilities

## NORTHERN REGION: SAMPLA, HARYANA



**Factory Area**

**4.5 Acres**

**Manufacturing Capacity**

**6000 Sq. Mtr. (Per Day)**

**Manpower**

**190 nos.**

## WESTERN REGION: VAPI, GUJARAT



**Factory Area**

**1.5 Acres**

**Manufacturing Capacity**

**3500 Sq. Mtr. (Per Day)**

**Manpower**

**90 nos.**



## SOUTHERN REGION: HYDERABAD



### Factory Area

**1 Acres**

### Manufacturing Capacity

**3000 Sq. Mtr. (Per Day)**

### Manpower

**70 nos.**

## SOUTHERN REGION: BENGALURU



### Factory Area

**1.75 Acres**

### Manufacturing Capacity

**4500 Sq. Mtr. (Per Day)**

### Manpower

**110 nos.**

### Head Office:-

#### **D.S. DUCTOFAB SYSTEMS PVT. LTD.**

7, Bhera Enclave, 3rd Floor (Above Sony Showroom)  
Paschim Vihar, New Delhi-110087

Tel.: 011-42486777 | Email id: sales@ductofab.in, info@ductofab.in

### Northern Region Plant:-

Sampla Beri Road, VPO- Sampla,  
Distt. – Rohtak, Haryana – 124501  
Tel: +91-82220 87009  
Email id: sales@ductofab.in,  
salesnorth@ductofab.in

### Western Region Plant:-

Plot No.-311, 40 Shed Area, GIDC Phase-II,  
Vapi, Distt. Valsad, Gujarat – 396191  
Tel: +91-7227 048106  
Email id: saleswest@ductofab.in



### Southern Region Plant:-

Plot No. 163, Phase-III, Gate No. 2,  
IDA, Cherlapally, Hyderabad,  
Telangana – 500051  
Tel: +91-9121243009, 9121243010  
Email id: salessouth@ductofab.in

### Southern Region Plant:-

Plot No. 31 B, Phase-I, Industrial Area, Jigani,  
Bengaluru, Karnataka, (Near Anand Sweets Unit)  
Tel: +91-9667799602  
Email id: ductofab.bnglr@yahoo.com

for PAN India sales enquiries: E-mail us at sales@ductofab.in

Visit our website at : [www.ductofab.in](http://www.ductofab.in)



# Prestigious Projects

## NORTH



AMRITA HOSPITAL FARIDABAD



CAPPIMS DELHI



DIAL DELHI



GOOGLE GURGAON



ICC DWARKA



LUCKNOW AIRPORT



LULU MALL LUCKNOW



MEDANTA HOSPITAL LUCKNOW



ITPO DELHI



SUPREME COURT NEW BUILDING, DELHI

## EAST



AIIMS GUWAHATI



BETTIAH MEDICAL COLLEGE BIHAR



AMITY KOLKATA



AIIMS KALYANI



CNCI KOLKATA



BHARAT SEVASHRAM SANGHA HOSPITAL KOLKATA



IGIMS PATNA



JW MARRIOTT KOLKATA



NEIGRIHMS SHILLONG



SHRISHTI HOTEL KOLKATA

## WEST



AIIMS NAGPUR



ALKEM DAMAN



BARCLAYS PUNE



BKT TYRES BHUJ



BRIDGESTONE PUNE



DAICEC MUMBAI



GARUD GUJARAT



LODHA WORLDVIEW MUMBAI



SERUM INSTITUTE PUNE



TATA MOTORS PUNE

## SOUTH



AMAZON HYDERABAD



CIAL CHENNAI

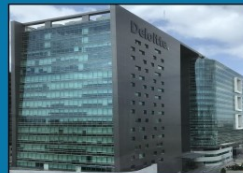

DELOITTE HYDERABAD



GAR HYDERABAD

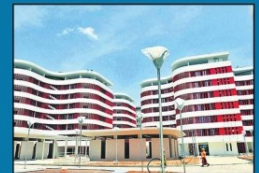

IIT HYDERABAD



KEMPEGOWDA AIRPORT BANGALORE



NTPC KUDGI



QUALCOMM HYDERABAD



RGI AIRPORT HYDERABAD



TCS ADIBATLA