

YGG-KB/oil pressure block oil circuit plate lever cylinder

Pressure Range

15-70kg/cm<sup>2</sup>



Three-way clamping arm

3 types of clamp arms with different installation directions are available and can be selected according to the workpiece, oil pressure piping and fixture settings.

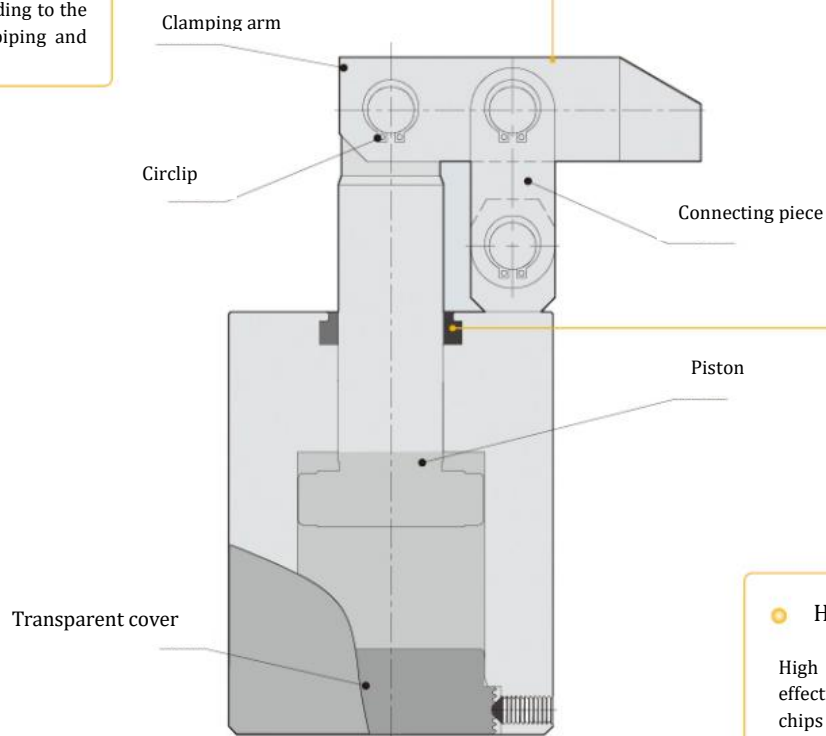

High quality seals

High quality seals are used to effectively prevent coolant and chips from entering the cylinder block.

The figure shows the sectional view of the YGG-KB clamping state

Model Representation

**YGG-KB** ① ② (Example: YGG-KB25R)



① Dimension (refer to specification sheet)

25
32
40
50
63

② Clamping arm direction

F: forward
L: left
R: right

Oil Circuit Plate Method

Action Description

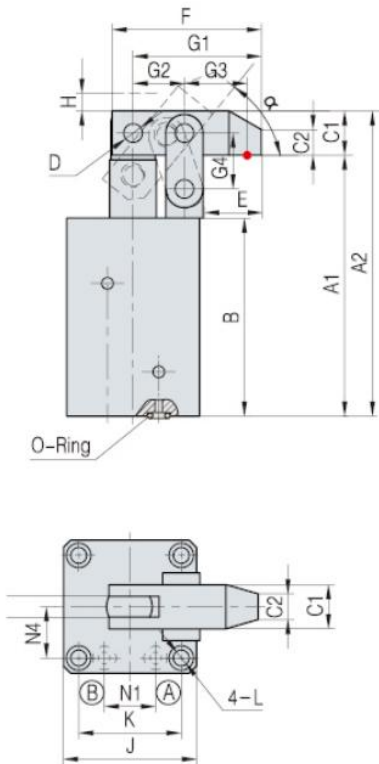
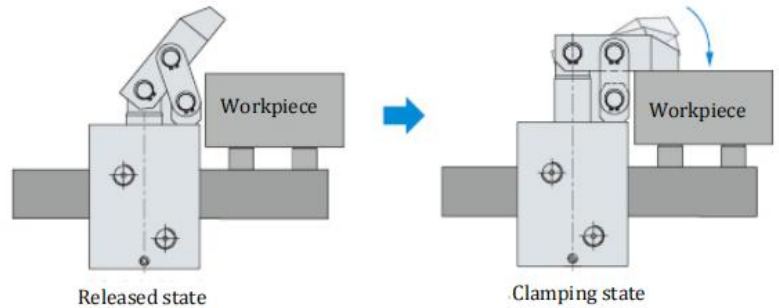
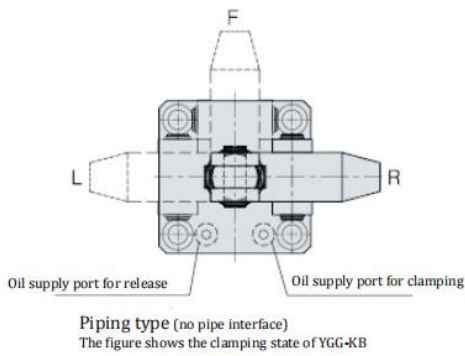

Overall Dimension

Model	YGG-KB25	YGG-KB32	YGG-KB40	YGG-KB50	YGG-KB63
Dimension					
A1	103	111.9	121.9	138.3	155.1
A2	122	131	144.1	163.7	186.9
B	76	85	90	100	111
C1	□19	□19	□22.2	□25.4	□31.8
C2	11	11	13	15	19
C3	9	9	10	11	15
ΦD	Φ8	Φ8	Φ10	Φ12	Φ15
E	25	25	31	37	43
F	64	64	77	90	110
G1	55	55	66	77	94
G2	22	22	26	30	36
G3	28	28	34	39	48
G4	24	24	29	33	39
H	3	3	4	3	4
J	55	57	69	75	96
K	42	44	52	58	75
L	Φ6.8-Φ10.5*6.5D	Φ6.8-Φ10.5*7D	Φ9-Φ14*9D	Φ9-Φ14*9D	Φ11-Φ18*11D
N1	18	22	26	32	38
N4	20	22	26	30	38
O-Ring	P7	P7	P7	P7	P7
α	60°	63°	61°	65°	59°

H: Rising space  
A-clamp port  
B-release port

Note: □ indicates square

- Optimal clamping position

Allowable Eccentricity of Clamping Arm

When the clamping point at the front end of the clamping arm of YGG connecting rod lever cylinder is not on the center line of the piston rod and the clamping arm due to the shape of the workpiece, the eccentric clamping arm shown in the right figure can be used. However, the eccentricity shall not exceed the allowable eccentricity in the following table. If a clamping arm exceeding the allowable eccentricity is used, the connecting rod mechanism and the piston rod will bear a large eccentric load, resulting in fault.

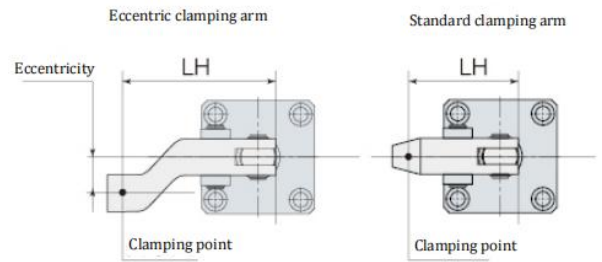

YGG-KB25	
Oil pressure (MPa)	Allowable eccentricity (mm)
	Clamping arm length G2+G3 (mm)
	50
7	22
6.5	25
6	32
5.5	37
5	47
4.5	57
4	↑
3.5	↑
3	↑
2.5	57

YGG-KB32	
Oil pressure (MPa)	Allowable eccentricity (mm)
	Clamping arm length G2+G3 (mm)
	50
7	
6.5	
6	5
5.5	10
5	15
4.5	21
4	27
3.5	37
3	51
2.5	57

YGG-KB40	
Oil pressure (MPa)	Allowable eccentricity (mm)
	Clamping arm length G2+G3 (mm)
	60
7	5
6.5	5
6	12
5.5	21
5	32
4.5	45
4	57
3.5	↑
3	↑
2.5	57

YGG-KB50	
Oil pressure (MPa)	Allowable eccentricity (mm)
	Clamping arm length G2+G3 (mm)
	69
7	15
6.5	23
6	30
5.5	35
5	42
4.5	50
4	57
3.5	70
3	↑
2.5	70

YGG-KB63	
Oil pressure (MPa)	Allowable eccentricity (mm)
	Clamping arm length G2+G3 (mm)
	84
7	11
6.5	17
6	25
5.5	35
5	47
4.5	59
4	70
3.5	80
3	↑
2.5	80