

High cost performance connecting rod clamp with compact structure, large capacity and strong durability

**Model Representation**

HLKA ① - ②

(Example: HLKA0480-CR)

① Dimensions (refer to specification sheet)

② Clamping arm installation direction

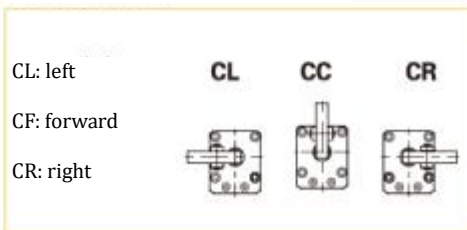
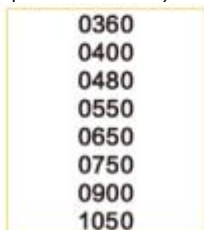

**Specification**

Model		HLKA0360	HLKA0400	HLKA0480	HLKA0550	HLKA0650	HLKA0750	HLKA0900	HLKA1050	
Cylinder capacity (when the oil pressure is 7MPa)		(kN)	3.2	3.8	5.0	6.8	11.2	16.7	25.5	35.2
Clamping force※1	When oil pressure is 7MPa	(kN)	2.2	2.7	3.6	4.4	7.7	12.0	19.9	27.4
	Clamping arm length (LH)	(mm)	33.5	36.5	42	50	56.5	67.5	77.5	95
Diameter of main rod		(mm)	10	12	14	16	20	22	28	35.5
Cylinder outer diameter		(mm)	36	40	48	55	65	75	90	105
Cylinder area (clamping)		(cm <sup>2</sup> )	4.52	5.31	7.07	9.62	15.9	23.8	36.3	50.3
Full stroke			18.5	20.5	23.5	26	29.5	35	41	49
Clamping stroke			16	17.5	20.5	23	26.5	32	38	46
Maximum working pressure		(MPa)	7							
Minimum working pressure※2		(MPa)	0.5							
Withstand voltage		(MPa)	10.5							
Working temperature		(°C)	0~70							
Working fluid			ISO viscosity grade ISO-SG-32 general hydraulic oil							

Operating oil pressure range: 1.5 to 7MPa Guaranteed pressure resistance: 10.5MPa Operating ambient temperature: 0-70°C

Operating fluid: ordinary mineral oil-based hydraulic oil (equivalent to ISO-VG32)

※ 1: The clamping force varies with the length of the clamping arm.

※ 2: When installed horizontally, the limit value that can lift the clamping arm with a pressure of 1.5MPa.

**Overall Dimension**

C: plate connection type (speed control valve can be installed, with G thread plug)

※This figure shows type HLKA-CC

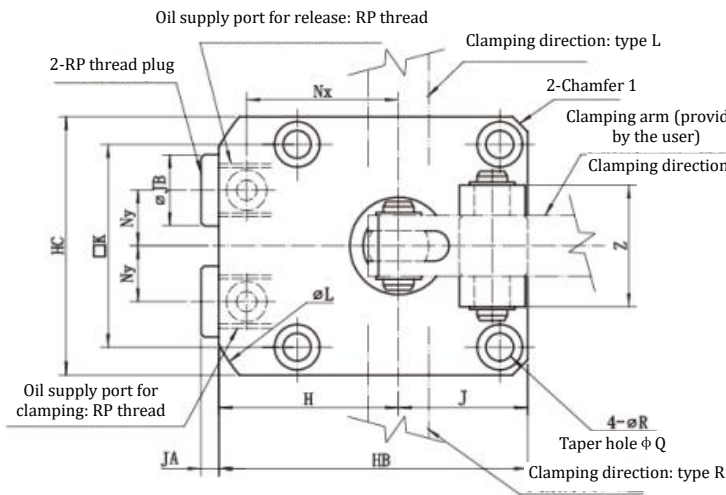
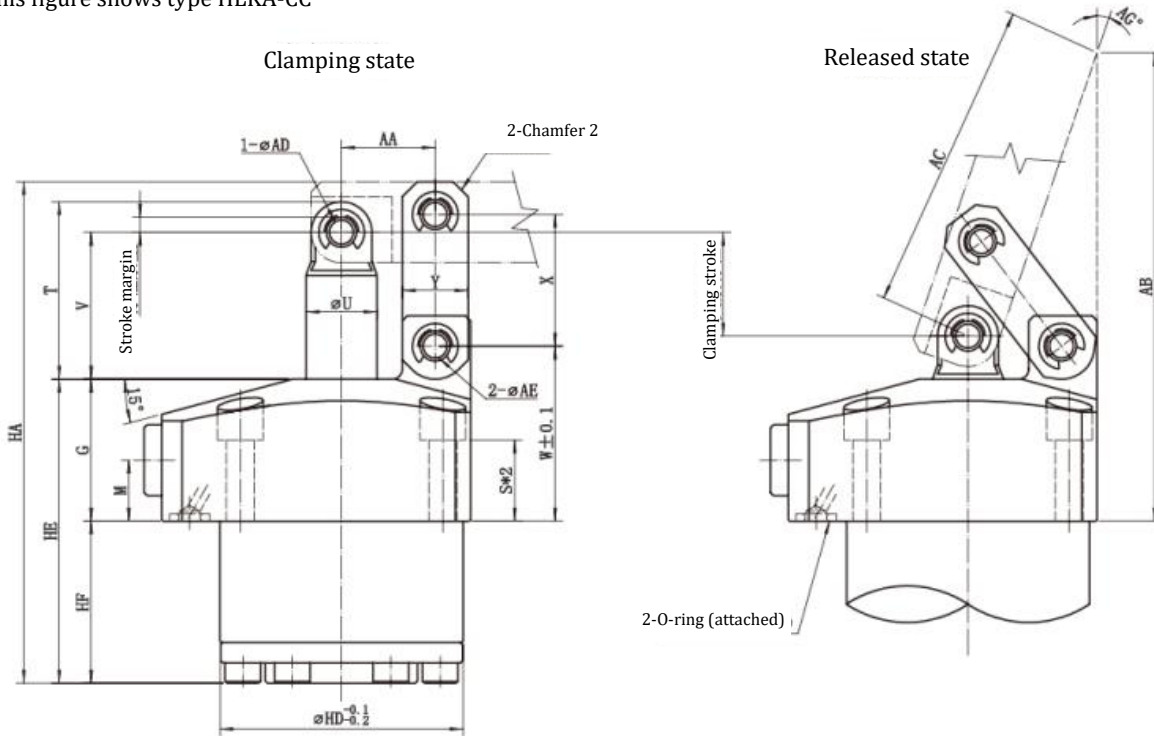

**Installation hole processing drawing**

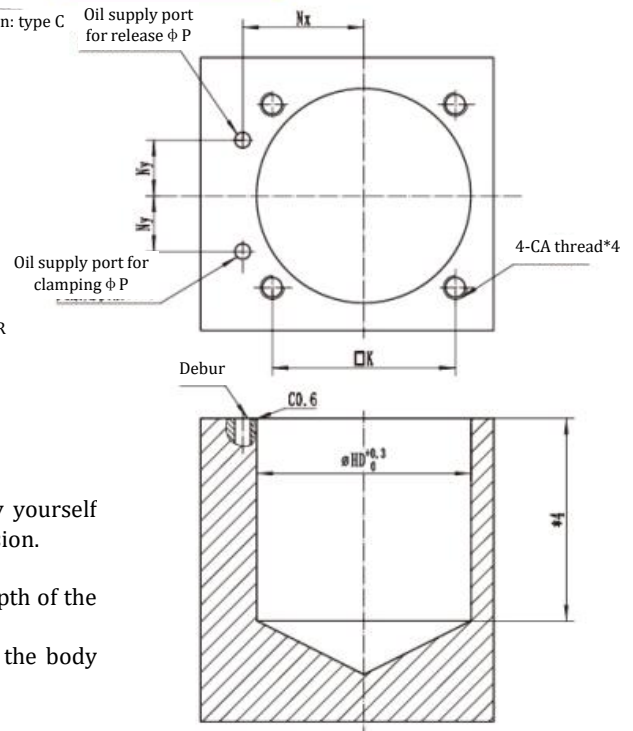

**Precautions:**

- ※1. Only the HLKA0650 flange has an inclination angle of 12° .
- ※2. This product includes installation bolts. Please configure it by yourself according to the installation height and with reference to the S dimension.
  - 1. Please use the attached pin for the clamping arm installation pin
- ※3. Please refer to the S dimension and determine the CA thread depth of the body installation bolts according to the installation height.
- ※4. Please refer to the HF dimension and determine the depth of the body installation hole ΦHD according to the installation height.
- ※5. This processing shows the case of plate connection type.

## Overall Dimension

Model	HLKA0360-□□	HLKA0400-□□	HLKA0480-□□	HLKA0550-□□	HLKA0650-□□	HLKA0750-□□	HLKA0900-□□	HLKA1050-□□	
Full stroke	18.5	20.5	23.5	26	29.5	35	41	49	
Clamping stroke	16	17.5	20.5	23	26.5	32	38	46	
Stroke margin	2.5	3	3	3	3	3	3	3	
HA	78.6	87.6	99.1	110.6	127.6	151.1	180.1	209.1	
HB	49	54	61	69	81	94.5	109.5	127	
HC	40	45	51	60	70	85	100	120	
HD	36	40	48	55	65	75	90	105	
HE	48	54	60	65	73.5	84	101	115	
HF	23	29	32	37	43.5	47	61	65	
G	25	25	28	28	30	37	40	50	
H	29	31.5	35.5	39	46	52	59.5	67	
J	20	22.5	25.5	30	35	42.5	50	60	
K	31.5	34.1	40.1	47.1	55.1	63.1	75.1	88.1	
L	66	72	81	88	106	116	136	152	
M	11	11	12	12	13	16	16	19	
NX	23.5	26	30	33.5	39.5	45	52.5	60	
NY	8	9	11	12	15	16	18.5	22.5	
P	3	3	3	3	5	5	5	5	
Q	7.5	9	9	11	11	14	17.5	20	
R	4.5	5.5	5.5	6.8	6.8	9	11	14	
S	15.5	15	16	13.5	16	17.5	17	23	
T	27	30.5	35	37.5	45	55	64.5	77	
U	10 f7	12 f7	14 f7	16 f7	20 f7	22 f7	28 f7	35.5 f7	
V	22.5	25	29	31.5	37	45	52	62	
W	30	30.5	34.5	35.5	39	48	52.5	64	
X	20	22	26	30	35.5	43.5	52.5	64	
Y	11	13	13	16	19	25	28	32	
Z	19	21	24	28	37	40	49	64	
Chamber 1	C2	C3	C3	C3	C4	C10	C11	(Φ152)	
Chamber 2	C2.5	C3	C3	C3	C5	C5	R16	R18	
AA	14.5	16	18.5	21	24.5	30	36	44	
AB	74.3	77.7	92.4	101.9	111.4	130.8	146.5	173.6	
AC	47.3	50.2	61.2	71.7	78.7	90.8	104.6	122.5	
AD	5	6	6	6	8	10	12	15	
AE	5	6	6	8	10	12	15	18	
AG	19.6	20.2	18.9	19.9	20.5	21.4	22.4	23.1	
CA	M4X0.7	M5X0.8	M5M.08	M6	M6	M8	M10	M12	
JA	3.5	3.5	3.5	3.5	4.5	4.5	4.5	4.5	
JB	14	14	14	14	19	19	22	22	
Oil supply port for clamping /release	Type-C	RP1/8	RP1/8	RP1/8	RP1/8	RP1/4	RP1/4	RP3/8	RP3/8
O-seal ring		4.8×1.9	4.8×1.9	4.8×1.9	4.8×1.9	6.8×1.9	6.8×1.9	6.8×1.9	6.8×1.9

### Overall Dimension

C: plate connection type (speed control valve can be installed, with G thread plug)

※This figure shows type HLKA-CCD

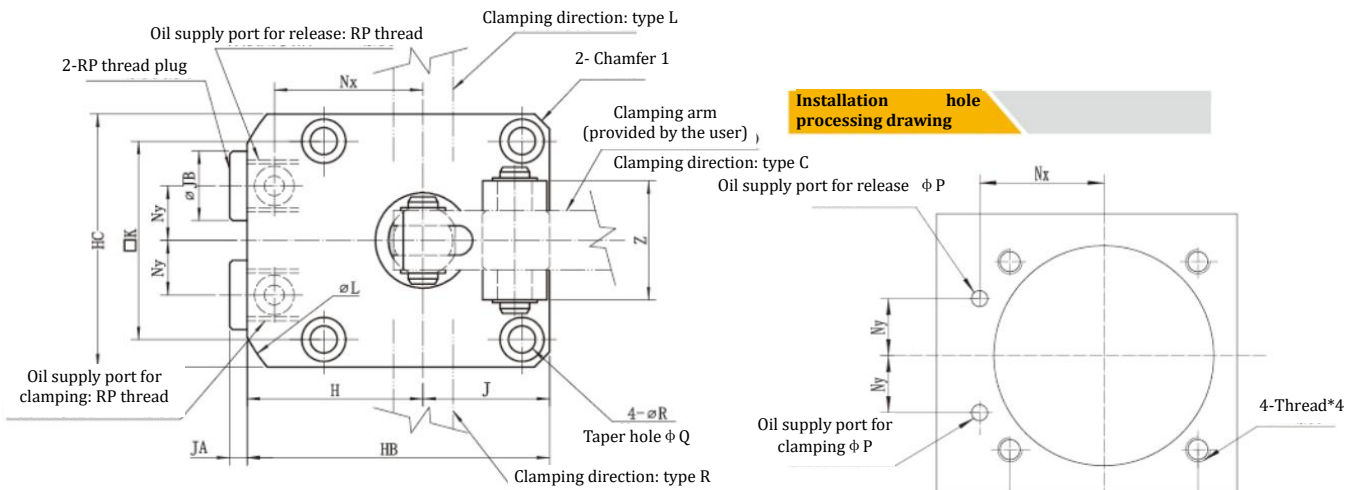
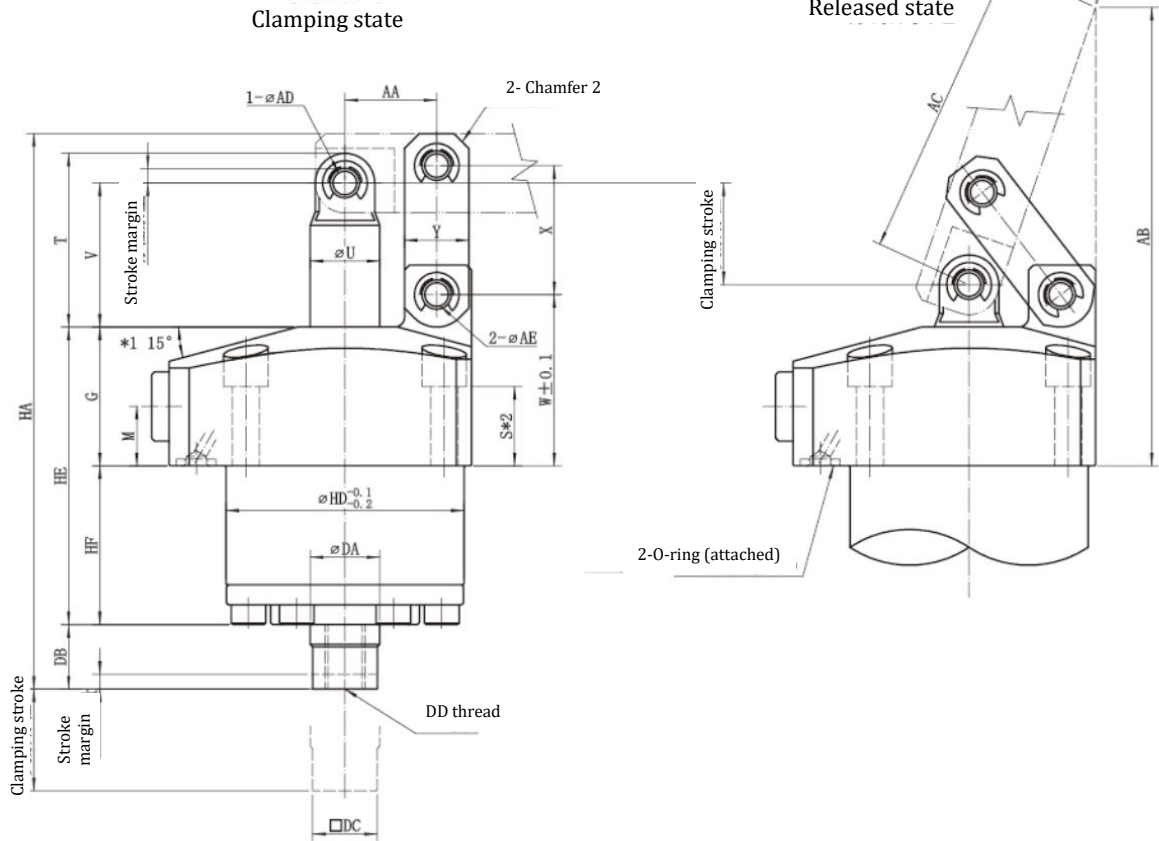

### Precautions:

- ※1. Only the HLKA0650 flange has an inclination angle of 12° .
- ※2. This product includes installation bolts. Please configure it by yourself according to the installation height and with reference to the S dimension.
  1. Use the attached pin (equivalent to Φ ADf6, ΦAEf6, and HRC60) for the pin for installing the platen.
  2. When a speed control valve is required, please purchase it separately on the premise of referring to P.80.
- ※3. Please refer to the S dimension and determine the CA thread depth of the body installation bolts according to the installation height.
- ※4. Please refer to the HF dimension and determine the depth of the body installation hole ΦHD according to the installation height.

**Model Representation**

**HLKA** ① - ② (Example: 0480-CLD)

① Dimensions (refer to specification sheet)

② Special specification mark (model example: HLKA0550-CCD)



**Overall Dimension and Installation Part Processing Dimension Table**

Model	HLKA0360-D	HLKA0400-D	HLKA0480-D	HLKA0550-D	HLKA0650-D	HLKA0750-D	HLKA0900-D	HLKA1050-D
Full stroke	18.5	20.5	23.5	26	29.5	35	41	49
Clamping stroke	16	17.5	20.5	23	26.5	32	38	46
Stroke margin	2.5	3	3	3	3	3	3	3
HA	89.1	100.6	112.1	123.6	140.6	164.1	193.1	222.1
HB	49	54	61	69	81	94.5	109.5	127
HC	40	45	51	60	70	85	100	120
HD	36	40	48	55	65	75	90	105
HE	48	54	60	65	73.5	84	101	115
HF	23	29	32	37	43.5	47	61	65
G	25	25	28	28	30	37	40	50
H	29	31.5	35.5	39	46	52	59.5	67
J	20	22.5	25.5	30	35	42.5	50	60
K	31.5	34.1	40.1	47.1	55.1	63.1	75.1	88.1
L	66	72	81	88	106	116	136	152
M	11	11	12	12	13	16	16	19
NX	23.5	26	30	33.5	39.5	45	52.5	60
NY	8	9	11	12	15	16	18.5	22.5
P	3	3	3	3	5	5	5	5
Q	7.5	9	9	11	11	14	17.5	20
R	4.5	5.5	5.5	6.8	6.8	9	11	14
S	15.5	15	16	13.5	16	17.5	17	23
T	27	30.5	35	37.5	45	55	64.5	77
U	10 f7	12 f7	14 f7	16 f7	20 f7	22 f7	28 f7	35.5 f7
V	22.5	25	29	31.5	37	45	52	62
W	30	30.5	34.5	35.5	39	48	52.5	64
X	20	22	26	30	35.5	43.5	52.5	64
Y	11	13	13	16	19	25	28	32
Z	19	21	24	28	37	40	49	64
Chamber 1	C2	C3	C3	C3	C4	C10	C11	(ø152)
Chamber 2	C2.5	C3	C3	C3	C5	C5	R16	R18
AA	14.5	16	18.5	21	24.5	30	36	44
AB	74.3	77.7	92.4	101.9	111.4	130.8	146.5	173.6
AC	47.3	50.2	61.2	71.7	78.7	90.8	104.6	122.5
AD	5	6	6	6	8	10	12	15
AE	5	6	6	8	10	12	15	18
AG	19.6	20.2	18.9	19.9	20.5	21.4	22.4	23.1
CA	M4X0.7	M5X0.8	M5M.08	M6	M6	M8	M10	M12
JA	3.5	3.5	3.5	3.5	4.5	4.5	4.5	4.5
JB	14	14	14	14	19	19	22	22
DA	8 f7	12 f7	14 f7	14 f7	14 f7	18 f7	18 f7	18 f7
DB	10.5	13	13	13	13	13	13	13
DC	6	10	12	12	12	16	16	16
DD (name×depth)	M4X0.7X10	M6X15	M8X18	M8X18	M8X18	M10X21	M10X21	M10X21
Oil supply port for clamping/release Type BP	RP1/8	RP1/8	RP1/8	RP1/8	RP1/4	RP1/4	RP3/8	RP3/8
O-seal ring	4.8×1.9	4.8×1.9	4.8×1.9	4.8×1.9	6.8×1.9	6.8×1.9	6.8×1.9	6.8×1.9

# HLKA-M

## Overall Dimension

C: plate connection type (speed control valve can be installed, with G thread plug)

※This figure shows type HLKA-CCM

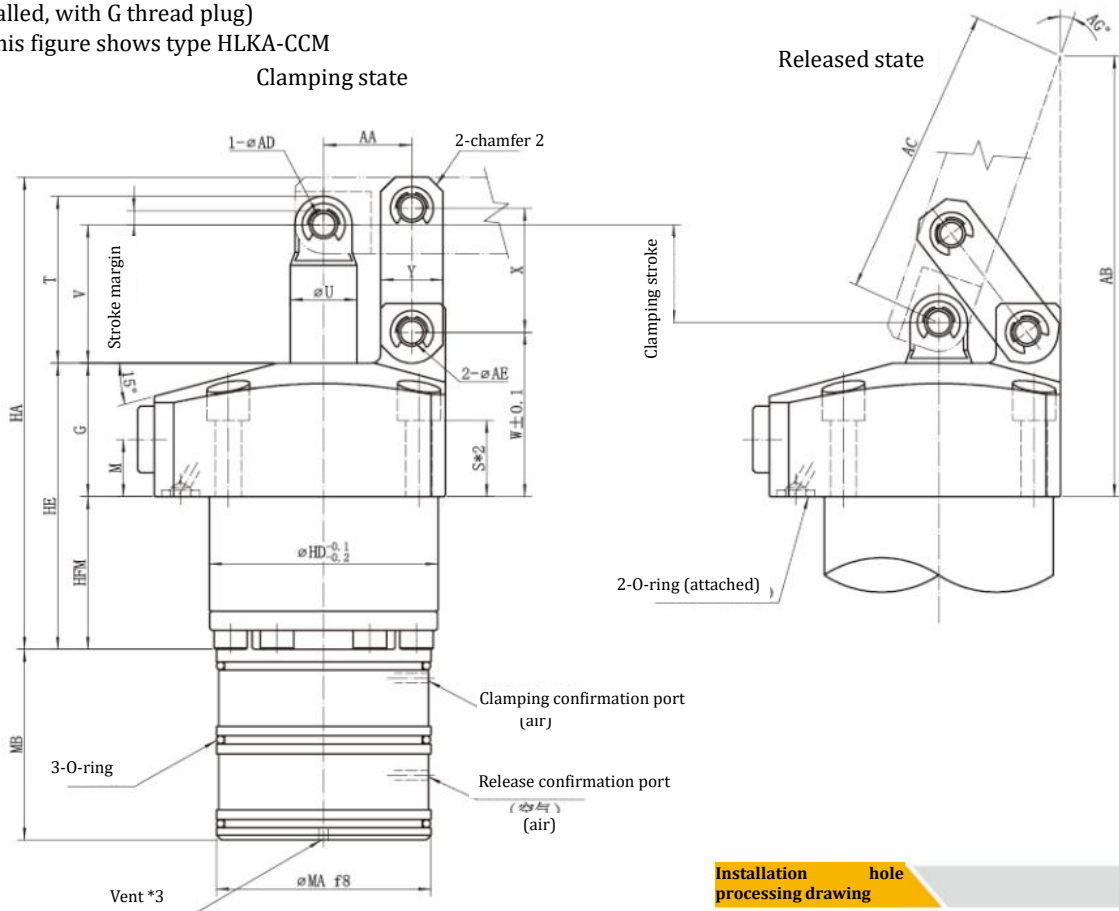

## Installation hole processing drawing

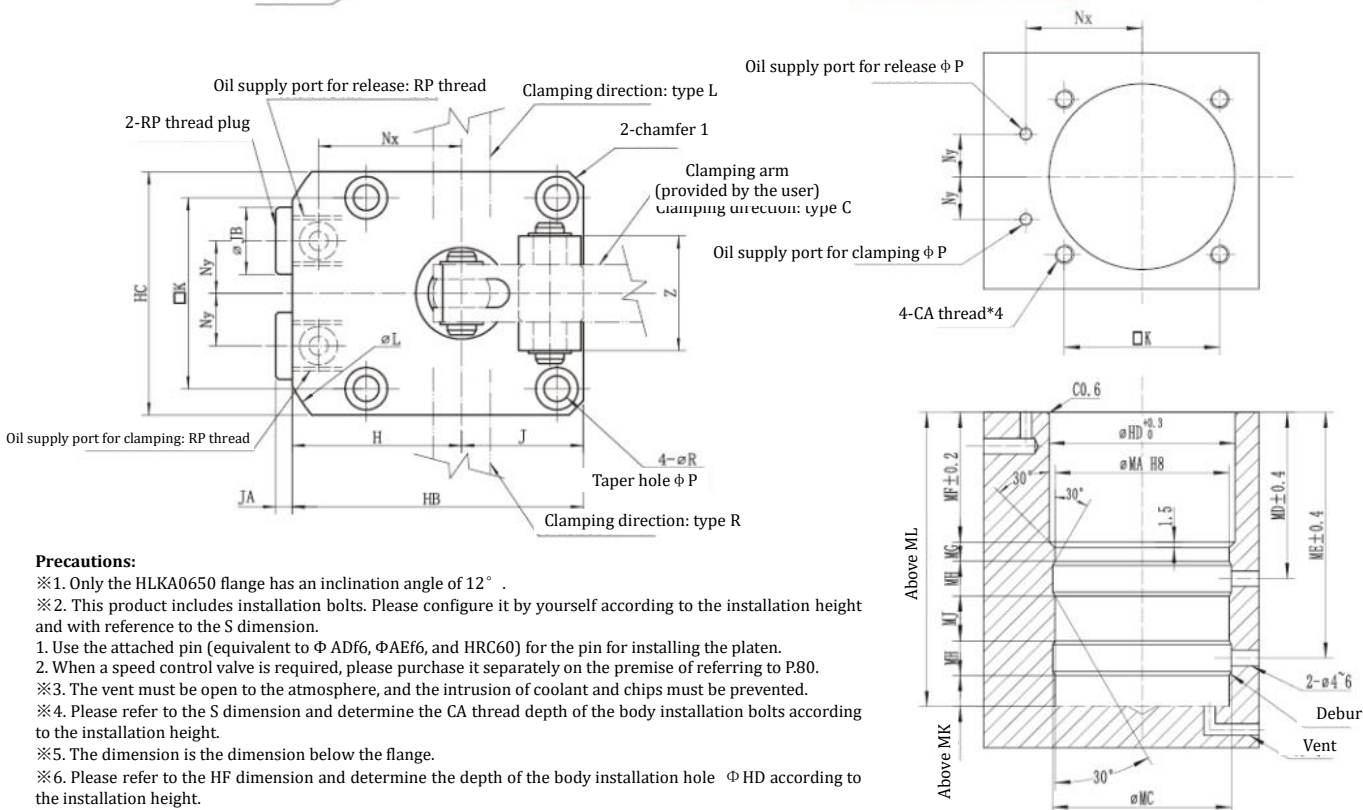

### Precautions:

- ※1. Only the HLKA0650 flange has an inclination angle of 12° .
- ※2. This product includes installation bolts. Please configure it by yourself according to the installation height and with reference to the S dimension.
- 1. Use the attached pin (equivalent to  $\Phi$  ADf6,  $\Phi$  AEf6, and HRC60) for the pin for installing the platen.
- 2. When a speed control valve is required, please purchase it separately on the premise of referring to P.80.
- ※3. The vent must be open to the atmosphere, and the intrusion of coolant and chips must be prevented.
- ※4. Please refer to the S dimension and determine the CA thread depth of the body installation bolts according to the installation height.
- ※5. The dimension is the dimension below the flange.
- ※6. Please refer to the HF dimension and determine the depth of the body installation hole  $\Phi$  HD according to the installation height.

## Model Representation

HLKA ① - ② (Example: 0480-CLM)

① Dimension (refer to specification sheet)

② Action confirmation method (model example: HLKA0550-CCM)

HLKA

0360 0650  
0400 0750  
0480 0900  
0550 1050

M: air sensor plate connection type

## Overall Dimension and Installation Part Processing Dimension Table

Model	HLKA0360-M	HLKA0400-M	HLKA0480-M	HLKA0550-M	HLKA0650-M	HLKA0750-M	HLKA0750-M	HLKA1050-M
Full stroke	18.5	20.5	23.5	26	29.5	35	41	49
Clamping stroke	16	17.5	20.5	23	26.5	32	38	46
Stroke margin	2.5	3	3	2	3	3	3	3
HA	78.6	88.6	100.1	114.1	134.6	153.1	186.1	223.1
HB	49	54	61	69	81	94.5	109.5	127
HC	40	45	51	60	70	85	100	120
HD	36	40	48	55	65	75	90	105
HE	48	55	61	68.5	80.5	86	107	129
HFM	23	30	33	40.5	50.5	49	67	79
G	25	25	28	28	30	37	40	50
H	29	31.5	35.5	39	46	52	59.5	67
J	20	22.5	25.5	30	35	42.5	50	60
K	31.5	34.1	40.1	47.1	55.1	63.1	75.1	88.1
L	66	72	81	88	106	116	136	152
M	11	11	12	12	13	16	16	19
Nx	23.5	26	30	33.5	39.5	45	52.5	60
Ny	8	9	11	12	15	16	18.5	22.5
P	3	3	3	3	5	5	5	5
Q	7.5	9	9	11	11	14	17.5	20
R	4.5	5.5	5.5	6.8	6.8	9	11	14
S	15.5	15	16	13.5	16	17.5	17	23
T	27	30.5	35	37.5	45	55	64.5	77
U	10 f7	12 f7	14 f7	16 f7	20 f7	22 f7	28 f7	35.5 f7
V	22.5	25	29	31.5	37	45	52	62
W	30	30.5	34.5	35.5	39	48	52.5	64
X	20	22	26	30	35.5	43.5	52.5	64
Y	11	13	13	16	19	25	28	32
Z	19	21	24	28	37	40	49	64
Chamfer 1	C2	C3	C3	C3	C4	C10	C11	( $\phi$ 152)
Chamfer 2	C2.5	C3	C3	C3	C5	C5	R16	R18
AA	14.5	16	18.5	21	24.5	30	36	44
AB	74.3	77.7	92.4	101.9	111.4	130.8	146.5	173.6
AC	47.3	50.2	61.2	71.7	78.7	90.8	104.6	122.5
AD	5	6	6	6	8	10	12	15
AE	5	6	6	8	10	12	15	18
AG	19.6	20.2	18.9	19.9	20.5	21.4	22.4	23.1
CA	M4×0.7	M5×0.8	M5×0.8	M6	M6	M8	M10	M12
JA	$3.5_{-0.064}^{-0.025}$	$3.5_{-0.064}^{-0.025}$	$3.5_{-0.064}^{-0.025}$	$3.5_{-0.064}^{-0.025}$	$4.5_{-0.064}^{-0.025}$	$4.5_{-0.076}^{-0.030}$	$4.5_{-0.076}^{-0.030}$	$4.5_{-0.076}^{-0.030}$
JB	$14_0^{+0.030}$	$14_0^{+0.030}$	$14_0^{+0.030}$	$14_0^{+0.030}$	$19_0^{+0.030}$	$19_0^{+0.046}$	$22_0^{+0.046}$	$22_0^{+0.046}$
MAF8	34.5	38	45	45	45	53	53	53
MAH8	34.5	38	45	45	45	53	53	53
MB	31	36	40	40	40	59.5	59.5	59.5
MC	35.7	39.2	46.2	46.2	46.2	54.2	54.2	54.2
MD	32.5	40	43	50.5	60.5	61	79	91
ME	45.5	56.5	63.5	71	81	93.5	111.5	123.5
MF	23.5	30.5	33.5	41	51	49.5	67.5	79.5
MG	4.5	5	5	5	5	5.5	5.5	5.5
MH	9	9	9	9	9	12	12	12
MJ	4	7.5	11.5	11.5	11.5	20.5	20.5	20.5
MK	6	7	7	7	7	11	11	11
ML	56	68	75	82.5	92.5	110.5	128.5	140.5
Oil supply port for clamping/release	Type -C RP1/8	RP1/8	RP1/8	RP1/8	RP1/4	RP1/4	RP3/8	RP3/8
O-seal ring	4.8×1.9	4.8×1.9	4.8×1.9	4.8×1.9	6.8×1.9	6.8×1.9	6.8×1.9	6.8×1.9
3-O-seal ring	29.87×1.78(70°)	34.65×1.78(70°)	41.00×1.78(70°)	41.00×1.78(70°)	41.00×1.78(70°)	47.35×1.78(70°)	47.35×1.78(70°)	47.35×1.78(70°)

### Overall Dimension

C: plate connection type (speed control valve can be installed, with G thread plug)

※This figure shows type HLKA-CCN

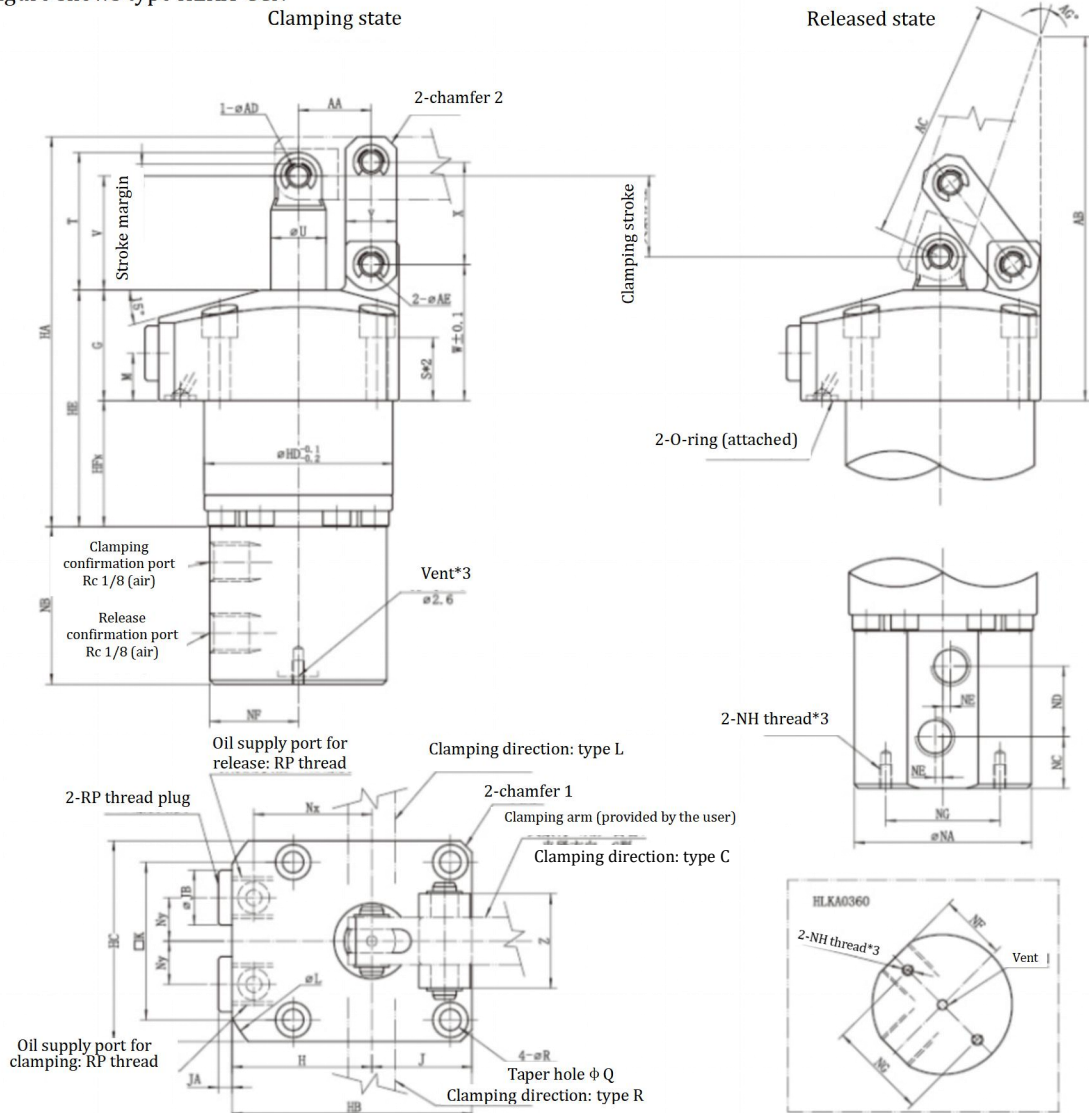

### Installation Hole Processing Drawing

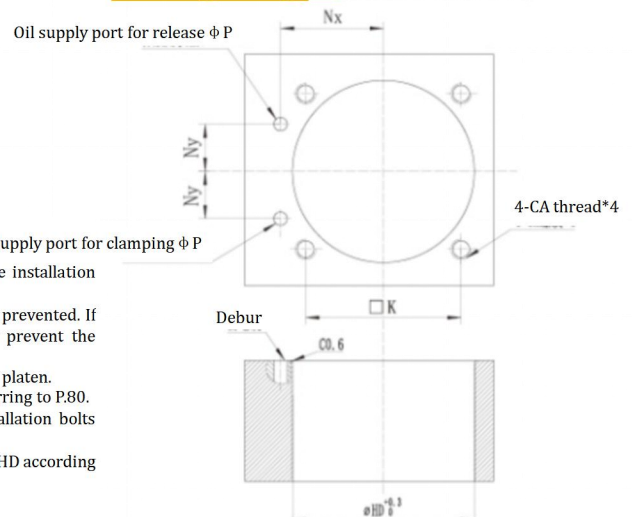

#### Precautions:

- ※1. Only the HLKA0650 flange has an inclination angle of 12°.
- ※2. This product includes installation bolts. Please configure it by yourself according to the installation height and with reference to the S dimension.
- ※3. The vent must be open to the atmosphere, and the intrusion of coolant and chips must be prevented. If the coolant splashes directly, please set a cushion block on the NH thread to effectively prevent the intrusion of coolant and ensure that the exhaust hole is not blocked.
- 1. Use the attached pin (equivalent to  $\phi ADf6$ ,  $\phi AEf6$ , and HRC60) for the pin for installing the platen.
- 2. When a speed control valve is required, please purchase it separately on the premise of referring to P.80.
- ※4. Please refer to the S dimension and determine the CA thread depth of the body installation bolts according to the installation height.
- ※5. Please refer to the HF dimension and determine the depth of the body installation hole  $\phi HD$  according to the installation height.



## Model Representation

HLKA ① - ② (Example: 0480-CLN)

① Dimension (refer to specification sheet)

② Action confirmation method (model example: HLKA0550-CCN)

HLKA

0360 0650  
0400 0750  
0480 0900  
0550 1050

N: external air sensor piping type

## Overall Dimension and Installation Part Processing Dimension Table

Model	HLKA0360-N	HLKA0400-N	HLKA0480-N	HLKA0550-N	HLKA0650-N	HLKA0750-N	HLKA0900-N	HLKA1050-N
Full stroke	18.5	20.5	23.5	26	29.5	35	41	49
Clamping stroke	16	17.5	20.5	23	26.5	32	38	46
Stroke margin	2.5	3	3	3	3	3	3	3
HA	78.6	88.6	100.1	114.1	134.6	153.1	186.1	223.1
HB	49	54	61	69	81	94.5	109.5	127
HC	40	45	51	60	70	85	100	120
HD	36	40	48	55	65	75	90	105
HE	48	55	61	68.5	80.5	86	107	129
HF <sub>u</sub>	23	30	33	40.5	50.5	49	67	79
G	25	25	28	28	30	37	40	50
H	29	31.5	35.5	39	46	52	59.5	67
J	20	22.5	25.5	30	35	42.5	50	60
K	31.5	34.1	40.1	47.1	55.1	63.1	75.1	88.1
L	66	72	81	88	106	116	136	152
M	11	11	12	12	13	16	16	19
NX	23.5	26	30	33.5	39.5	45	52.5	60
NY	8	9	11	12	15	16	18.5	22.5
P	3	3	3	3	5	5	5	5
Q	7.5	9	9	11	11	14	17.5	20
R	4.5	5.5	5.5	6.8	6.8	9	11	14
S	15.5	15	16	13.5	16	17.5	17	23
T	27	30.5	35	37.5	45	55	64.5	77
U	10 f7	12 f7	14 f7	16 f7	20 f7	22 f7	28 f7	35.5 f7
V	22.5	25	29	31.5	37	45	52	62
W	30	30.5	34.5	35.5	39	48	52.5	64
X	20	22	26	30	35.5	43.5	52.5	64
Y	11	13	13	16	19	25	28	32
Z	19	21	24	28	37	40	49	64
Chamber 1	C2	C3	C3	C3	C4	C10	C11	(Φ152)
Chamber 2	C2.5	C3	C3	C3	C5	C5	R16	R18
AA	14.5	16	18.5	21	24.5	30	36	44
AB	74.3	77.7	92.4	101.9	111.4	130.8	146.5	173.6
AC	47.3	50.2	61.2	71.7	78.7	90.8	104.6	122.5
AD	5	6	6	6	8	10	12	15
AE	5	6	6	8	10	12	15	18
AG	19.6	20.2	18.9	19.9	20.5	21.4	22.4	23.1
CA	M4X0.7	M5X0.8	M5M.08	M6	M6	M8	M10	M12
JA	3.5	3.5	3.5	3.5	4.5	4.5	4.5	4.5
JB	14	14	14	14	19	19	22	22
NA	35.5	39.5	45	45	45	53	53	53
NB	31	36	40	40	40	59.5	59.5	59.5
NC	9	8.5	12	12	12	20	20	20
ND	12.5	17.5	18	18	18	29.5	29.5	29.5
NE	-	1	2	2	2	3	3	3
NF	17	18.5	20	20	20	24	24	24
NG	25	29	29	29	29	38	38	38
NH (name & depth)	M3X0.5X6	M3X0.5X6	M3X0.5X6	M3X0.5X6	M3X0.5X6	M4X0.7X0.7	M4X0.7X0.7	M4X0.7X0.7
Oil supply port for clamping & draw Type -BP	RP1/8	RP1/8	RP1/8	RP1/8	RP1/4	RP1/4	RP3/8	RP3/8
O-seal ring	4.8×1.9	4.8×1.9	4.8×1.9	4.8×1.9	6.8×1.9	6.8×1.9	6.8×1.9	6.8×1.9