



User Guide

Smart Wi-Fi Light Switch

Contents

About This Guide	1
Set Up Your Switch	2
Main Device Controls	3
Manage Device Settings	6
Smart Actions	10
Me Page	13

About This Guide

This guide provides a brief introduction to the Smart Switch and regulatory information.

Please note that features available in Tapo may vary by model and software version. Tapo availability may also vary by region. All images, steps, and descriptions in this guide are only examples and may not reflect your actual Tapo experience.

Conventions

In this guide, the following convention is used:

Convention	Description
Blue	Key information appears in blue, including management page text such as menus, items, buttons and so on.
<u>Underline</u>	Hyperlinks are in blue and underlined. You can click to redirect to a website.
📌Note:	Ignoring this type of note might result in a malfunction or damage to the device.

More Info

- Specifications can be found on the product page at <https://www.tapo.com>.
- Our Technical Support and troubleshooting information can be found at <https://www.tapo.com/support/>.

Set Up Your Switch

Follow the steps below to set up your switch.

Step 1. Download Tapo App

Get the [Tapo](#) app from the App Store or Google Play, or by scanning the QR code below.



OR



Step 2. Log In

Open the app, and log in with your TP-Link ID. If you don't have an account, create one first.

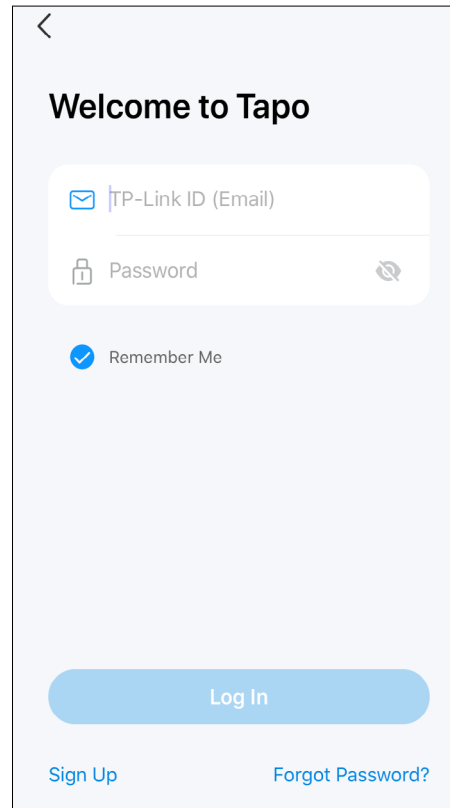

Step 3. Add Your Switch

Tap the \oplus button in the app and select your switch. Then follow app instructions to set up your switch.

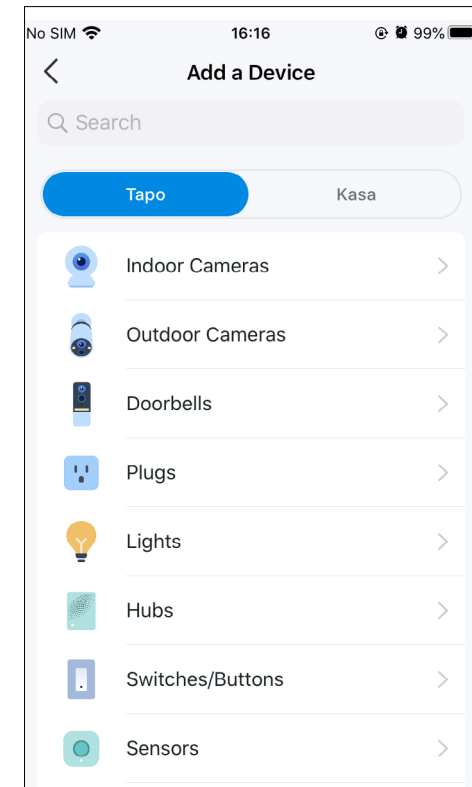

Main Device Controls

After you successfully set up your Smart Switch, you will see the home page of the Tapo app. Here you can view and manage all devices that you've added to Tapo. Tap your smart switch to control and manage it.

Home Page

Turn on/off your device on the Home page.

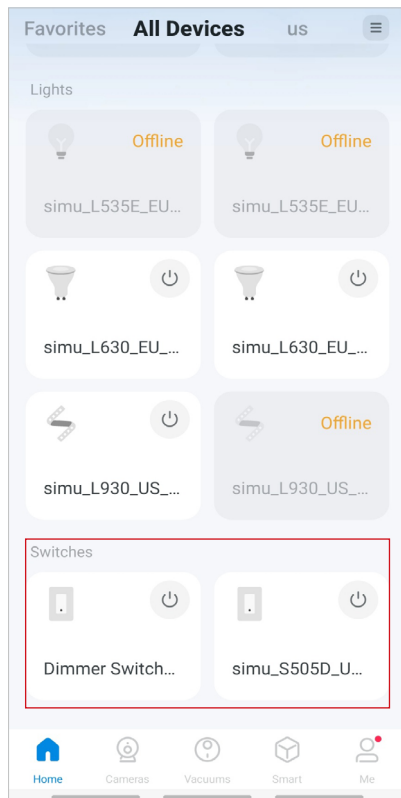

Status Page

Turn on/off your device, or set schedules, timer, Away Mode or check runtime on the Status page. If your Smart Switch is a dimmer switch, you can also change light brightness and check preset brightness.

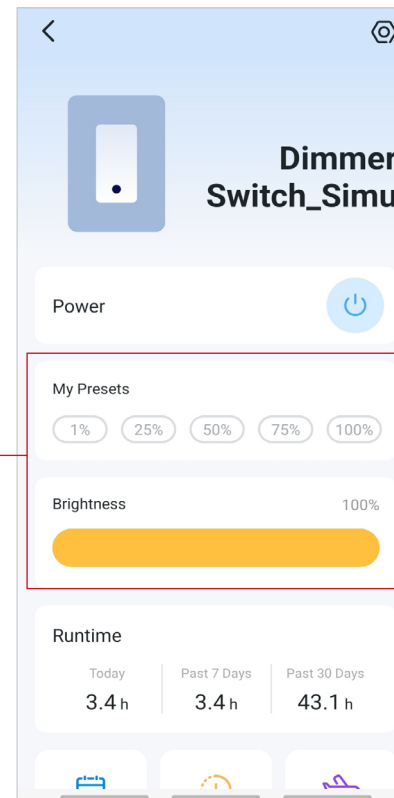

Only supported by dimmer switches.

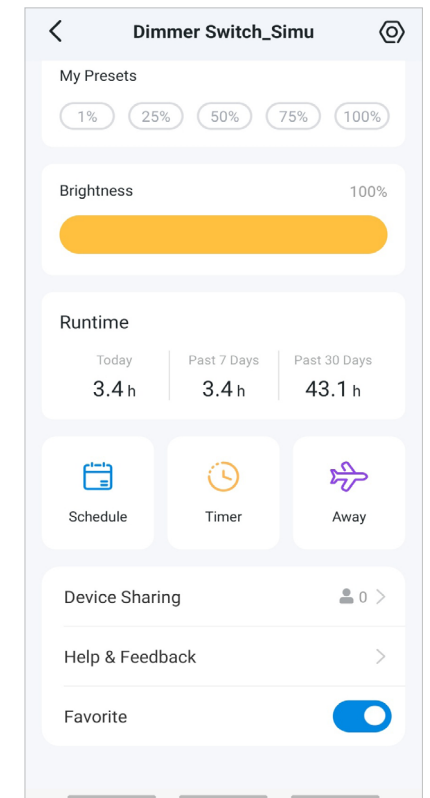

Check Runtime

Keep track of how long your Smart Switch has been working today, for the past 7 days, or for the past 30 days.

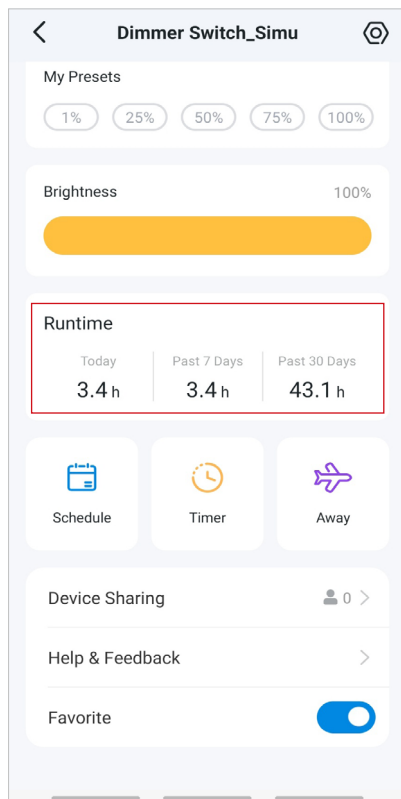

Set Schedules

Automatically turn on/off the light at set times according to your daily routine.

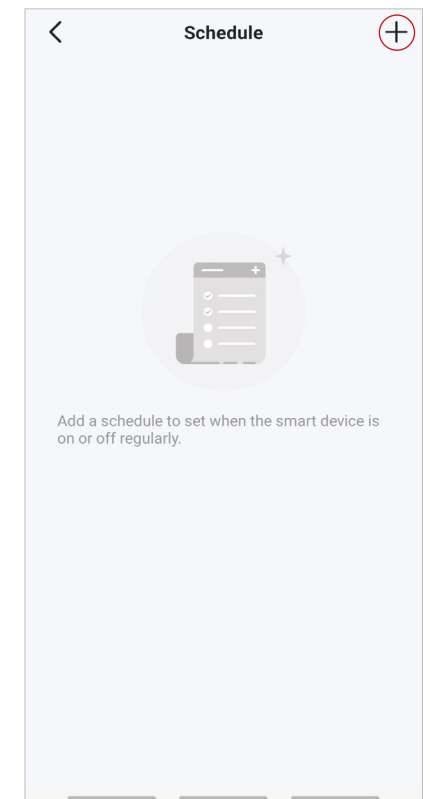
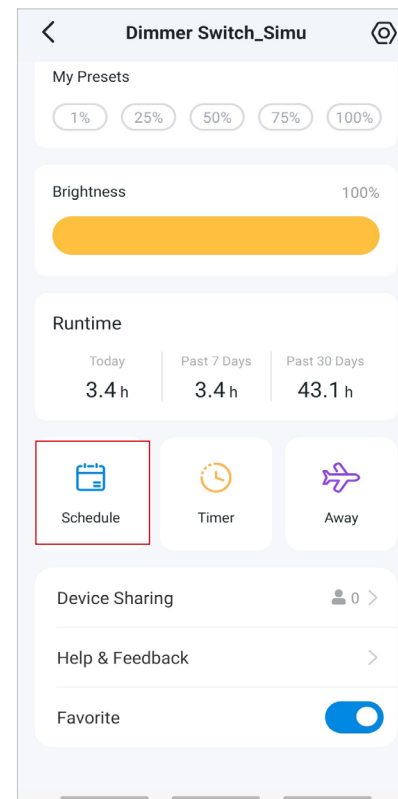

Set a Timer

Automatically turn on/off after the time ends.

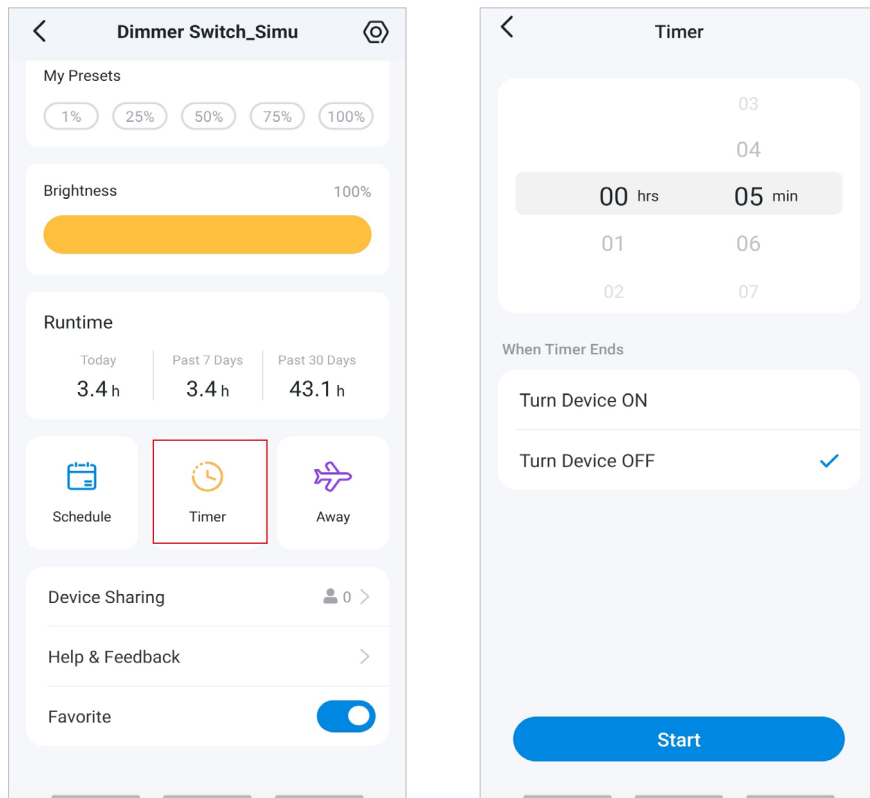

Set Away Mode

Turn on/off the light automatically at random intervals while you are away to make the appearance that someone is at home.

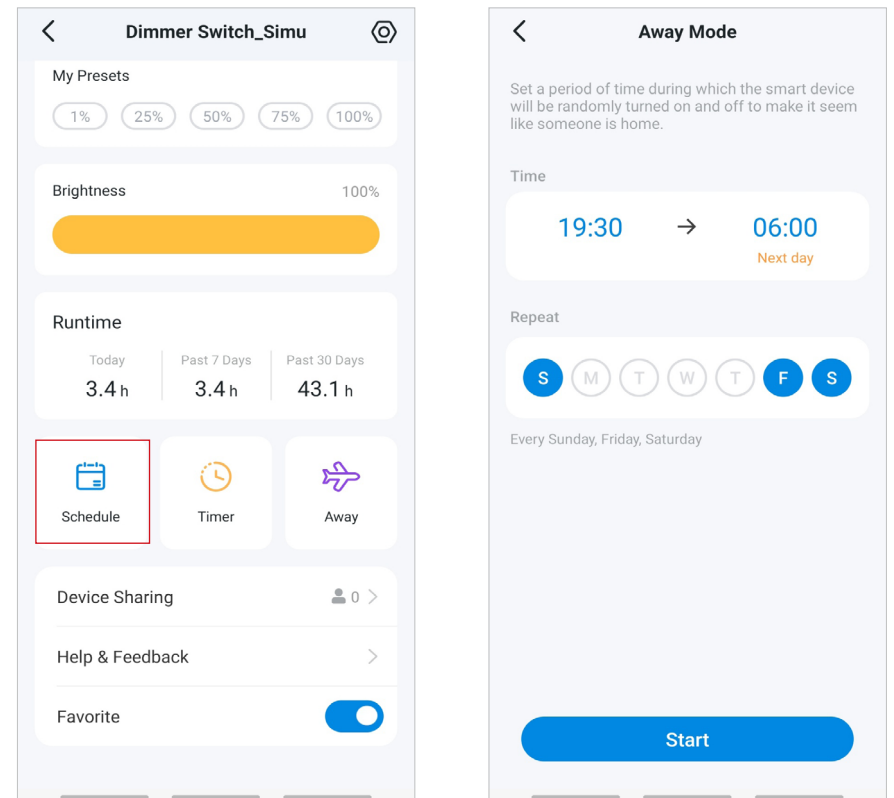

Manage Device Settings

You can change the name and icon of your Smart Switch and check its device info.

Tap  on the Status Page to enter the [Device Settings](#) page.

1. [Set light brightness presets.](#)
(*Only supported by dimmer switches.)

Set preset brightness levels so you can switch to the desired brightness with just one tap. The presets will appear on the Status page of the light.

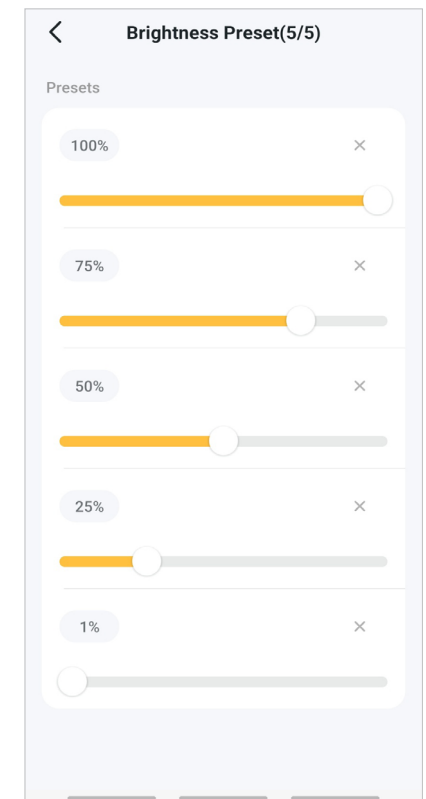
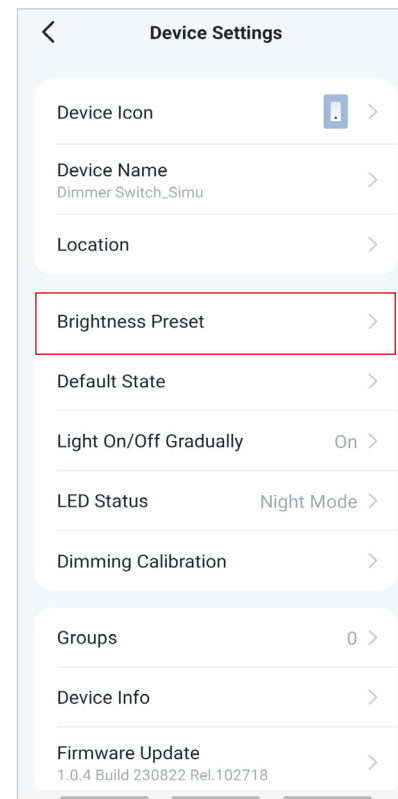
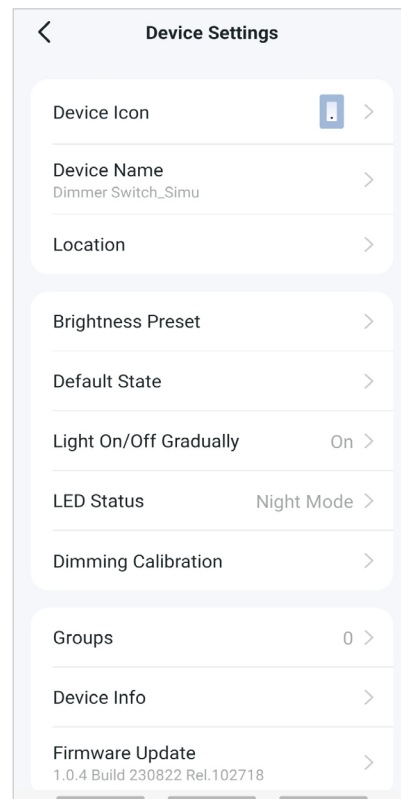
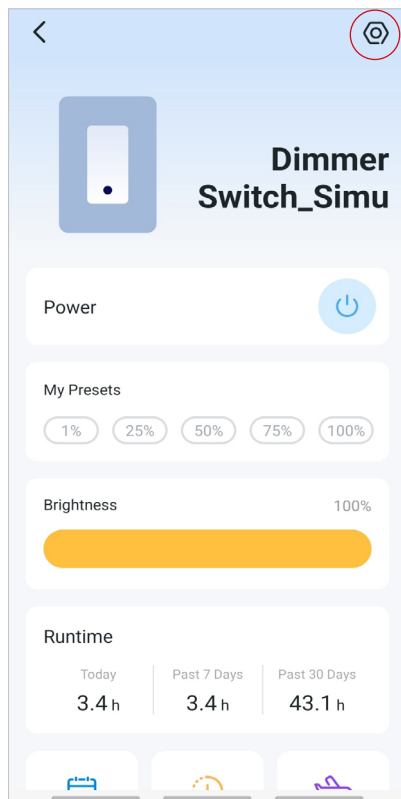

2. Set default state.

Set the default state your Smart Switch will turn to when it is turned on from the app or the power source.

*The default state options may vary for different models.

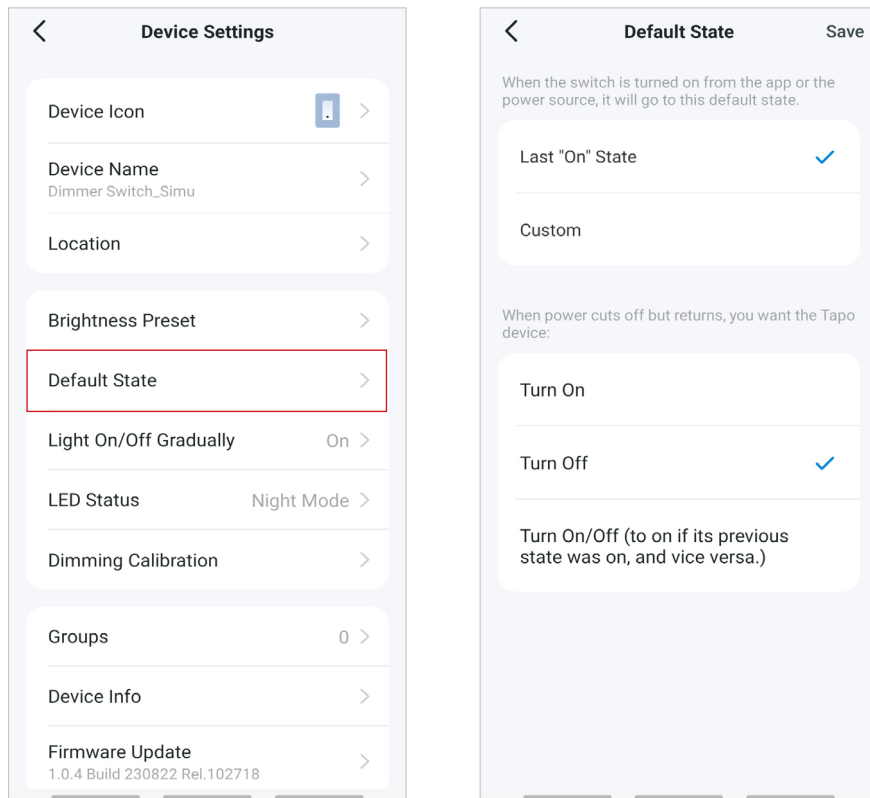

3. Set light to turn on/off gradually.

(*Only supported by dimmer switches.)

Set the duration for the light to turn on or off gradually.

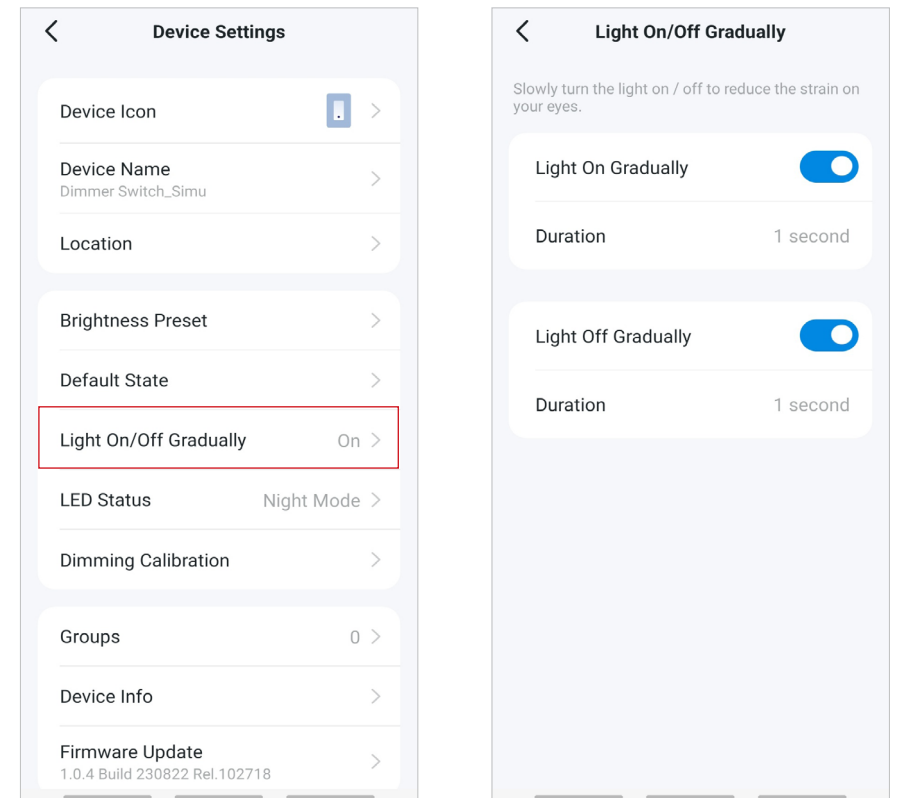

4. Control your device LED.

Set when the LED is on or off.

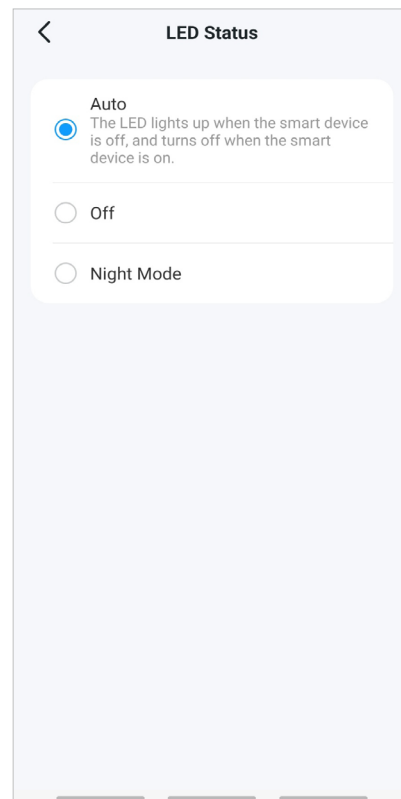
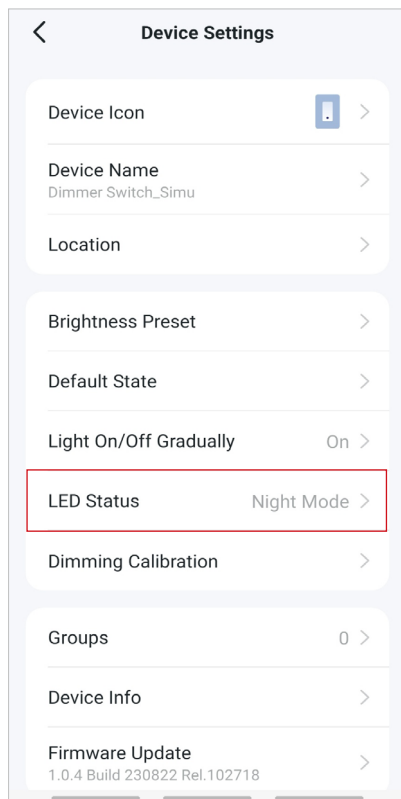

5. Calibrate your device.

(*Only supported by dimmer switches.)

Calibrate your device to dim your light smoothly.

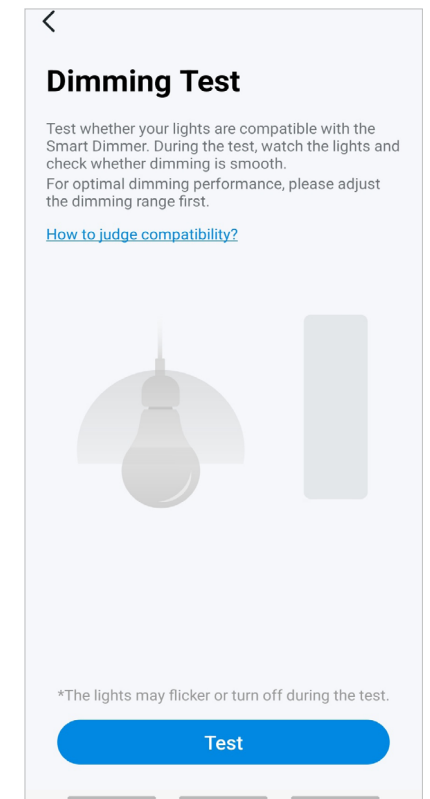
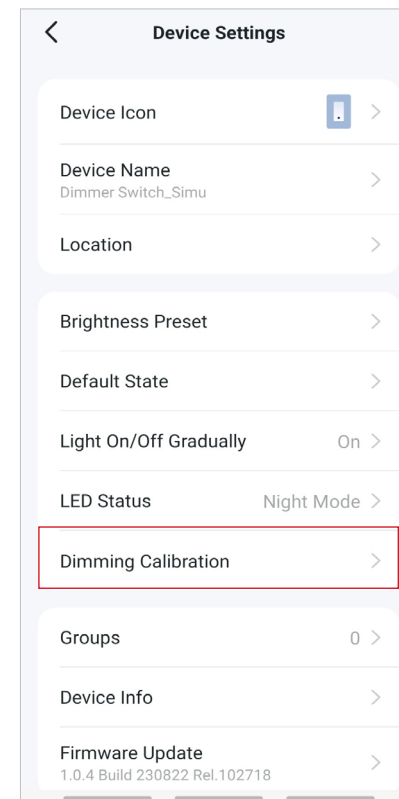

6. Check device info.

If your device supports Matter, you can find the Matter setup code here to add it the first Matter ecosystem.

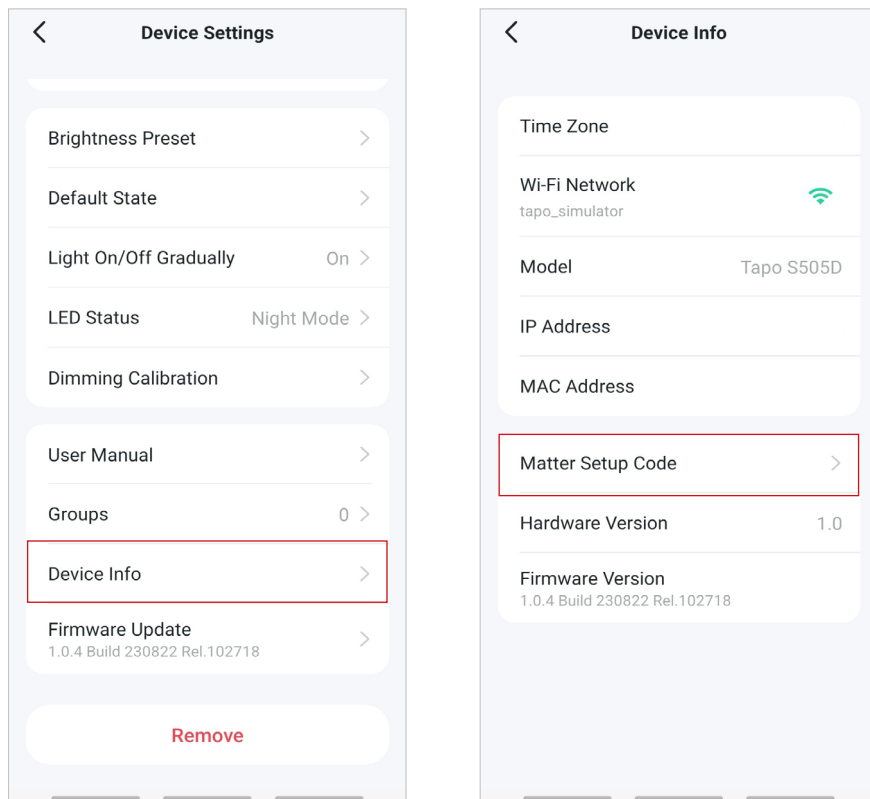

Smart Actions

Smart Actions automate repetitive tasks, allowing you to blaze through tedium with utmost ease. Set everything up once and never have to worry about it again. With Smart Actions, giving your home that level of intelligence is a snap. Shortcut lets you perform an action with a simple tap. Automation allows you to automate tasks to be performed at a set time. e.g. Turn on the lights when your camera detects motion.

Option 1: Edit based on the routine actions

1. Open the Tapo app, tap **Smart** on the bottom to enter the smart actions page.

2. Under **Routine Actions**, tap an action. Tap **Edit** to change the settings as needed and tap **Apply** to save changes.

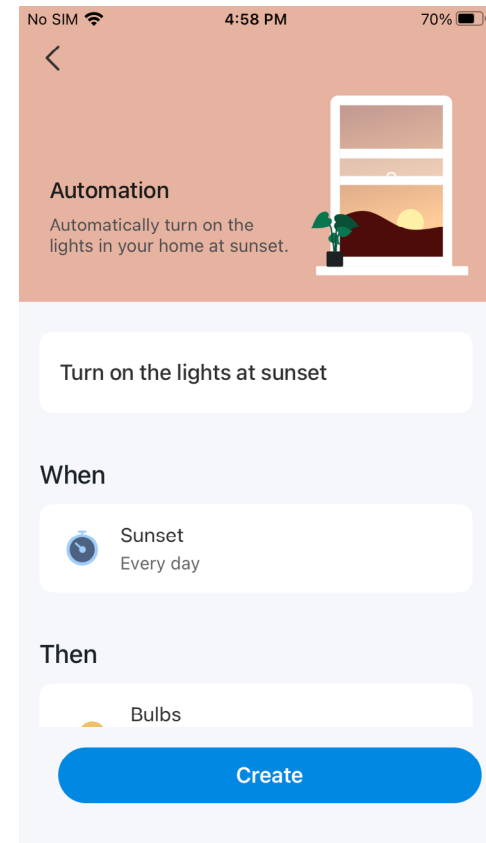
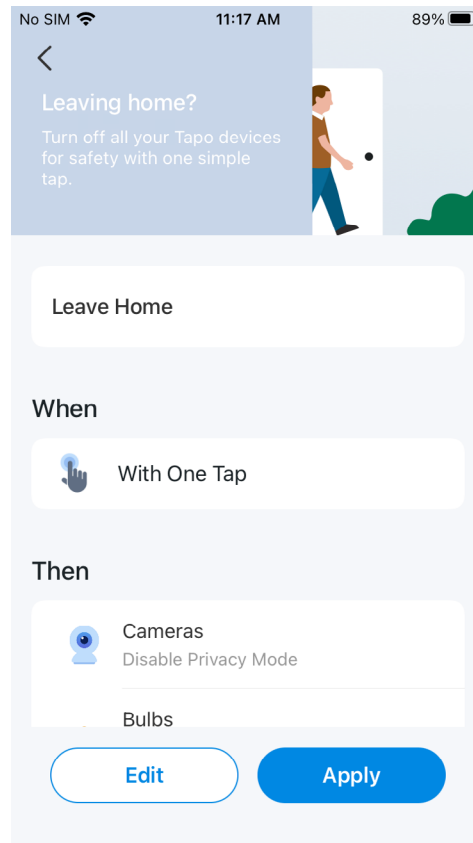
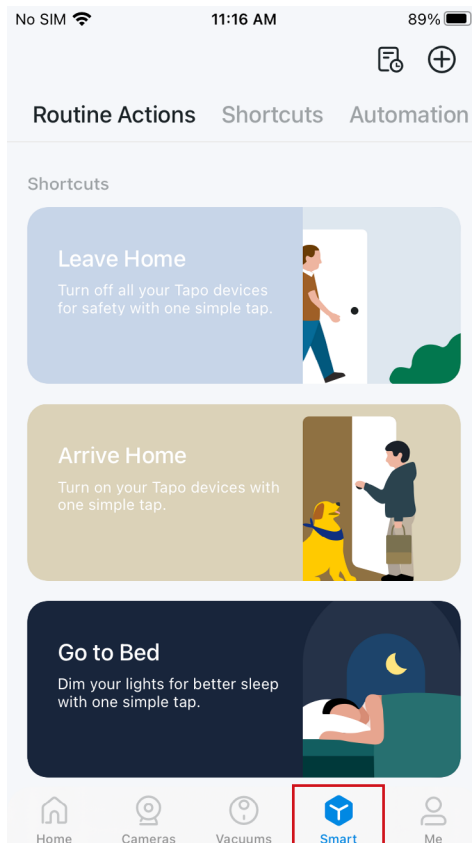

Option 2: Create your own shortcuts

1. Under **Shortcuts**, tap + on the top right to add a simple and smart action.

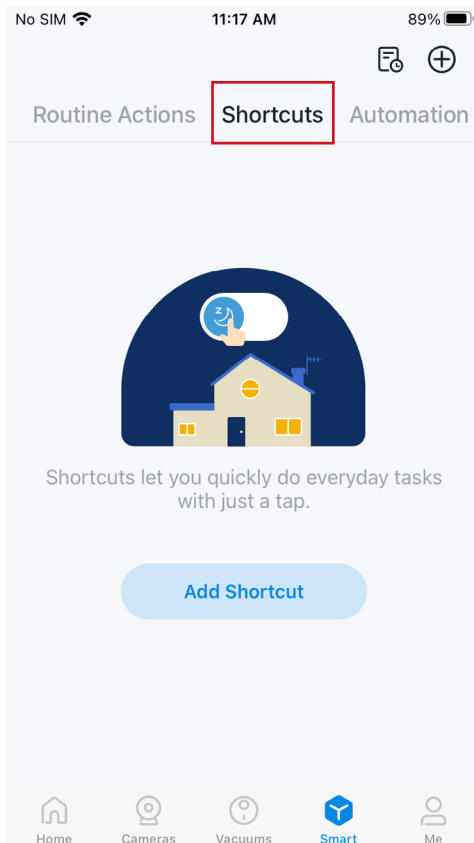

2. Add an action and choose whether to delay the action.

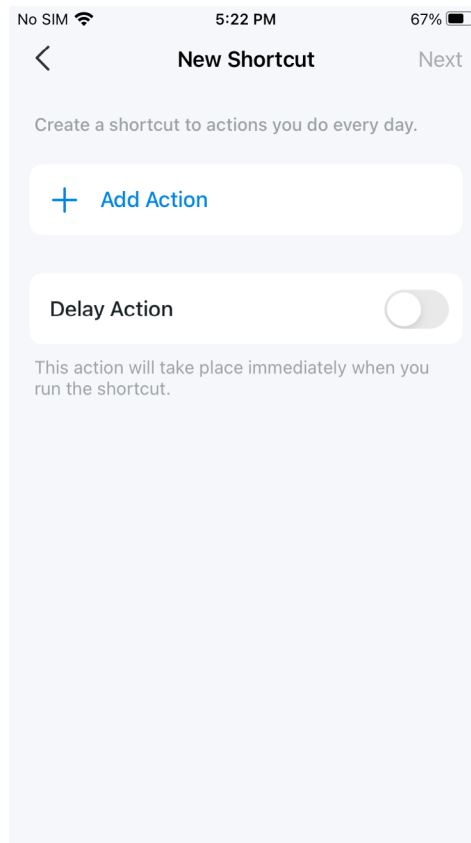

3. Name your shortcut and choose an icon. Tap **Done** to save all the settings.

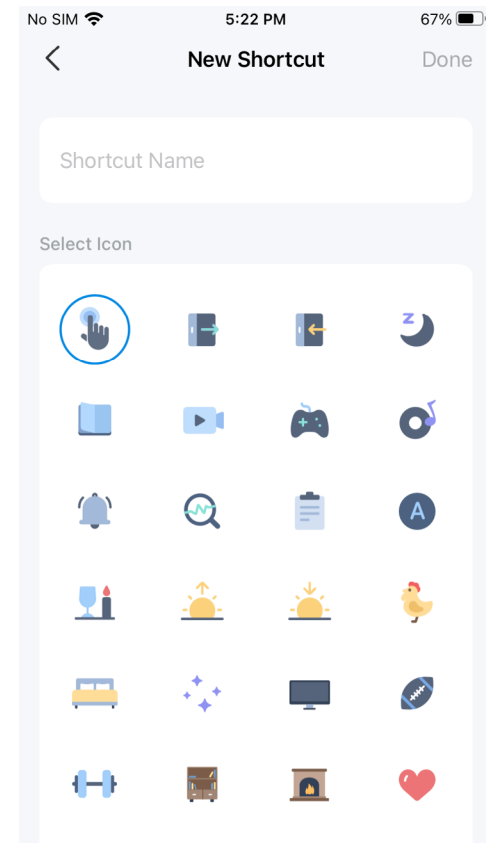

Option 3: Create your own actions

1. Under **Automation**, tap + on the top right to add a simple and smart action.

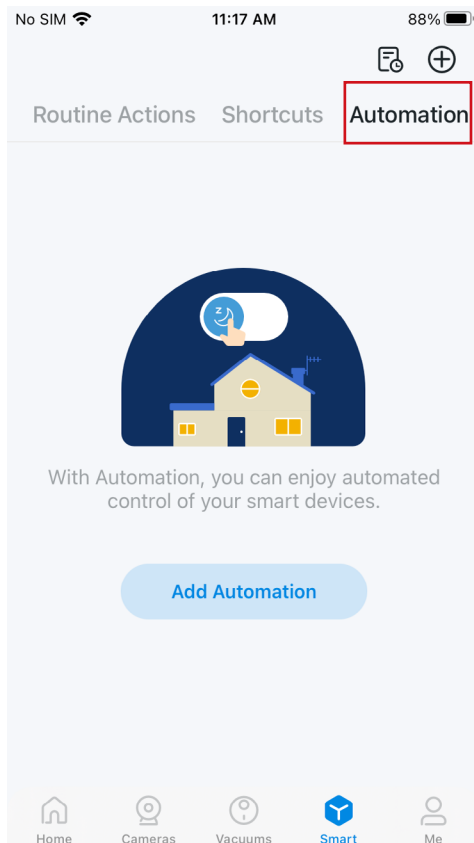

2. Name the new action. Tap + to add conditions (**When**) like the trigger time, and tap + to add tasks (**Then**) like turning on the switch.

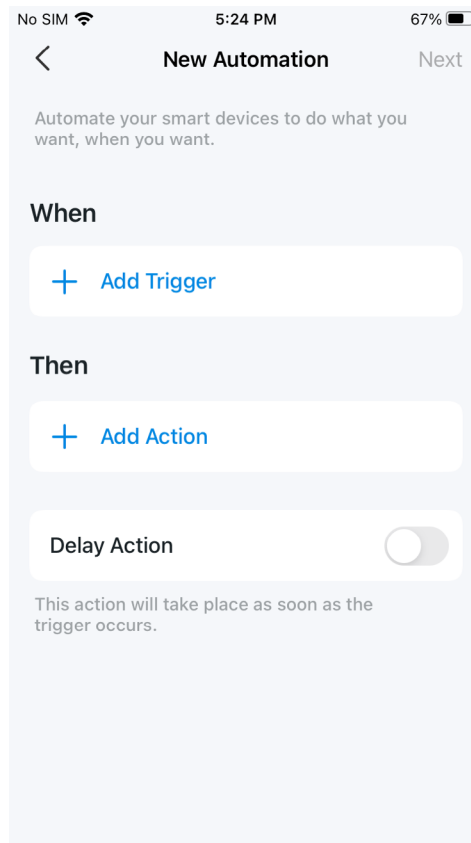

3. Name your automation and set the effective time for the automation. Tap **Done** to save all the settings.

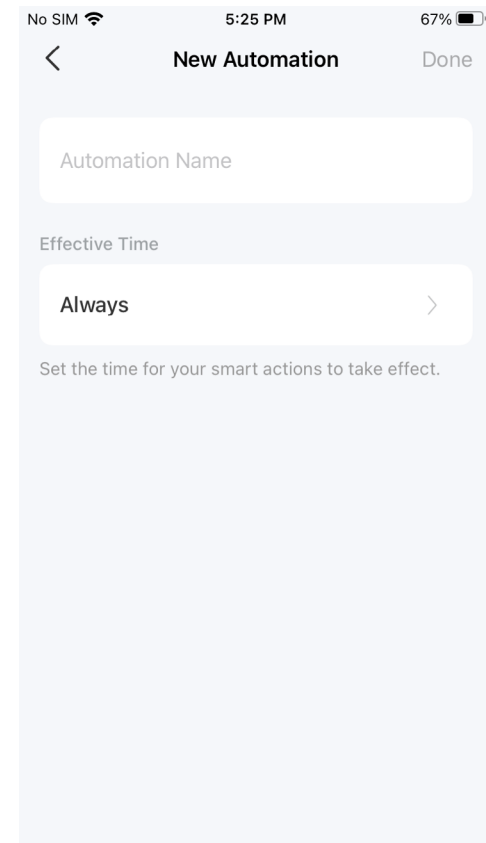

Me Page

The Tapo app offers a list of advanced features to fulfill diverse smart home needs.

Manage Your Account

Open the Tapo app, tap **Me** on the bottom to enter the page. Then you can tap your avatar or account to change the avatar, name, password, and login security.

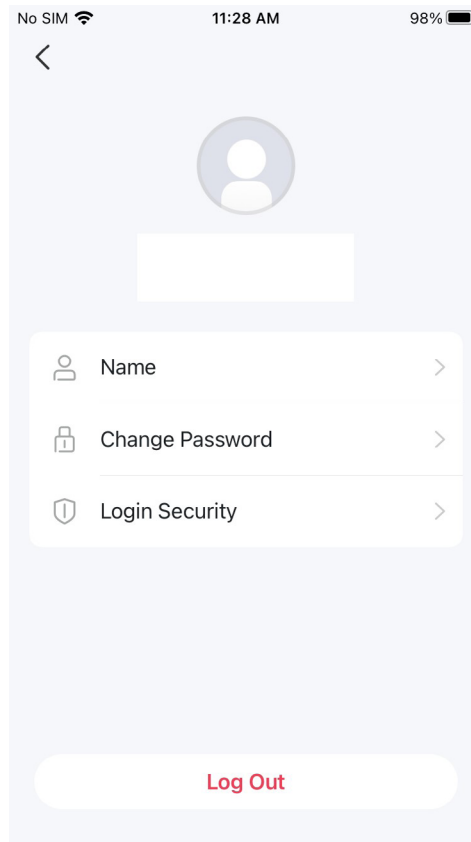
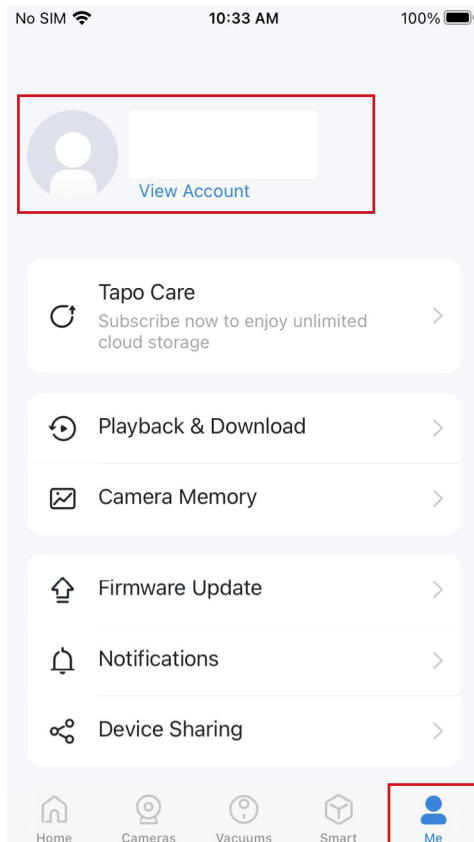

Tapo Care

Tapo Care is a comprehensive service with unlimited cloud storage. You can subscribe to the advanced plan for your Tapo cameras.

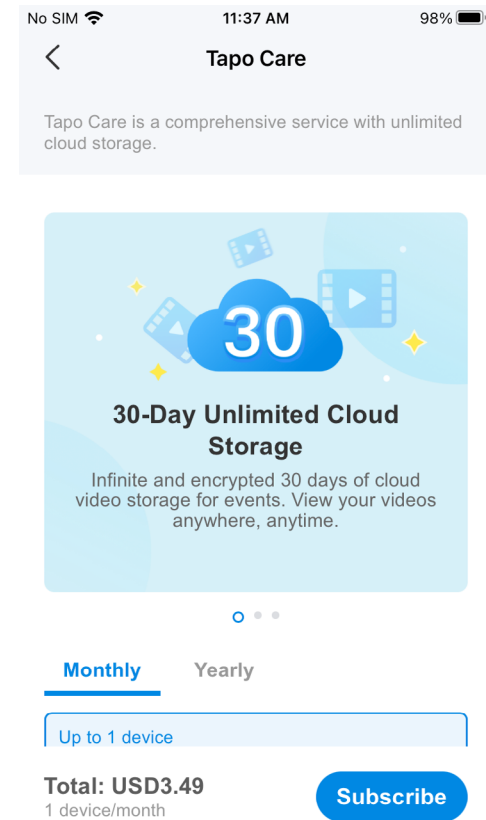

Playback & Download

You can tap any of your Tapo cameras to enter the camera's Playback & Download page. If you tap [Upgrade Now](#), the Tapo Care page appears.

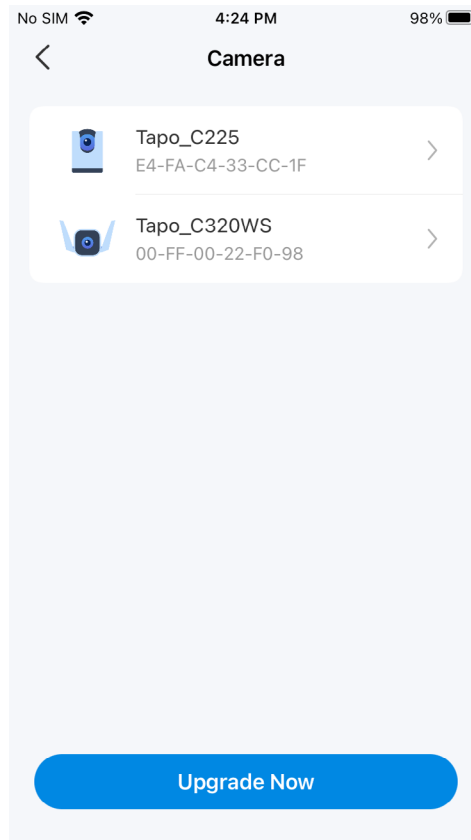
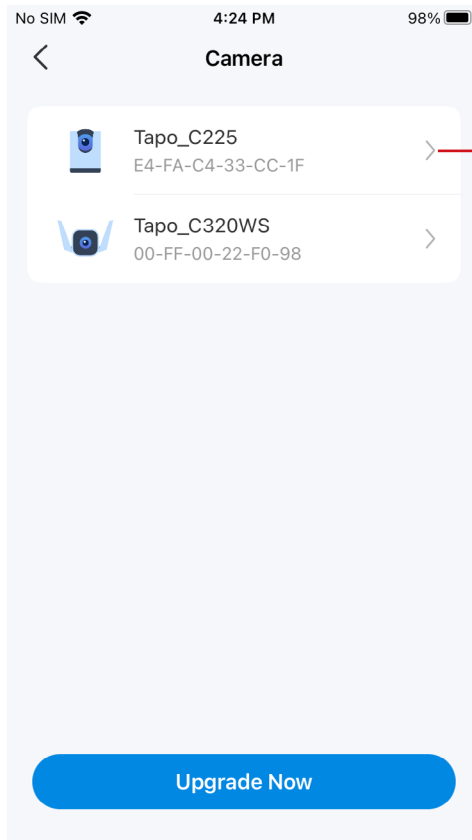

Camera Memory

All saved recordings appear in Memory. You can tap the  icon to manage and filter the recordings.

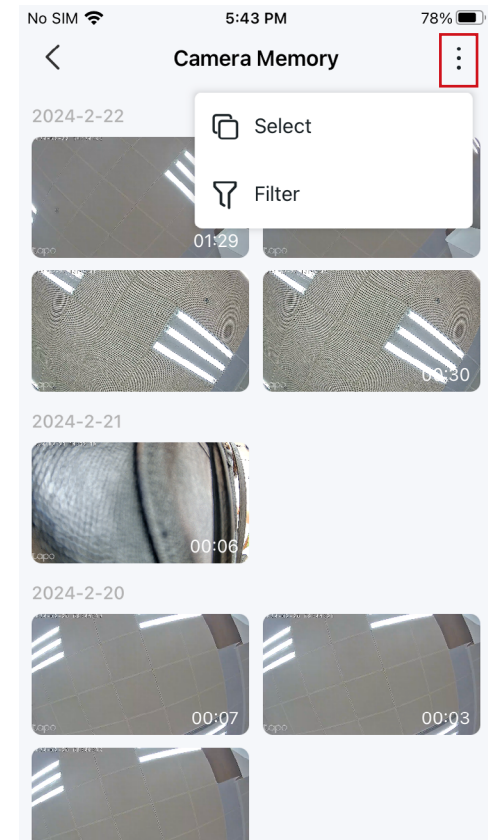

Firmware Update

Tap to check if any firmware updates are available on this page and update your devices as instructed.

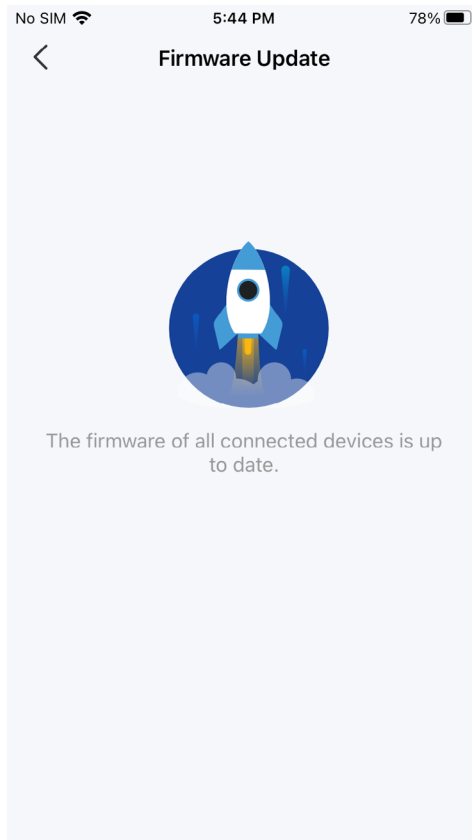

Notifications

Turn on Notifications to allow Tapo to show alerts on the Lock Screen, Banners, and Notification Center as needed.

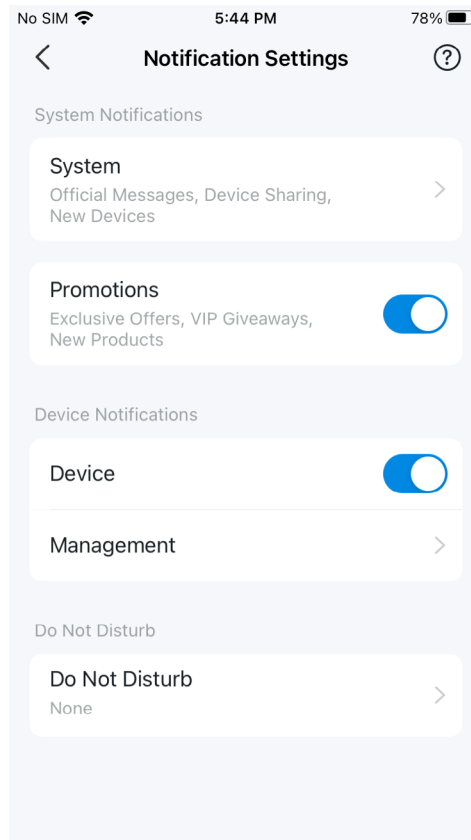

Device Sharing

Share your Tapo device with your families and check the devices shared by others. Tap the  icon to add a bothering inviter to the Deny List.

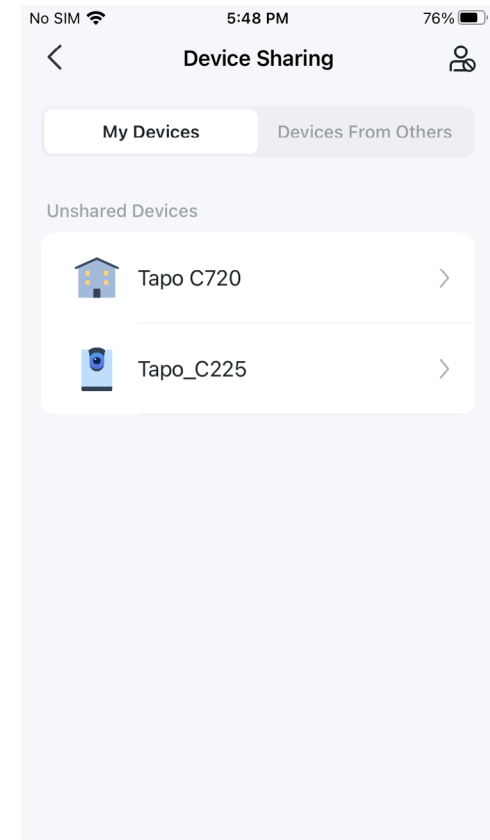

Link Tapo with Kasa

You can link Tapo with Kasa to Manage Devices, Groups, and Smart Actions. Tap [Authorize Now](#) to allow Tapo to access Kasa.

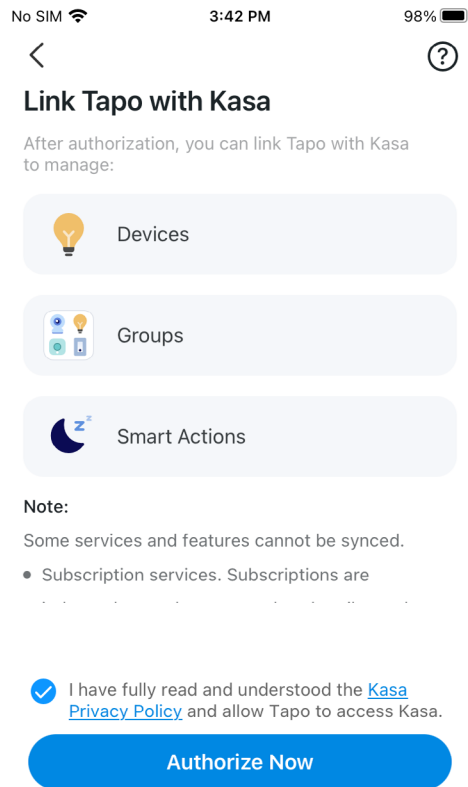

Widgets

With Widgets, you can conveniently control your smart device from the home screen on Android devices or the Today View on iOS devices.

Note: For detailed instructions, please refer to <https://www.tp-link.com/support/faq/3313/>.

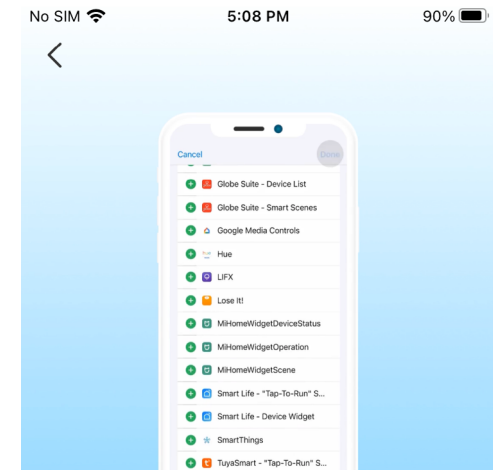
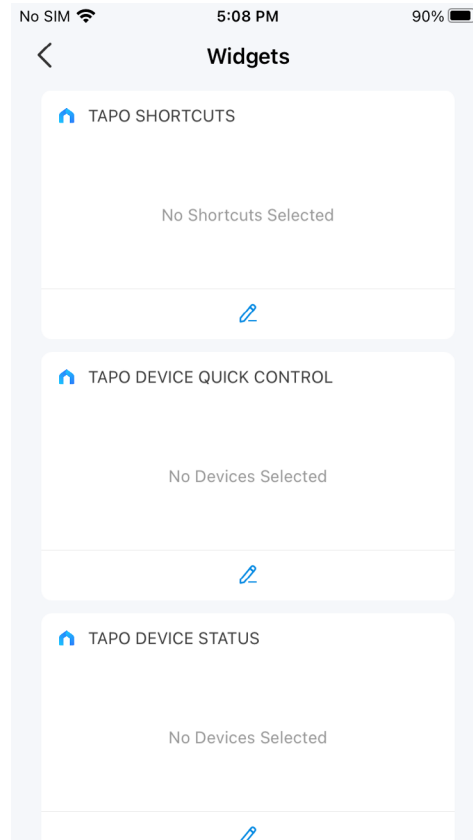

How to use Widgets

With widgets, you can conveniently control your smart devices from the Today View on your iPhone, iPad or iPod touch.

1. Swipe right over the Home screen or Lock screen of your iPhone, iPad or iPod touch. You can see your widgets in the Today View.
2. Scroll to the bottom and tap "Edit". For iOS 14 and above, tap "Customize" at the bottom to continue.
3. Tap "+" to add Tapo widgets.
4. Tap "Done" to finish.

Note: If the widgets disappear due to the iOS

Third-Party Services

You can control your smart devices through third-party services, including voice control.

Amazon Alexa

Follow the guide <https://www.tp-link.com/hk/support/faq/2780/>.

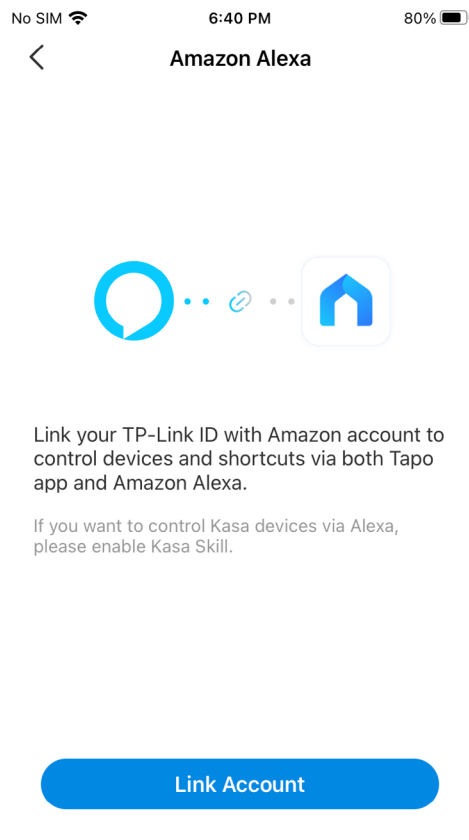
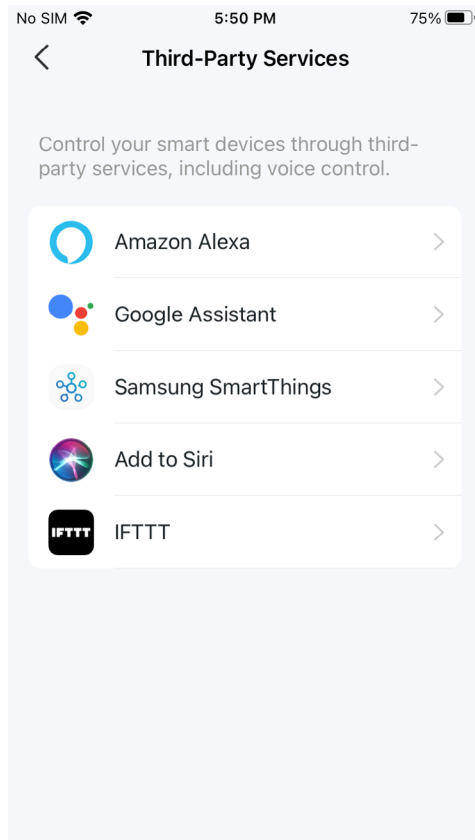

Google Assistant

Follow the guide <https://www.tp-link.com/hk/support/faq/2779/>.

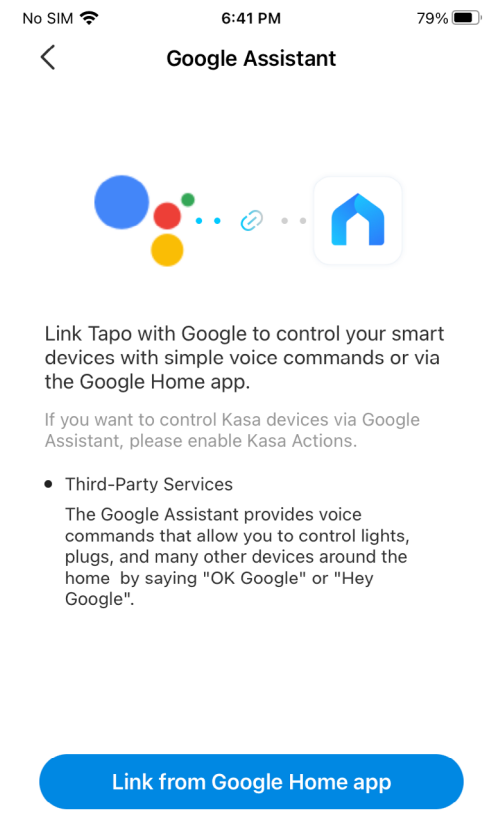

Third-Party Services

You can control your smart devices through third-party services, including voice control.

Samsung SmartThings / Add to Siri / IFTTT

You can tap the one as needed, then follow the detailed instructions on the Tapo to complete the connection. Add to Siri is for iOS devices only.

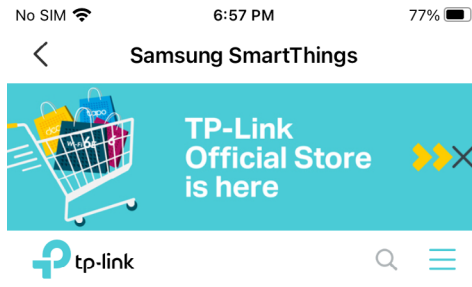

How to Configure Tapo Devices to Work with Samsung SmartThings

Configuration Guide

Updated 07-21-2023 20:58:58 PM

👁 272431

This Article Applies to: ♥

This article will introduce how to connect Tapo devices to your Samsung SmartThings app. After setting up the connection successfully, you will be able to control Tapo devices through your SmartThings app.

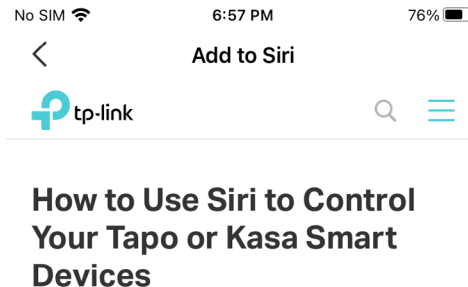

Configuration Guide

Updated 02-27-2024 09:12:53 AM

👁 325666

This Article Applies to: ♥

With the Shortcuts App in iOS 12 or above, you can use Siri to control your Tapo/Kasa smart devices — all with just a tap or by asking Siri. It's easy to create a new, custom shortcut using the Shortcuts app for iPhone or iPad. This article takes Tapo as an example to introduce how to implement this feature.

Before You Start:



Ensure your Tapo device is set up successfully and can connect to the internet.

