



Quick Start Guide

Smart Remote Dimmer Switch

 **Setup Video**
 Scan QR code or visit
<https://www.tp-link.com/support/setup-video/#home-smart-switches>



! Before You Start

A Tapo Hub is required. Make sure your Tapo Hub is successfully added via the Tapo app.



1 Power Up Your Button

Remove the battery insulation tab to power up your button. The LED should blink.

Note: If the LED is not blinking, refer to the reverse side for reset instructions.

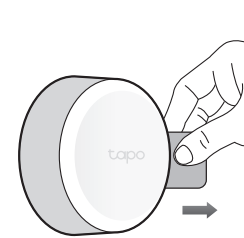

2 Set Up Your Button

Open the Tapo app and tap the ⊕ button. Select **Switches/Buttons** and then your model. Follow the app instructions to complete setup.

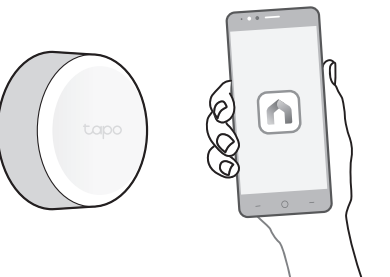

3 Test Your Button

- Press the button to test it in your preferred location.
- Refresh the home page on the Tapo app to confirm its status.

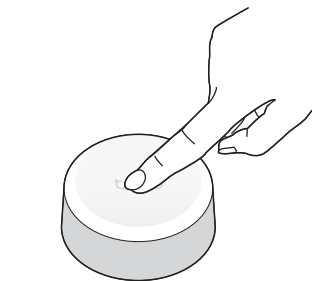

4 Secure Your Wallplate

The installation height of the wallplate should not be higher than 6.56 ft (2 m).

Option 1: Use Adhesives Provided

Stick the included adhesives to the back panel and stick the wallplate to your preferred location.

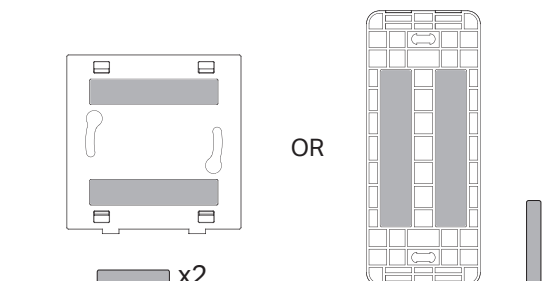

Option 2: Use Screws (Replace Current Wallplate)

- Remove the previous switch's wallplate and remove the back panel of the new switch.

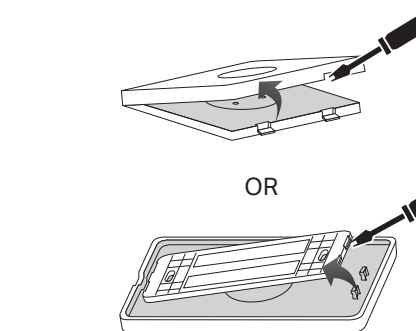

- Secure the back panel with screws and attach the wallplate to the back panel.

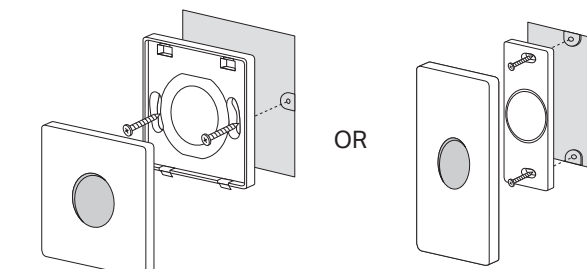

5 Magnetically Attach Button to the Wallplate

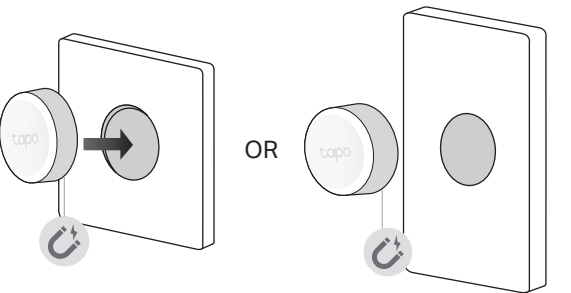

? How to Use Your Button

Tap or rotate to control lights and appliances with custom Smart Actions.

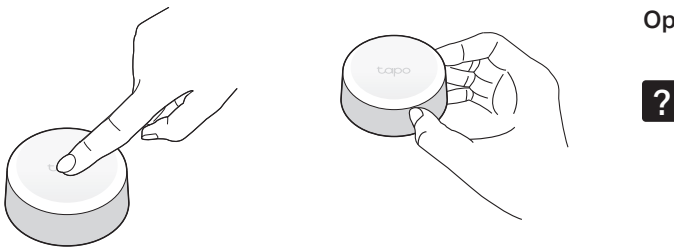

Note: When using the button to control your devices, please ensure that there are no contradictory actions. For example, avoid having "single tap to turn on the light" and "single tap to turn off the light" as conflicting actions.

? How to Work with Alexa

Tapo works with Alexa to control your smart device by voice. You can choose one of the following methods to enjoy it.

Option 1: In the Tapo app, go to **Me > Third-Party Services > Amazon Alexa > Tapo Skill** to set up.

Option 2: In the Amazon Alexa app, go to **More > Skills & Games** and search for Tapo to enable it.

? How to Replace the Battery

*Battery Type: CR2032 *Battery Life: 1 Year (based on the testing of 30 triggers a day)

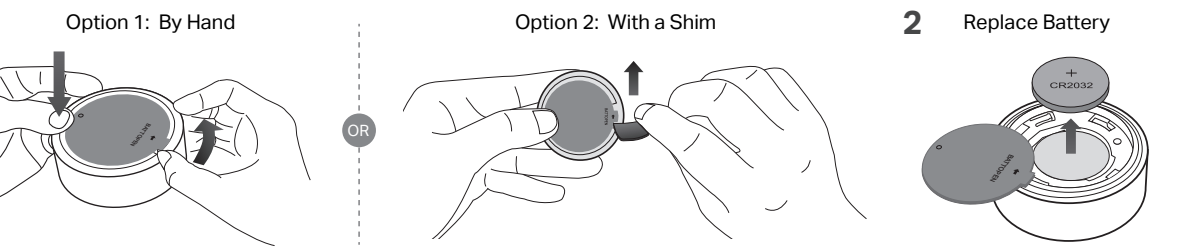

? How to Reset Your Button

- Press and hold the button for 5s. The LED will then turn solid on for 10s.
- Quickly press the button 3 times while the LED is solid on.
- The LED should start to blink.

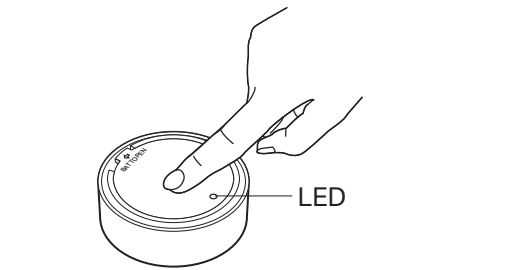

! WARNING

- INGESTION HAZARD:** This product contains a button cell or coin battery.
- DEATH** or serious injury can occur if ingested.
- A swallowed button cell or coin battery can cause **Internal Chemical Burns** in as little as 2 hours.
- KEEP** new and used batteries **OUT OF REACH** of CHILDREN
- Seek immediate medical attention** if a battery is suspected to be swallowed or inserted inside any part of the body.

Warning! This product contains a button cell or coin battery. Avoid ingestion hazard. Death or serious injury can occur if ingested.

CAUTION!
Risk of explosion if the battery is replaced by an incorrect type.

CAUTION!
Avoid replacement of a battery with an incorrect type that can defeat a safeguard. Avoid disposal of a battery into fire or a hot oven, or mechanically crushing or cutting of a battery, that can result in an explosion. Do not leave a battery in an extremely high temperature surrounding environment that can result in an explosion or the leakage of flammable liquid or gas; Do not leave a battery subjected to extremely low air pressure that may result in an explosion or the leakage of flammable liquid or gas.

CAUTION: Do not ingest battery, Chemical Burn Hazard
This product contains a coin / button cell battery. If the coin / button cell battery is swallowed, it can cause severe internal burns in just 2 hours and can lead to death. Keep new and used batteries away from children. If the battery compartment does not close securely, stop using the product and keep it away from children. If you think batteries might have been swallowed or placed inside any part of the body, seek immediate medical attention.

- Remove and immediately recycle or dispose of used batteries according to local regulations and keep away from children. Do NOT dispose of batteries in household trash or incinerate.
- Even used batteries may cause severe injury or death.
- Call a local poison control center for treatment information.
- This product includes button/coin cell batteries of type CR2032.
- The nominal voltage of the button/coin cell batteries is +3V.
- Non-rechargeable batteries are not to be recharged.
- Do not force discharge, recharge, disassemble, heat above 60°C/140°F or incinerate. Doing so may result in injury due to venting, leakage or explosion resulting in chemical burns. Ensure the batteries are installed correctly according to polarity (+ and -).

Do not mix old and new batteries, different brands or types of batteries, such as alkaline, carbon-zinc, or rechargeable batteries. Remove and immediately recycle or dispose of batteries from equipment not used for an extended period of time according to local regulations. Always completely secure the battery compartment. If the battery compartment does not close securely, stop using the product, remove the batteries, and keep them away from children. Safety Information Keep the device away from water, fire, humidity or hot environments. Do not attempt to disassemble, repair, or modify the device. If you need service, please contact us. Do not use the device where wireless devices are not allowed. Please read and follow the above safety information when operating the device. We cannot guarantee that no accidents or damage will occur due to improper use of the device. Please use this product with care and operate at your own risk.

TP-Link hereby declares that the device is in compliance with the essential requirements and other relevant provisions of directives 2014/53/EU, 2011/65/EU and (EU) 2015/863. The original EU declaration of conformity may be found at <https://www.tapo.com/en/support/ce/> TP-Link hereby declares that the device is in compliance with the essential requirements and other relevant provisions of the Radio Equipment Regulations 2017. The original UK declaration of conformity may be found at <https://www.tapo.com/support/ukca/> For EU/UK Region: Operating Frequency / Nominal Operating Frequency / Max Output Power: 863~865 MHz / 863.35 MHz / 25 mW (e.r.p) 863~865 MHz / 864.35 MHz / 25 mW (e.r.p) 868~868.6 MHz / 868.35 MHz / 25 mW (e.r.p) For US: Nominal Operating Frequency 920.9 MHz/921.7MHz/922.3 MHz

Support
For technical support, user guides, warranty and more, please visit <https://www.tapo.com/support/>

