

# Quick Start Guide

## Smart Video Doorbell Wired

\*Images may differ from your actual product.  
©2024 TP-Link 7106510691 REV1.1.0

### Before You Start

WARNING: Risk of Electric Shocks

- Your existing doorbell must be wired (not battery powered) and supplied by an 8-24V AC, 10VA Minimum transformer.
- Ensure that your existing doorbell works by ringing the doorbell.
- Locate your existing doorbell chime.
- Make sure the doorbell is in an area with a good Wi-Fi signal (at least two or three bars).
- Disconnect power at the fuse or circuit breaker before installing.
- You can always find detailed wiring and installation instructions in the Tapo app.



OR



### Package Contents

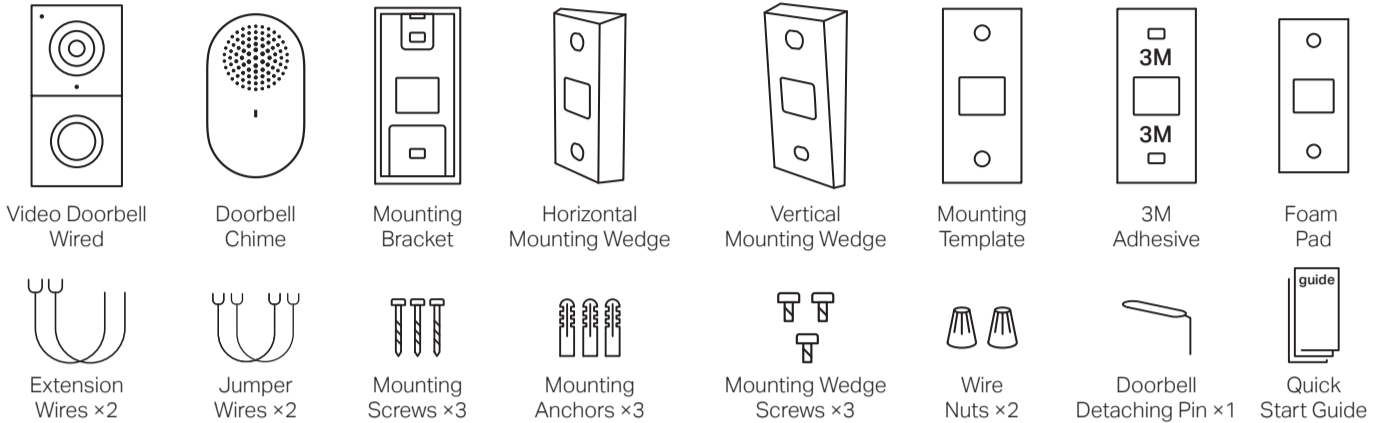

## 01 / Install Jumper Wire for Your Existing Chime

⚠ Take care to avoid electric shocks.

**Note:** Install the jumper wire to bypass the existing chime on the circuit, so that the Tapo doorbell can get sufficient power to operate stably.

**Requires:**

- Jumper Wire x1 (Another one is optional)

- Turn off the circuit breaker. Make sure the power is off by ringing your doorbell a few times.



- Remove the chime cover and take a photo of the wiring in case you want to reconnect it.

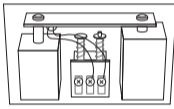

- Slightly loosen the screws for the **Front** and **Trans** of your **front** doorbell or the **Rear** and **Trans** of your **rear** doorbell, then insert the jumper wire.

**Note:** If your doorbell chime has different markings, refer to instructions in the Tapo app or consult a licensed electrician.

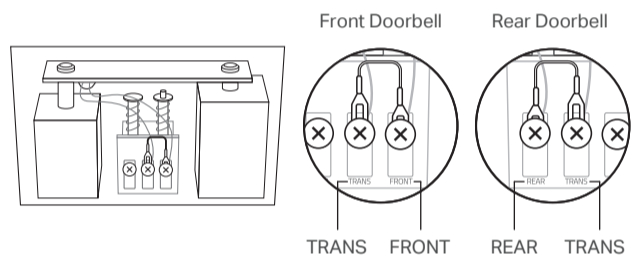

- Tighten the screws and replace the chime cover.

## 02 / Preparations for Installing Your Doorbell

- Remove your existing doorbell on the door. Disconnect the wires.

⚠ Take care to avoid electric shocks.

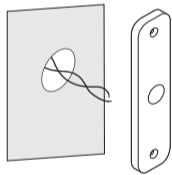

- (Optional) Select the mounting wedge to adjust the viewing angle of the doorbell.

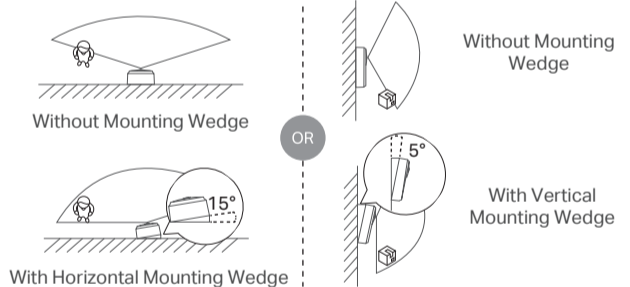

## 03 / Install Your Doorbell

⚠ Take care to avoid electric shocks.

\*Recommended Installation Height: 1.2 m (4 ft) above the ground

### Option 1. Stick to a clean wall

- Attach the included adhesive to the back of the bracket or the wedge you have selected. If you use the wedge, affix the bracket and the wedge with screws.

**Note:** The adhesive is for one-time use. Avoid re-using the adhesive to ensure its adhesion.

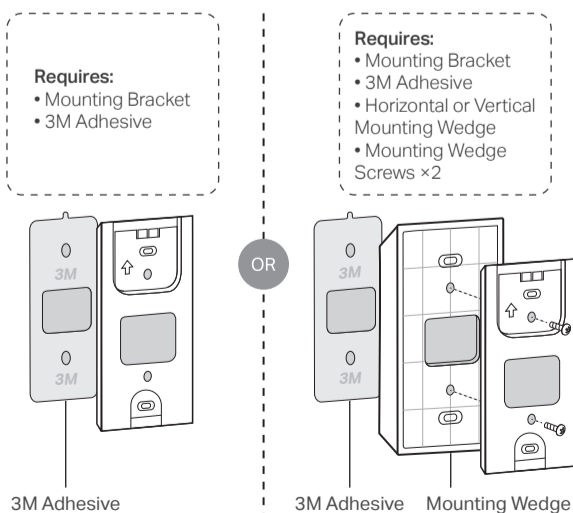

- Route the wires through the bracket. Wipe off the dust from the surface, stick the bracket with adhesive to the clean wall, and press it down for 15 seconds to ensure the bracket is firmly attached.

**Note:** This is applicable with tile, glass, marble, metal, stainless steel, and hard wall surfaces.

- Connect the wires to the two terminals at the back of the doorbell, and tighten the terminal screws.

**Note:** If the wires are too short, use the included extension wires and wire nuts to make them longer.

**Requires:**

- Video Doorbell Wired
- (Optional) Extension Wires x2
- (Optional) Wire Nuts x2

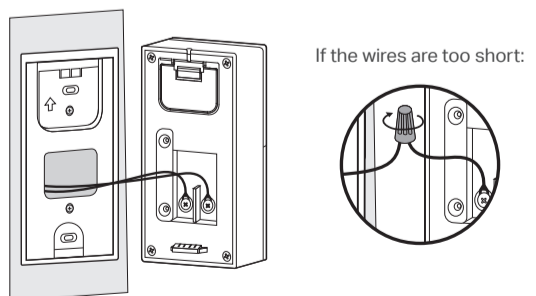

- Mount the doorbell to the bracket and turn on the circuit breaker.

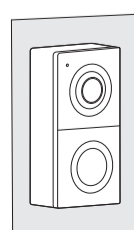

🔗 Flip the page over for Option 2, and more.

## Option 2. Mount to the wall

1. Route the wires through the mounting template and stick the template. Drill two holes where indicated.

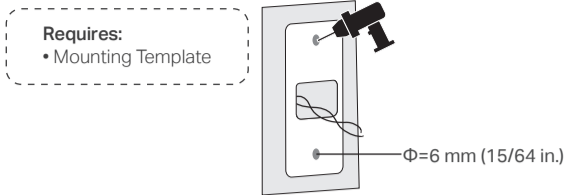

2. Route the wires through the bracket. Insert two anchors into the holes and use the screws to affix the bracket over the anchors.

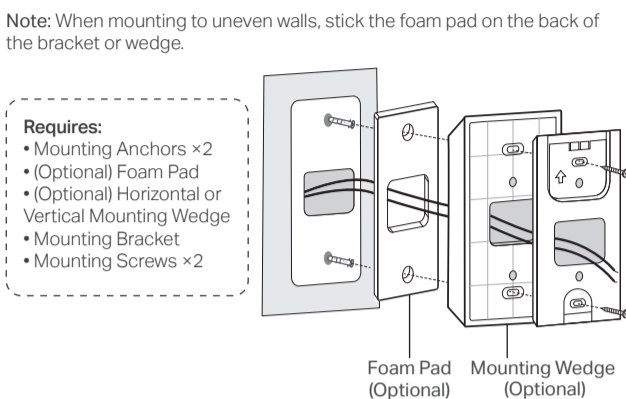

3. Connect the wires to the two terminals at the back of the doorbell, then tighten the terminal screws.

**Note:** If the wires are too short, use the included extension wires and wire nuts to make them longer.

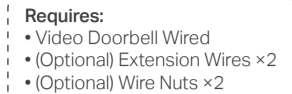

If the wires are too short:

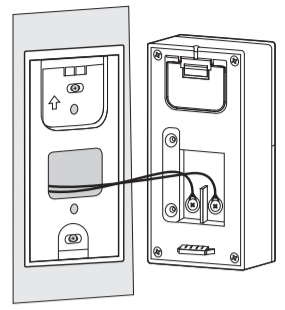
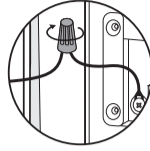

4. Mount the doorbell to the bracket and turn on the circuit breaker.

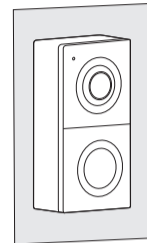

## 04 / Set Up Your Doorbell and Chime

1. Download the Tapo app from the App Store or Google Play. Open the app and log in with your TP-Link ID. If you don't have an account, create one first.



2. Tap the ⊕ button in the app and select your model. Follow the instructions in the Tapo app to set up your doorbell. Then plug in your chime and pair with the doorbell.

**Note:** If you didn't pair during the doorbell setup, please refer to <https://www.tp-link.com/support/faq/3818/> for detailed instructions.

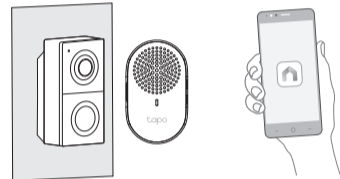

### Doorbell Appearance

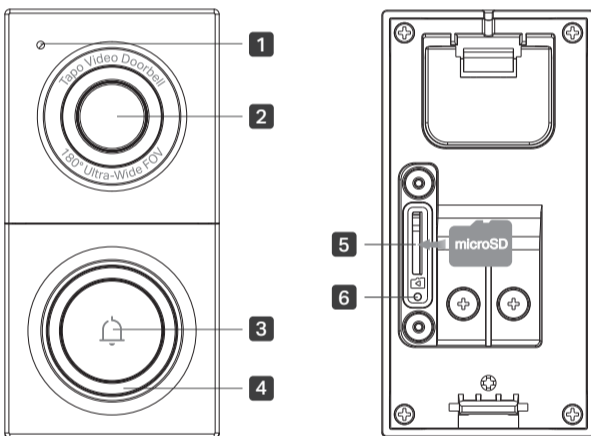

- 1 Microphone**
- 2 Lens**
- 3 Ring Button**
- 4 LED**
- 5 microSD Card Slot**  
Loosen the screws and insert a microSD card. Initialize it on the Tapo app for local recording.  
\*microSD card not included
- 6 Reset Button**  
• Use a pin to press and hold for 5s: Reset Wi-Fi settings  
• Use a pin to press and hold for 10s: Reset to factory settings

### Chime Appearance

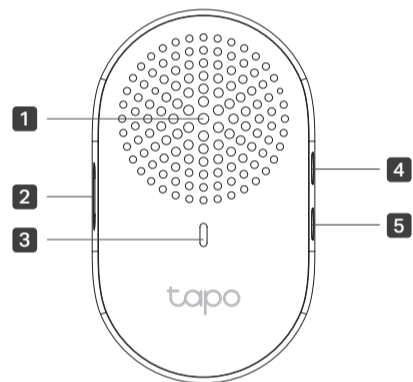

- 1 Speaker**
- 2 Reset Button**  
• Use a pin to press and hold for 5s: Reset Wi-Fi settings  
• Use a pin to press and hold for 10s: Reset to factory settings
- 3 LED**
- 4 Volume Button**  
Press to adjust the volume of the ring.
- 5 Music Button**  
Press to cycle through different ringtones.

### Doorbell LED Indication

Solid red	Starting up
Blinking red and green	Ready for setup
Blinking red slowly	Connecting to Wi-Fi
Solid amber	Connected to Wi-Fi
Solid white	Connected to the cloud
Blinking green quickly	Doorbell updating
Blinking red quickly	Doorbell resetting

### Chime LED Indication

Solid red	Starting up
Blinking red and green	Ready for setup
Blinking red slowly	Connecting to Wi-Fi
Solid amber	Connected to Wi-Fi
Solid green	Connected to the cloud
Blinking green quickly	Chime updating
Blinking red quickly	Chime resetting

### How to Detach Doorbell

Use the doorbell detaching pin provided if you wish to detach the doorbell from the mounting bracket.

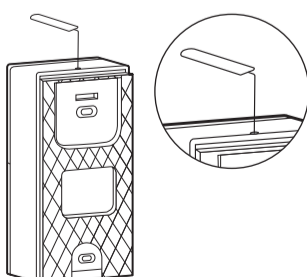

- Never touch the product with wet hands.
- Do not disassemble, repair or modify the product.
- Do not use the device where wireless devices are not allowed.
- Do not use the product if the casing has been broken. Danger of electric shock.
- Keep the device away from fire or hot environments. DO NOT immerse in water or any other liquid.
- Do not place near automatically controlled devices such as fire alarms. Radio waves emitted from this product may cause such devices to malfunction resulting in an accident.
- Observe restrictions on using wireless products in fuel depots, chemical plants or when blasting operations are in progress.
- Do not use liquid to clean the product. Only use a dry cloth.
- Never put metal objects inside the product. If a metal object enters the product turn off the circuit breaker and contact an authorised electrician.
- This product is not intended to be used when providing medical care. Consult the manufacturer of any personal medical devices, such as pacemakers or hearing aids to determine if they are adequately shielded from external RF (radio frequency) energy.
- Do not use this product in health care facilities. Hospitals or health care facilities may be using equipment that could be sensitive to external RF energy.
- Do not use this product near water for example near a bath tub, wash bowl, kitchen sink or laundry tub, in a wet basement or near a swimming pool.
- The product should be kept free from excessive smoke, dust or high temperature and vibration.
- This product should not be exposed to direct sunlight
- Do not place heavy objects on top of the product.
- This product may interfere with other electronic products such as TV, radios, personal computers, phones or other wireless devices.
- This equipment can be powered only by equipment that complies with Power Source Class 2 (PS2) or Limited Power Source(LPS) defined in the standard of IEC 62368-1.
- This equipment shall be installed at a height of fewer than 2 meters when sticking to a clean wall.
- Doorbell Operating Temperature: -20 °C ~ 45 °C (-4 °F ~ 113 °F)
- Chime Operating Temperature: 0 °C ~ 40 °C (32 °F ~ 104 °F)
- Please read and follow the above safety information when operating the device. We cannot guarantee that no accidents or damage will occur due to improper use of the device. Please use this product with care and operate at your own risk.
- TP-Link hereby declares that the device is in compliance with the essential requirements and other relevant provisions of directives 2014/53/EU, 2009/125/EC, 2011/65/EU and (EU)2015/863.
- The original EU declaration of conformity may be found at <https://www.tapo.com/support/ce/>
- TP-Link hereby declares that the device is in compliance with the essential requirements and other relevant provisions of the Radio Equipment Regulations 2017.
- The original UK declaration of conformity may be found at <https://www.tapo.com/support/ukca/>



### Support

For technical support, the user guide, and other information, please visit <https://www.tapo.com/support/>.

