



Special Needs Conference Co-Chairs:
Sara Austin and Grace Kung
Resource Fair Chair: Kristine Chung

Special Needs Committee Members:

Olga Aguilar, Parent
Noël Bahamón, Parent
Chris Borkgren, Teacher, SPUSD
Angelique Burzynski, Teacher, SPUSD
Ellen Daigle, Community Member
Dina Escobar, Parent
Nancy Goldstein, Program Specialist, SPUSD
Timaree Hayes, Teacher, SPUSD
Michelle Kipke, Board Member, SPUSD

Diane Lasell, Parent
Dennis Lefevre, Executive Director, Student Support Services, SPUSD
Qing Liu-Michael, Parent
Terry Muñoz, Parent
Lourdes Nonato, Parent
Geoff Yantz, Superintendent, SPUSD
Candice Yu, Parent
Lindy Yuen, Parent

Thank you to Julie Giulioni and our other sponsors:

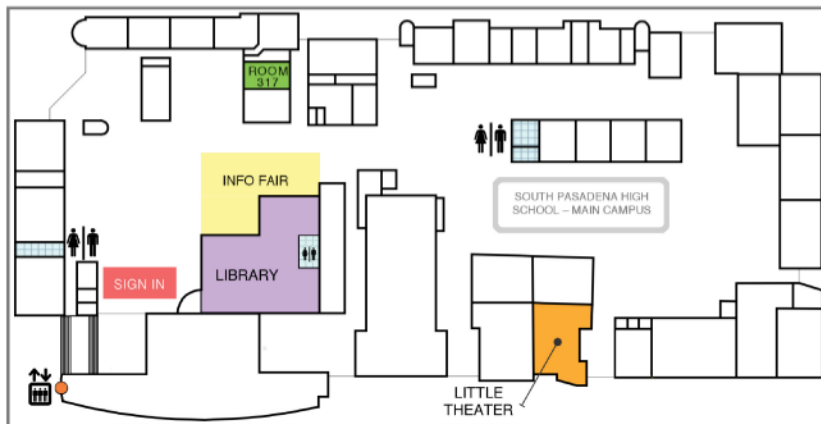

THE SOUTH PASADENA COUNCIL PTA SPECIAL NEEDS COMMITTEE AND THE SOUTH PASADENA UNIFIED SCHOOL DISTRICT

5TH SPECIAL NEEDS CONFERENCE

SATURDAY
MARCH 3, 2018
8:30 AM - 12:30 PM

Learn how to:

- find, fund, & coordinate services*
- deal with challenging behavior*
- explore pathways after high school
- teach and practice social communication
- understand and manage attention issues

*these two panels will be offered with Mandarin/ Spanish simultaneous interpretation



SOUTH PASADENA HIGH SCHOOL
SOUTH PASADENA, CA 91030

Please let us know what you think:
sara.austin, sara.k.austin@gmail.com or
grace.kung, gracealexkung@yahoo.com

We will be posting conference presentations, handouts and videos on our website:
www.spp4snc.com

FREE ADMISSION - ALL ARE WELCOME

CONFERENCE SCHEDULE AND PRESENTATIONS

8:30 - 9	REGISTRATION/COFFEE/RESOURCE FAIR		
9 - 10:30	LITTLE THEATER	LIBRARY	ROOM 317
	<p style="text-align: center;">Putting the Puzzle Together: Find, Fund, and Coordinate Services* <i>Felipe Hernandez, Chief of Consumer Services, Eastern Los Angeles Regional Center (ELARC); Cara Lucier, Esq., Law Offices of Cara Lucier; Bryce Miler, Contracts Director, Center for Autism and Related Disorders (CARD); Jacqueline Williams, Assistant Superintendent, West San Gabriel Valley SELPA</i></p> <p>It can be challenging to figure out what services are available for students with special needs, who provides them, and who funds them. Join our panel of experts to learn how the districts of our Special Education Local Plan Area can help, what the Regional Center offers, how to get insurance to pay for other needed services, how In-Home Supportive Services works—and how to get them all to fit together.</p>	<p style="text-align: center;">Attention Please! Assessing, Understanding, and Managing Attention Issues <i>Dr. Kenneth L. Herman, PhD, Herman & Associates</i></p> <p>Many students with special needs struggle with attention, whether or not they have been diagnosed with an attention disorder. Come learn about current approaches to attention issues from psychologist Dr. Kenneth L. Herman, who will explore evaluation and treatments for attention issues and how attentional problems develop across the lifespan.</p>	<p style="text-align: center;">The Three Ws of Pragmatics: What, Where, and When <i>Bozena Barton, MA, CCC-SLP (SPUSD); Angelique Burzynski, MA, Special Education (SPUSD)</i></p> <p>Worried parents have many questions when they first hear that strange word pragmatics. What is pragmatics? Can pragmatics be taught—and if so, where, when, and how? What happens if pragmatics are not learned? Discover the answers to these and many other questions about social language. Learn about the new focus on bringing social language learning into the natural world of our students—the classroom.</p>
10:30 - 11	BREAK - PLEASE VISIT OUR RESOURCE FAIR		
11 - 12:30	LITTLE THEATER	LIBRARY	ROOM 317
	<p style="text-align: center;">Preventing and Addressing Challenging Behavior* <i>Dr. Diane Cullinane, MD, Developmental Pediatrician and Executive Director, PCDA; Nancy Goldstein, MS, EdPsy, LEP, Program Specialist, Student Support Services (SPUSD); Ellie Morrissey, MS, LEP, BCBA, private practice and SPUSD</i></p> <p>How can you respond effectively when students with special needs behave in disruptive, destructive, or injurious ways, in the classroom or at home? What do we know about the root causes of behavior in its context, and how can we use that information to make problem behavior less likely? Join a panel of experts who will explore a range of approaches to behavioral issues.</p>	<p style="text-align: center;">Putting the Puzzle Together: Find, Fund, and Coordinate Services <i>Felipe Hernandez, Chief of Consumer Services, Eastern Los Angeles Regional Center (ELARC); Cara Lucier, Esq., Law Offices of Cara Lucier; Bryce Miler, Contracts Director, Center for Autism and Related Disorders (CARD); Jacqueline Williams, Assistant Superintendent, West San Gabriel Valley SELPA</i></p> <p>It can be challenging to figure out what services are available for students with special needs, who provides them, and who funds them. Join our panel of experts to learn how the districts of our Special Education Local Plan Area can help, what the Regional Center offers, how to get insurance to pay for other needed services, how In-Home Supportive Services works—and how to get them all to fit together.</p>	<p style="text-align: center;">What's Next? Pathways after High School <i>Kelly Privitt, Senior Director of Quality and Data Management, AbilityFirst; Olivia Raynor, PhD., Director, Tarjan Center at UCLA; Rosemary Scott, MA-CCC, SLP, Teacher Specialist, Disabled Students Programs and Services, Pasadena Community College</i></p> <p>What are the possibilities for students with special needs beyond high school? And what kind of support is available to help them find success? Join a panel of experts who will explore pathways to college, employment, community involvement, and independent living.</p>

*These two panels will be offered with Mandarin/Spanish simultaneous translation.