

**ROAV**

**ROAV**

**Owner's Manual**

**DASHCAM S1**

Model: R2122  
51005001103 V01



## Table of Content

<b>Safety Instructions</b>	<b>01</b>
<b>At a Glance</b>	<b>02</b>
<b>Inserting Memory Card</b>	<b>03</b>
<b>Installing Your DashCam</b>	<b>04</b>
<b>Connecting to Power</b>	<b>06</b>
<b>Downloading Roav App</b>	<b>07</b>
<b>Using Your DashCam</b>	<b>08</b>
<b>System Setup</b>	<b>10</b>
<b>Specifications</b>	<b>12</b>
<b>FAQ</b>	<b>13</b>
<b>Notice</b>	<b>14</b>

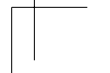
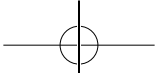
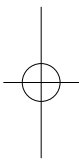
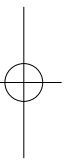

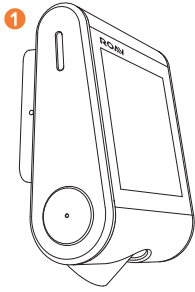

DashCam

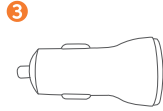

Car charger



Manual



Mount



microSD card

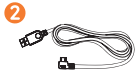

Charging cable



Crowbar

## Safety Instructions

Please read and understand all instructions before using this product. If damage is caused by failure to follow the instructions, the warranty does not apply.

- Keep these instructions.
- Do not drop, puncture or disassemble this product.
- This product shall not be exposed to dripping or splashing.
- Avoid long exposure to direct sunlight, which may cause damage.
- Exposing this product to open flames may cause explosion.
- Use original accessories only.
- Do not install this product where it will block the driver's view of the road or the deployment of the airbag.
- Keep your attention on the road. Do not operate the controls of this product while driving.
- Ensure the camera lens is kept clean and there is nothing blocking the lens.
- Setup time and date accurately before using this product.
- Do not use the charger if the cord is damaged or broken.
- Remove this product from your vehicle when not in use for a long period.
- Keep out of reach of children.
- Use clean, soft cloth to clean. Do not use any corrosive cleaner/oil to clean.
- The Company is NOT responsible for the loss of any data/content during operation.

## At a Glance

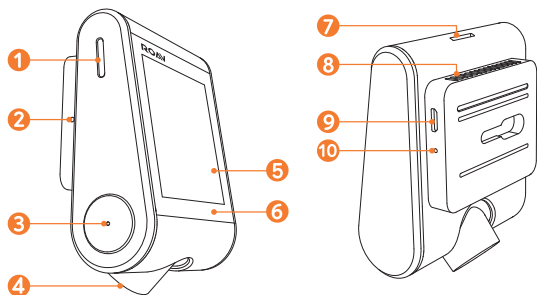

- 1 Speaker
- 2 Microphone
- 3 Power button with LED indicator
  - Red: recording in progress
  - Green: no recording status
- 4 Camera lens
- 5 LCD screen
- 6 Touch buttons
- 7 Memory card slot
- 8 Air vent
- 9 Micro USB charging port
- 10 Reset slot

## Inserting Memory Card



Do not remove or insert microSD / TF card when this product is powered on, which may damage the card.

A Class 10, 32GB micro SD / TF card is required as lower-class cards may damage the product. A 64GB or 128GB card should be formatted in DashCam before using. Regularly formatting the card is recommended.

Card Capacity	32 GB	64 GB	128 GB
1080P 30FPS	320 min	640 min	1280 min
720P 60FPS	360 min	720 min	1440 min
720P 30FPS	480 min	960 min	1920 min



- 1 Insert a microSD / TF card with the gold contacts facing the screen side of the DashCam. Push the card until it clicks into place.
- 2 To remove the card, gently push its top edge inward until it clicks, and then pull it out of the slot.

## Installing Your DashCam



- Never install this product while driving.
- Install this product near the rear-view mirror to obtain the best open-field view. Do not install in a location that will obstruct your required driving view.
- Make sure that the lens is within the wiping range of the windscreen wiper to ensure a clear view even when it rains.
- Do not touch the lens with your fingers. Finger grease may be left on the lens and will result in unclear videos.
- The mount is adhesive and may be destroyed if it is removed from the windshield.

- 1 Attach the DashCam onto the mount.

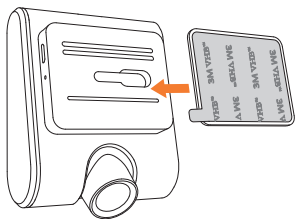

- 2 Select a location (**A** or **B**) on the windshield behind the rear-view mirror, clean with clear water and make it fully dry.
- 3 Remove 3M adhesive sticker and firmly affix the mount onto the windshield.
- 4 Use the crowbar to press and hide the charging cable into the seams and weatherstrips around the edge of the dashboard.
- 5 Adjust the lens viewing angle to ensure that it is aligned with the road ahead.

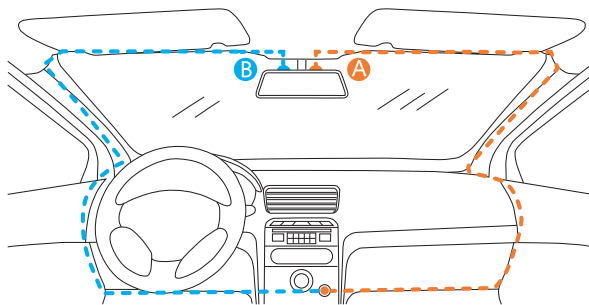

## Connecting to Power

- 1 Connect the car charger and DashCam by using the charging cable.
- 2 Plug the other end of the car charger to your vehicle's cigarette lighter socket.

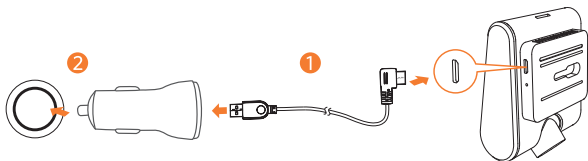

- 3 Once the car engine is started, DashCam will automatically power on and start recording. Once the car engine is shut down, DashCam automatically saves the recording and turns off.

## Downloading Roav App

Search "Roav" in App Store or Google Play to Download.



### Connect DashCam with Smartphone

When successfully connected with your smartphone via built-in Wi-Fi, you can save and playback the driving recording videos on your smartphone. You can also change settings of the DashCam via Roav app.



When successfully connected, DashCam stops recording.



- 1 Tap **OK**, select "**WIFI**" > "**On**" to enable WiFi on DashCam.
- 2 Enable WiFi on your smartphone, find "Roav DashCam S1" on the list and connect it, enter password (initial password: goroavcam) if required.
- 3 Follow the instructions on your smartphone to complete the connection.

## Using Your DashCam



As a driver, you have full responsibility to drive safely and adhere to all applicable traffic regulations.

### Record Videos

- 1 When connected to a car charger, DashCam automatically starts recording,  is displayed and red dot flashes on the screen, the current recording duration is displayed, and the current date and time is displayed.
- 2 To enable / disable the audio recording, tap .

### Protect the Current Recording

By default, DashCam uses a sensor to automatically detect accidental collisions and protect the video file with duration of 30 seconds, and  is displayed. This indicates that those recordings have been locked and will not be overwritten by new video clips.

To protect the current recording manually, tap .











The locked video clips will be saved in "RO" folder under root directory of the memory card.

## Playback Videos



The DashCam stops recording while viewing videos or settings.

- 1 Tap  to view all saved videos.
- 2 Select a video to playback.

Touch Button	Virtual Button	Function
OK		Play / Pause
		Delete Current / Delete All
		Lock Current / Unlock Current
		Back to previous menu

## System Setup

To adjust DashCam's settings, tap **OK**.

Menu Options	Description	Available Options
<b>Resolution</b>	Set a desired video resolution.	720P 30FPS / 720P 60FPS / 1080P 30FPS
<b>Loop Recording</b>	Set the duration of each recording video clip.	1 Minute / 3 Minutes / 5 Minutes / 10 Minutes
<b>Sensitivity</b>	Sensitivity for gravity helps to detect vibration and shock while driving and makes DashCam to respond appropriately.	Low / Medium / High / Off
<b>Parking Monitor</b>	Enable to keep DashCam in standby mode. Motion will be detected for 15 times and DashCam starts recording a 30 second video each time.	Low / Medium / High / Off
<b>WIFI</b>	Connect with smartphone	On / Off
<b>Date</b>	Set date and time	Tap  /  to adjust the value, tap <b>OK</b> to next option, tap  to save
<b>Language</b>	Set on-screen display menu language.	English / Deutsch / 日本語 / 简体中文 / 繁体中文 / Español / Italiano / Français

<b>GPS</b>	Enable / disable GPS positioning module to record the complete driving path.	On / Off
<b>LCD Auto Off</b>	Turn off the screen backlight after a period of inactivity.	30 Seconds / 60 Seconds / Off
<b>Machine Sound</b>	Mute or unmute.	On / Off
<b>Default</b>	Reset all options to the default settings.	Cancel / OK
<b>Format</b>	Format the memory card and all the data will be deleted.	Cancel / OK
<b>Water Mark</b>	Display / hide the date and time on the recordings.	On / Off
<b>Frequency</b>	Match the video frequency of DashCam with the electrical frequency of your location.	50 Hz (EU / China) / 60 Hz (US)
<b>About</b>	Check the current version number.	

Touch Button	Virtual Button	Function
		Click repeatedly to select a setting Click to confirm a selection
		Toggle the next setting
		Toggle the previous setting
		Back to recording mode



## Specifications

☰ Specifications are subject to change without notice.

Screen: 2.4" LCD color TFT (320 x 240)

Camera lens: wide-angle lens 145°

Power input: 5V  1A

Max video resolution: 1080P 30FPS

Video clip format: .MP4

Wi-Fi: 2.4GHz Band

Battery capacity: 240 mAh

Operating temperature range: -10°C to 65°C / 14°F to 149°F

Operating temperature range: 0°C to 65°C / 32°F to 149°F  
(Parking Monitor)

Weight: Approx. 119 g / 4.2 oz

Size: 86\*66\*36 mm / 3.4\*2.6\*1.4 in

## FAQ

- 1 Can not record?
  - Check if the memory card is inserted properly and there is enough free capacity.
  - Check the battery level.
- 2 Blurred image?
  - Use a clean, soft lens-cleaning cloth to gently clean the lens.
- 3 Malfunction or crash?
  - Press and hold the Reset slot by using a sharp pin for at least 2 seconds.
- 4 Blank screen?
  - The screen saver is activated. Change settings to "Off" if required.
- 5 Fail to view and playback videos on your smartphone?
  - Check on your smartphone if Wi-Fi is successfully connected to the DashCam.
- 6 How to enable parking monitor?
  - Tap **OK**, select "**Parking Monitor**" > "**On**".
- 7 Worry about the memory card is full?
  - Continuous loop recording allows to overwrite the old unlocked files.
- 8 Will my data be used when my smartphone is connected with DashCam?
  - No. Data will be used only if you share the saved videos via social apps.

## Notice

### FCC Statement

This device complies with Part 15 of the FCC Rules. Operation is subject to the following two conditions: (1) This device may not cause harmful interference, and (2) This device must accept any interference received, including interference that may cause undesired operation.

**Warning:** Changes or modifications not expressly approved by the party responsible for compliance could void the user's authority to operate the equipment.

**Note:** This equipment has been tested and found to comply with the limits for a Class B digital device, pursuant to Part 15 of the FCC Rules. These limits are designed to provide reasonable protection against harmful interference in a residential installation.

This equipment generates, uses and can radiate radio frequency energy and, if not installed and used in accordance with the instructions, may cause harmful interference to radio communications. However, there is no guarantee that interference will not occur in a particular installation. If this equipment does cause harmful interference to radio or television reception, which can be determined by turning the equipment off and on, the user is encouraged to try to correct the interference by one or more of the following measures: (1) Reorient or relocate the receiving antenna. (2) Increase the separation between the equipment and receiver. (3) Connect the equipment into an outlet on a circuit different from that to which the receiver is connected. (4) Consult

the dealer or an experienced radio / TV technician for help.

This device complies with Industry Canada licence-exempt RSS standard(s).

Operation is subject to the following two conditions:

- (1) this device may not cause interference, and
- (2) this device must accept any interference, including interference that may cause undesired operation of the device."

Le présent appareil est conforme aux CNR d'Industrie Canada applicables aux appareils radio exempts de licence. L'exploitation est autorisée aux deux conditions suivantes:

- (1) l'appareil ne doit pas produire de brouillage, et
- (2) l'utilisateur de l'appareil doit accepter tout brouillage radioélectrique subi, même si le brouillage est susceptible d'en compromettre le fonctionnement."



12-month limited warranty



Lifetime technical support



[support@goroav.com](mailto:support@goroav.com)



Live Chat on Roav app and website  
(US) Mon-Fri 9:00-17:00(PT)



+1 (800) 988 7973 (US) Mon-Fri 9:00 - 17:00 (PT)  
+44 (0) 1604 936200 (UK) Mon-Fri 6:00 - 11:00 (GMT)  
+49 (0) 69 9579 7960 (DE) Mon-Fri 6:00 - 11:00



[@GoRoav](#)



[@GoRoav](#)

