

Shelter Pavilion, Scenic State Park, Minnesota

In this example Minnesota justifies her advantage of superior native timber resources by the fine character of the log construction. We are almost blinded to the lesser merit of the chimney masonry, which, for all its sturdy proportions, favors the "peanut brittle" technique. No one region seems to have been blest beyond its fair share of natural resources of the first flight. An imagined ideal park structure might call for a masonry chimney from one of several localities, but it would assuredly specify "logs and log construction by Minnesota."

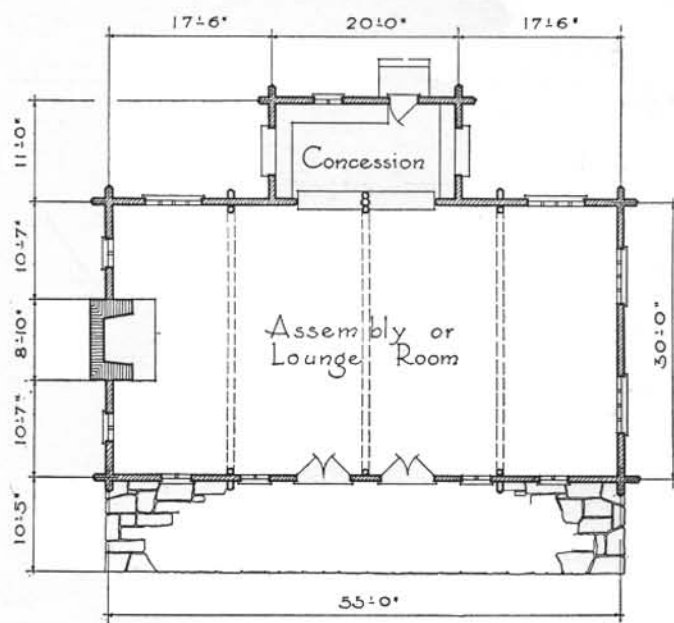

FLOOR-PLAN
Scale $\frac{1}{8} = 1'-0''$