

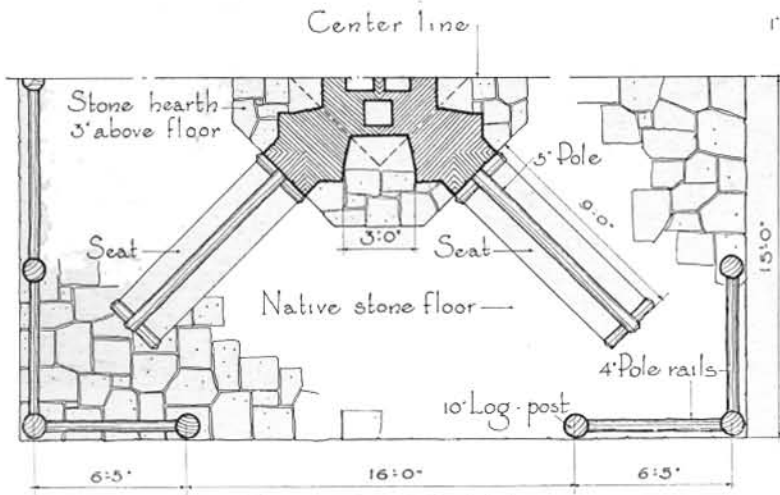

Shelter - Cumberland Falls State Park - Kentucky

A single roof shelters four picnic groups and barricades each against the incursions of the others by means of partition walls that converge on the four-way fireplace. A splendid safeguard against the entire structure being monopolized by one particularly aggressive group.



FLOOR PLAN
One half only

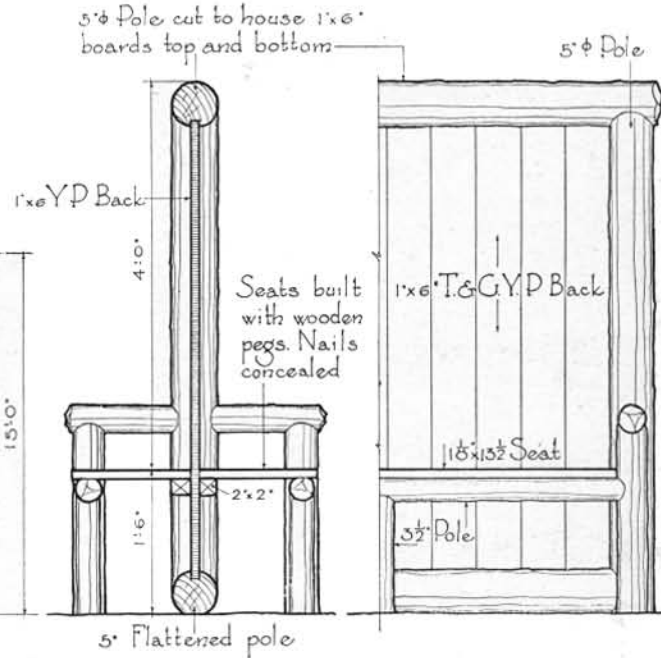

DETAIL OF SEAT
Scale $\frac{1}{2}$ " = 1'-0"

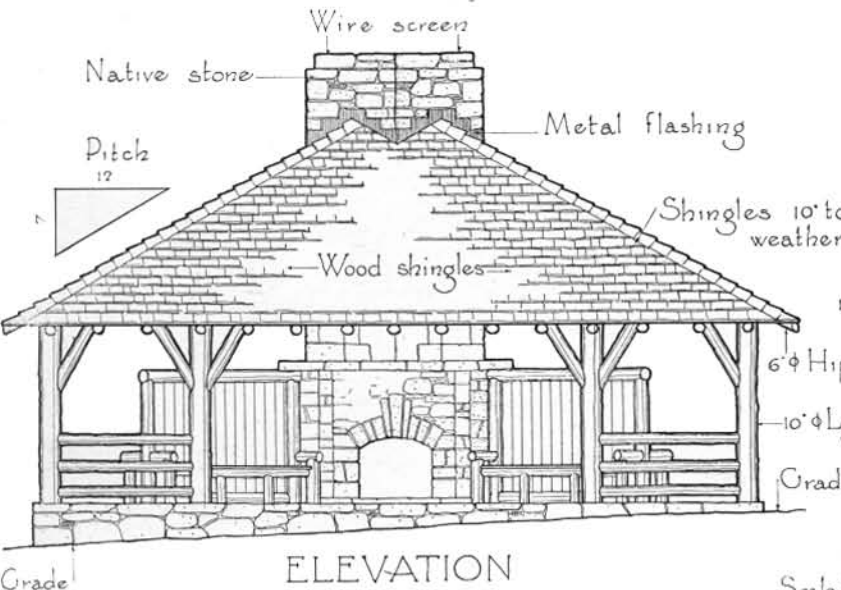

ELEVATION

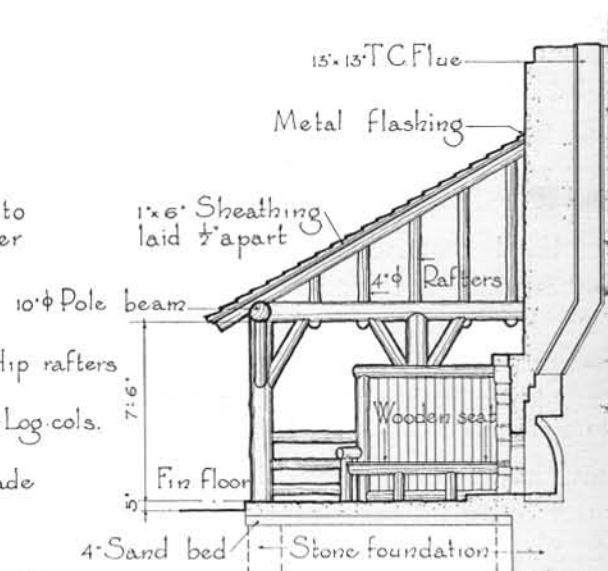

Scale $\frac{1}{8}$ " = 1'-0"

SECTION