

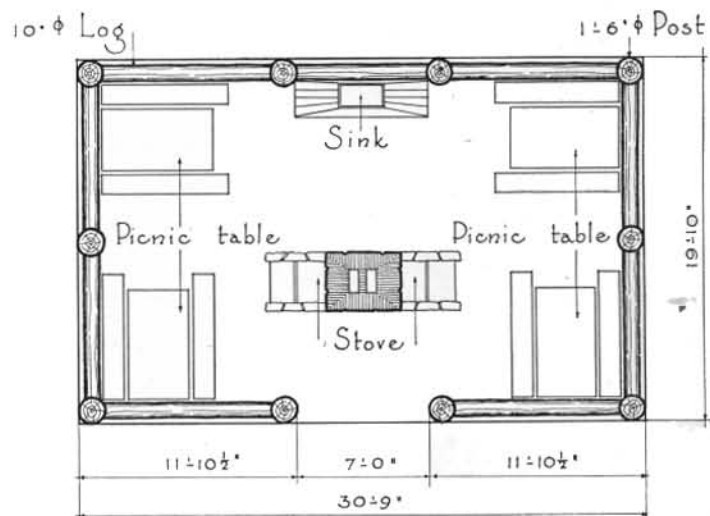

*Community Kitchen, Rainbow Falls State Park,
Washington*

A facility significant of the climate of the Northwest where the mortality rate of picnics in the open relates directly to heavy rainfall. Here are exemplified massiveness of log construction and shakes scaled to the abundance of native cedar, but there is an uncompromising sharpness to the rafter and purlin ends that makes one wish that axe and draw-knife, rather than a saw, had been employed. The facilitating equipment consists of sink, double stove and four table and bench combinations, the latter in an intimate proximity that only a down-pour would render inviting.



FLOOR PLAN
Scale $\frac{3}{32}$ "=1'-0"