

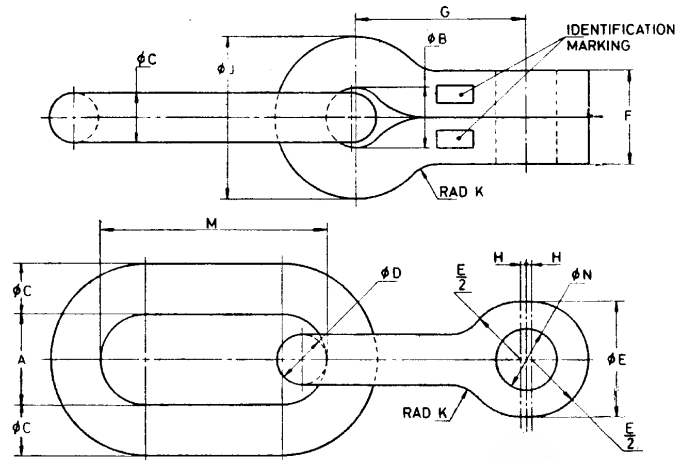

LINK AND CLOSED SHACKLE



The design & specification of the Link and closed Shackles shall confirm to the drawing & specification as per as per DGMS (Tech) Circular No 7 of 1978 and as per IS 12488-1988. The use of Link and closed Shackles will:

- Help to avoid any Ex-Centric Load on the Rope Capple and Zinc Cone Tail Strand.
- Ensure proper fitment of Zinc cone into Basket of Haulage Rope Capple
- Increases the life of Rope Capple and would also reduce any chances of accidents due to slippage/accidental opening of rope.

Diameter of Rope	A	B	C	D	E	F	G	H	J	K	M	N	Working Load kN
16.0	44.5	27.0	22.2	22.2	63.5	46.0	88.9	1.6	71.5	15.9	120.7	31.8	25.0
19.0	50.8	33.3	28.6	28.5	69.9	52.4	95.2	3.2	90.5	19.1	127.0	34.9	36.0
22.0	50.8	36.5	31.8	31.8	79.4	58.7	101.6	3.2	100.0	22.2	133.4	41.3	49.0
25.4	50.8	36.5	31.8	34.9	88.9	63.5	108.0	3.2	100.0	22.2	136.5	44.5	64.0
29.0	57.2	42.9	38.1	38.1	101.6	71.0	127.0	3.2	119.1	25.4	152.4	50.8	80.0

ALL DIMENSIONS IN mm



Micon Engineers

25, NETAJI SUBHAS ROAD, KOLKATA-700001
PHONE : 033-2230-9138/8378 • FAX : 033-22308378

email : miconeng@rediffmail.com