

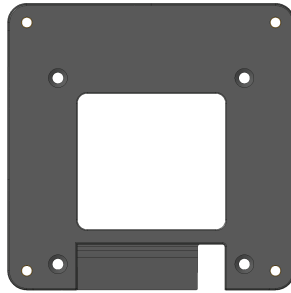

1x  
Adapter

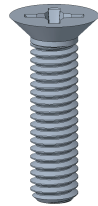

4x  
M4x16 screw



## Quick Installation Guide

# 100mm VESA Adaptor

### Elo Touch Solutions Technical Support

Online self-help: [www.elotouch.com/support](http://www.elotouch.com/support)

Revision A  
P/N E438376

#### North America

800-ELO-TOUCH  
Tel +1 408 597 8000  
Fax +1 408 597 8050  
[EloSales.NA@elotouch.com](mailto:EloSales.NA@elotouch.com)

#### Asia-Pacific

Tel +86 (21) 3329 1385  
Fax +86 (21) 3329 1400  
[EloAsia@elotouch.com](mailto:EloAsia@elotouch.com)

#### Europe

Tel +32 (0)16 70 45 00  
Fax +32 (0)16 70 45 49  
[elosales@elotouch.com](mailto:elosales@elotouch.com)

#### Latin America

Tel +54 11 4785-9129  
[EloSales.LATAM@elotouch.com](mailto:EloSales.LATAM@elotouch.com)

The information in this document is subject to change without notice. Elo Touch Solutions, Inc. and its Affiliates (collectively "Elo") makes no representations or warranties with respect to the contents herein, and specifically disclaims any implied warranties of merchantability or fitness for a particular purpose. Elo reserves the right to revise this publication and to make changes from time to time in the content hereof without obligation of Elo to notify any person of such revisions or changes.

No part of this publication may be reproduced, transmitted, transcribed, stored in a retrieval system, or translated into any language or computer language, in any form or by any means, including, but not limited to, electronic, magnetic, optical, chemical, manual, or otherwise without prior written permission of Elo Touch Solutions, Inc.

Elo and the Elo logo are either trademarks or registered trademarks of Elo Touch Solutions, Inc..



1. Remove VESA spacer from I-series by removing screw.

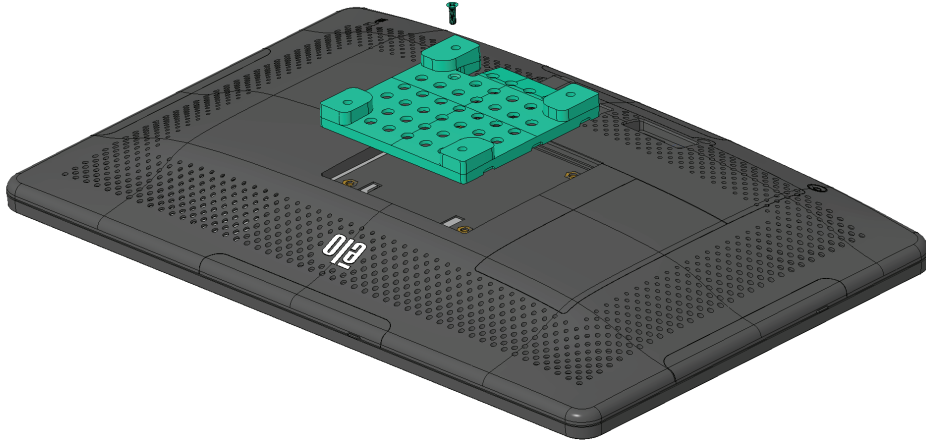

2. Assemble adaptor to I-series using (4) M4 flat head screws (included with kit), in 75mm VESA mounting holes.

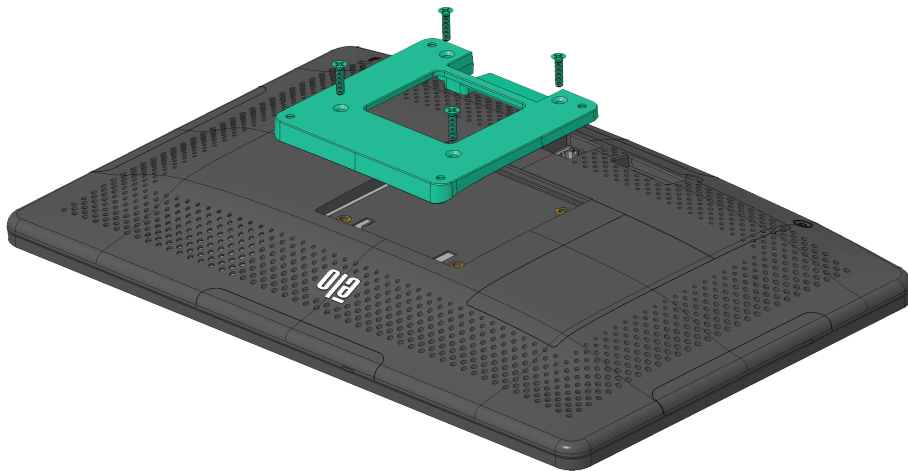

3. Assemble desktop stand to I-series using (4) M4 pan head screws included with stand.

